

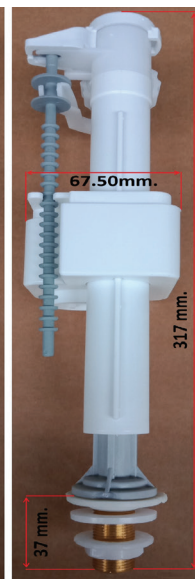

DRAWING

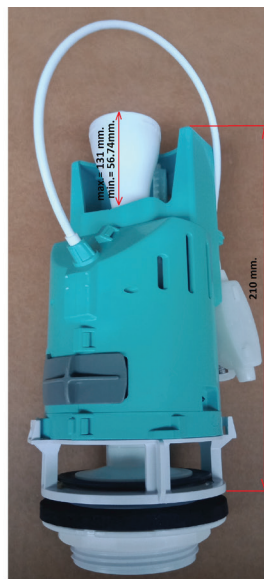

1 - Installation of Button:

- 1 - If the diameter of the cover hole (D) is $> 38\text{mm}$ and $< 45\text{mm}$, do not use ring (b).
- 2 - Place the button on the cover and screw it until it locks.

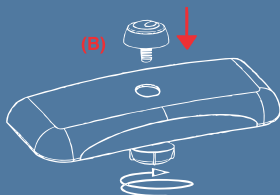

2 - Installation of Discharge Component:

- 1 - Place the discharge component and fix it by tightening the cage nut (E).
- 2 - Move the telescopic pipe up and down to the required height.

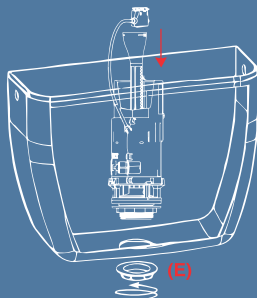

3 - Joining the Closet and Reservoir:

- 1 - Insert the screws under the reservoir. (In accordance with the sample screw set nearby.)
- 2 - Place the closet sealing gasket (G) on the cage nut (F).
- 3 - Place the reservoir on the closet and fix by use of plastic fly nuts.

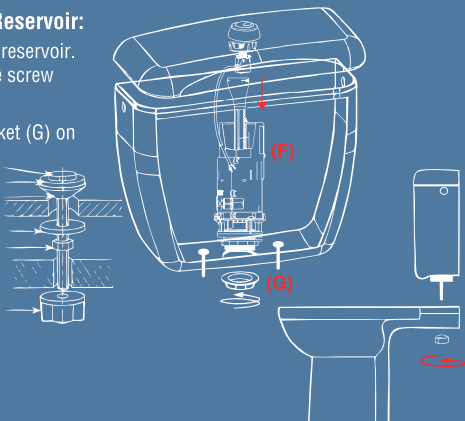

4 - Setting the Water Level:

1 - Connect the floater to the water plumbing and open the valve; for high wash, set the amount of water with the floater.

2 - To set low wash, move the setting latch (I).

3 - Up level of the water height should remain 20 mm under the final position of the telescopic pipe.

NOTE 1 : NOTE 1: When the latch is gradually lowered down to 18, amount of water to be discharged shall increase. In some cases (although rarely), for better cleaning of the closet, it may be required to increase amount of water left in the reservoir after the water is discharged. To this purpose, slide the setting latch (D) leftward.

NOTE 2 : Increasing amount of dead water reduces the amount of water left in the reservoir. If required, set the floater level again to increase top level of water accordingly.

- 1 - Place the floater in a suitable position in the reservoir.
- 2 - Fix the floater by use of a fixing nut.
- 3 - Connect the floater to the plumbing with a connection hose. Connection hose should be certificated.
- 4 - Set the water level.

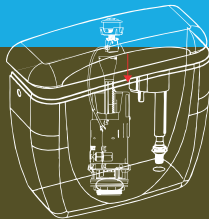
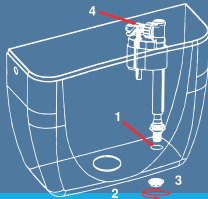
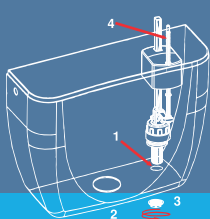
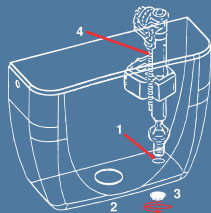
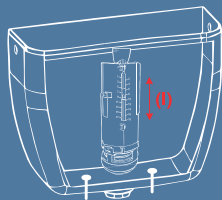

NOTE : After all settings are made, press the latch at the end of the cable when closing the reservoir cover and join the button and cable.