

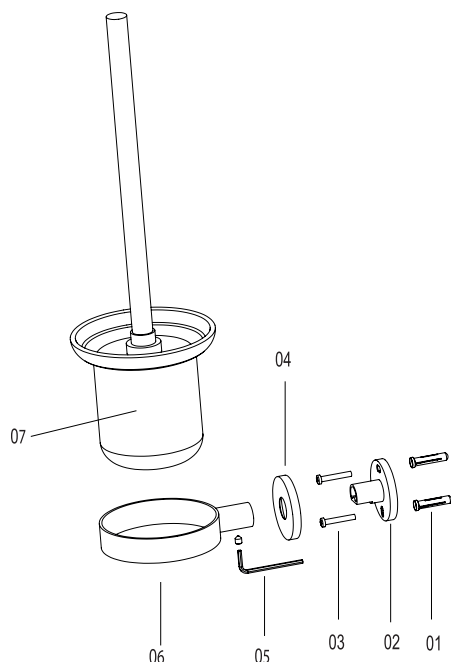

TECHNICAL DRAWING



Assembling parts :
1 x fixing part (02, 04, 05)
2 x fixing part (01, 03)
Mounting instructions

- 1) Remove the mounting bracket from the body by loosening the setscrew.
- 2) Position the assembled unit on the wall where desired.
- 3) Lightly mark the outline of base.
- 4) Center a mounting bracket within base outline.
- 5) Mark the large hole location of mounting bracket.
- 6) Attach mounting bracket to the wall, using the wall anchors provided
- 7) Mount base on the corresponding mounting bracket. Check and make sure that the base set screw hole(s) are facing down. Assemble a set screw to the base. Use the allen wrench included in hardware kit to tighten each set screw and secure the assembly to the mounting bracket(s).