

FREESTANDING BATHTUB

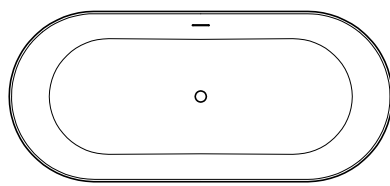

Freestanding

1

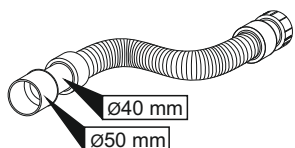

1x

Fig. 1

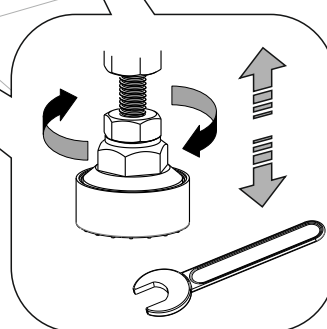
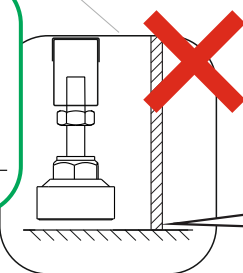
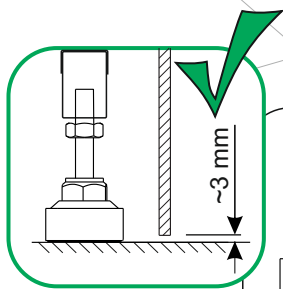
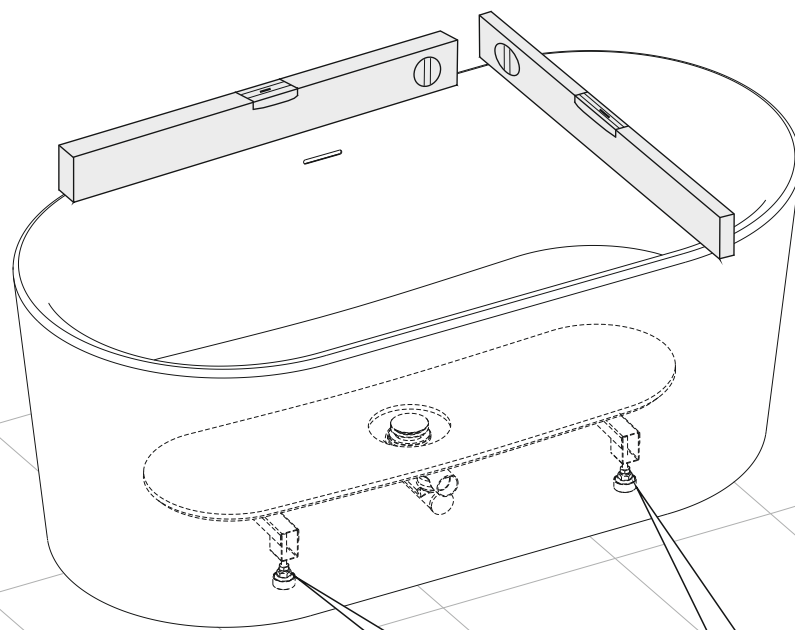
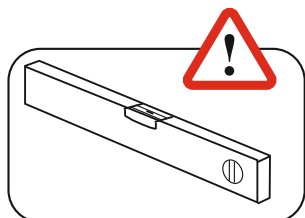

Bath tub must stand on feet – not allowed to stand on panel

Fig. 2

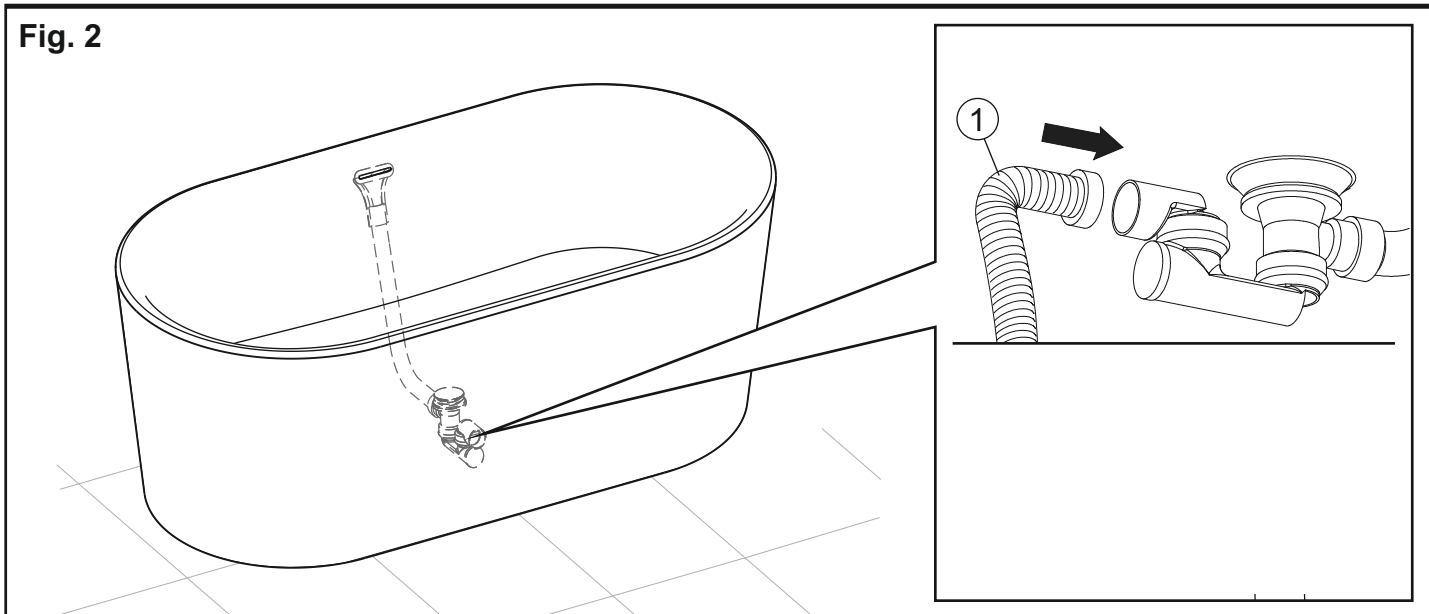

Fig. 3

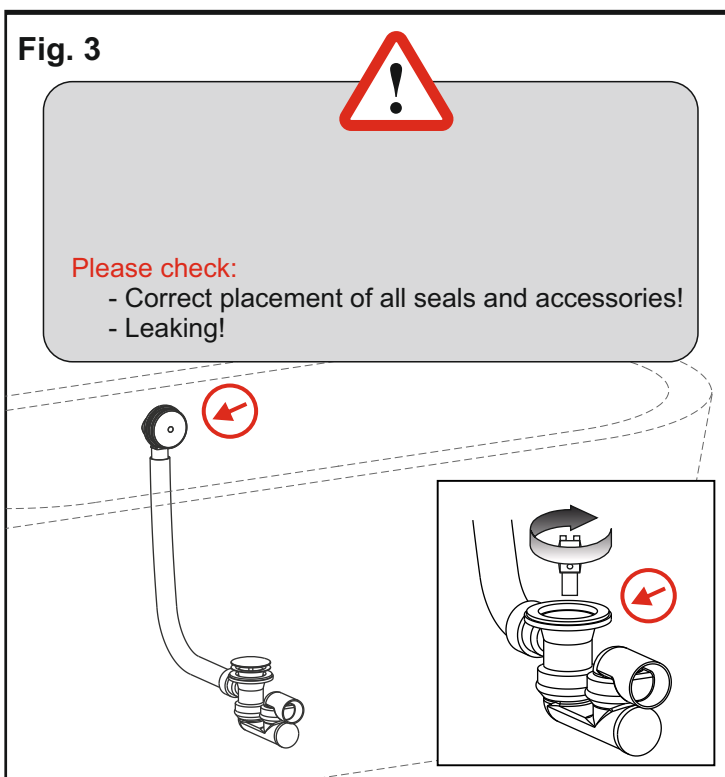

Fig. 4

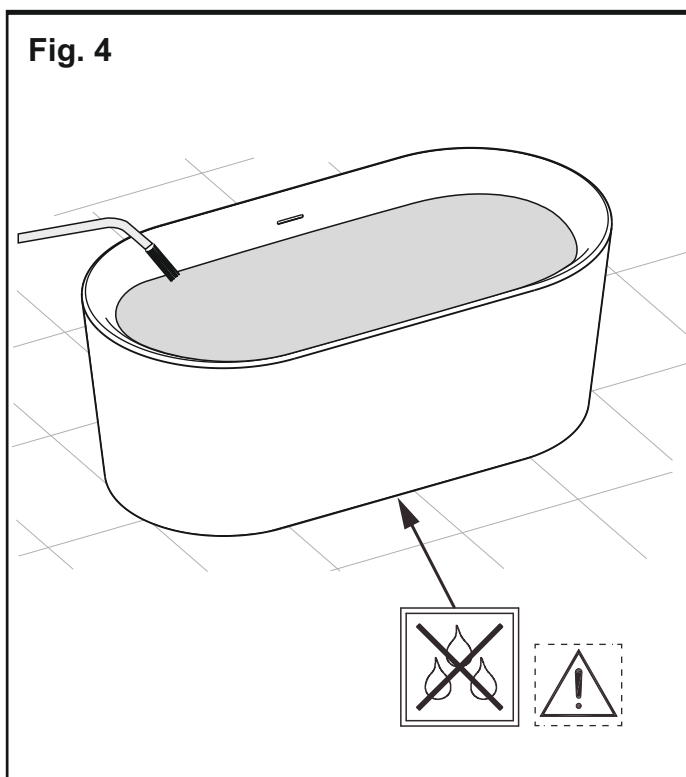
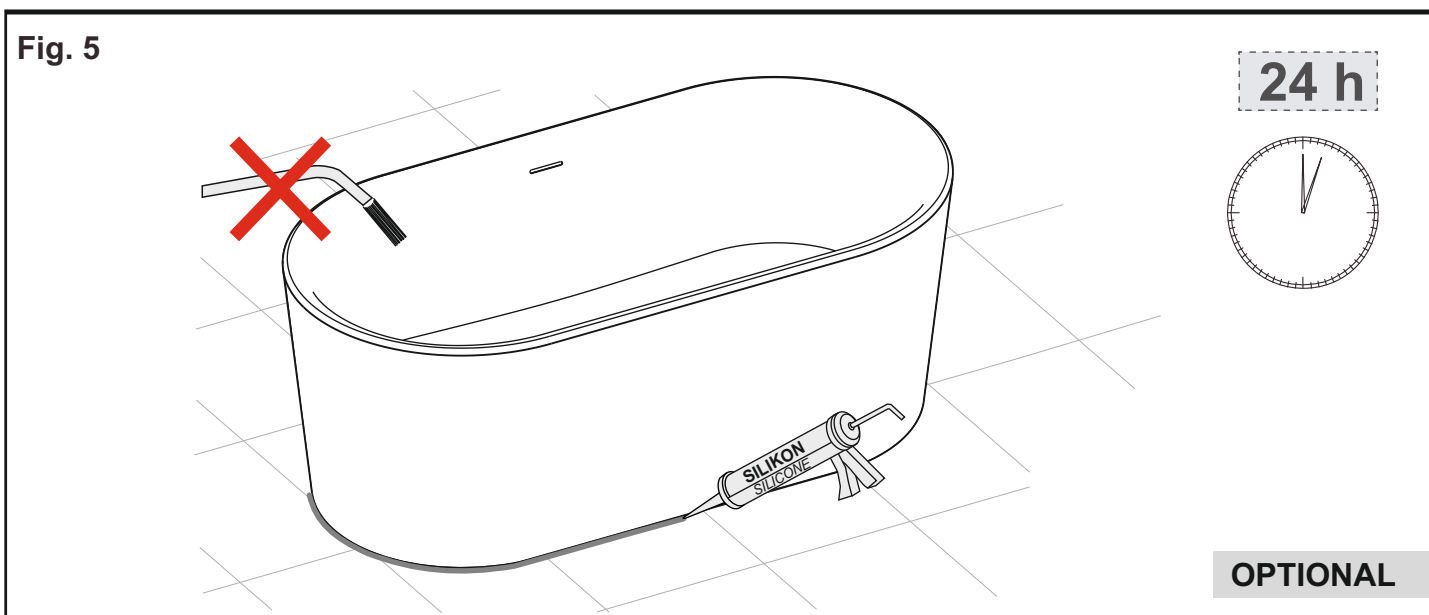
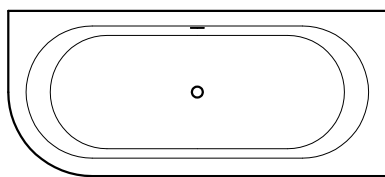

Fig. 5



FREESTANDING BACK TO WALL



Corner L

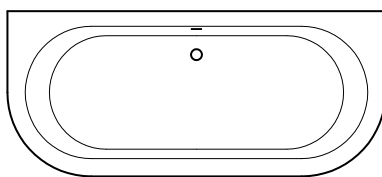

Wall

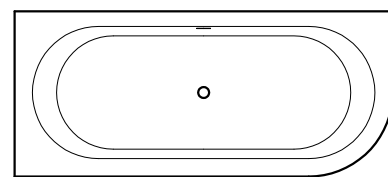

Corner R

1



8x
Ø8x50 mm

3



4x

2



8x
Ø5x50 mm

4

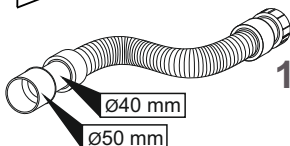

1x

Fig. 1

a Wall

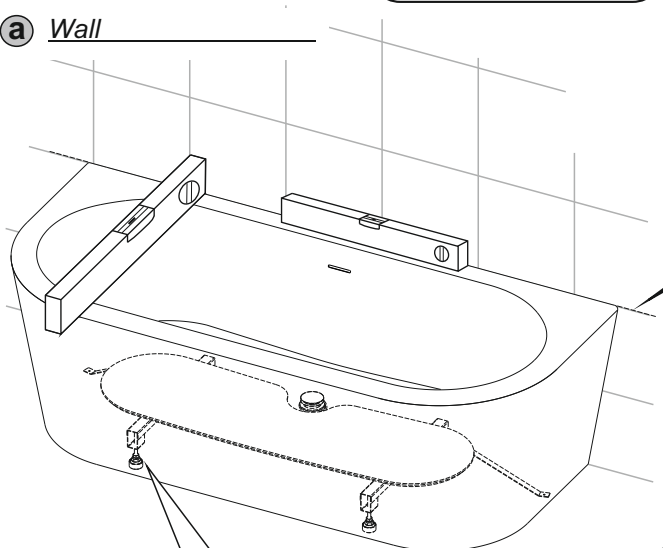
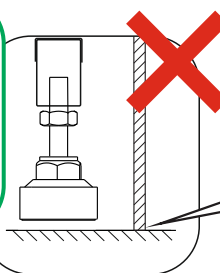
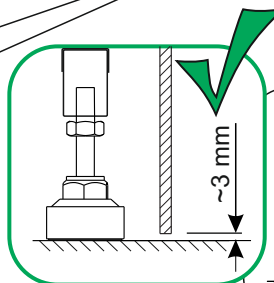
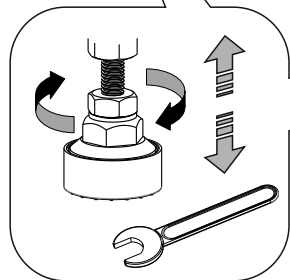
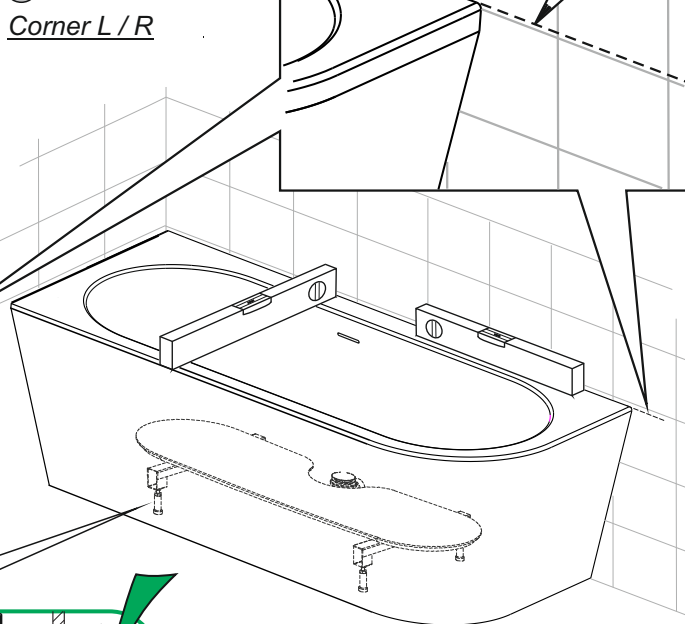

Fig. 2

b

Corner L / R



The bathtub must not hang on the wall brackets with its own weight or when full (Fig 7). They are used only for horizontal fixation to prevent movement of the bathtub. It is imperative to place and adjust the bathtub so that it stands firmly on all feet while the tub is aligned before marking the brackets on the wall.

Fig. 3

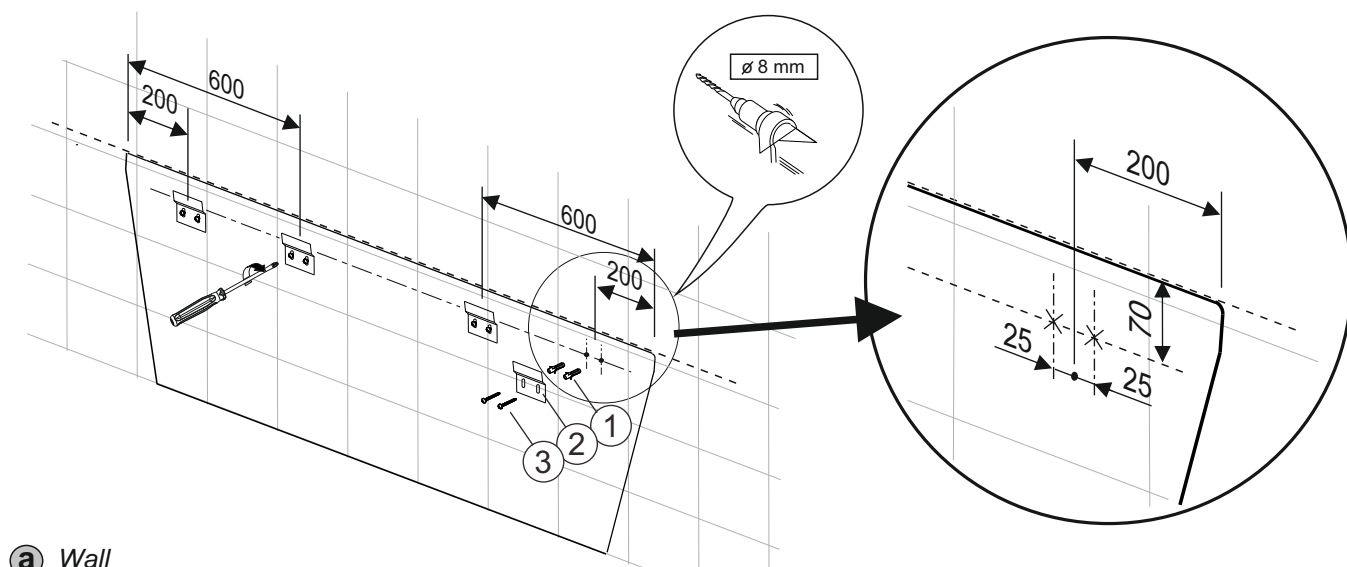

a Wall

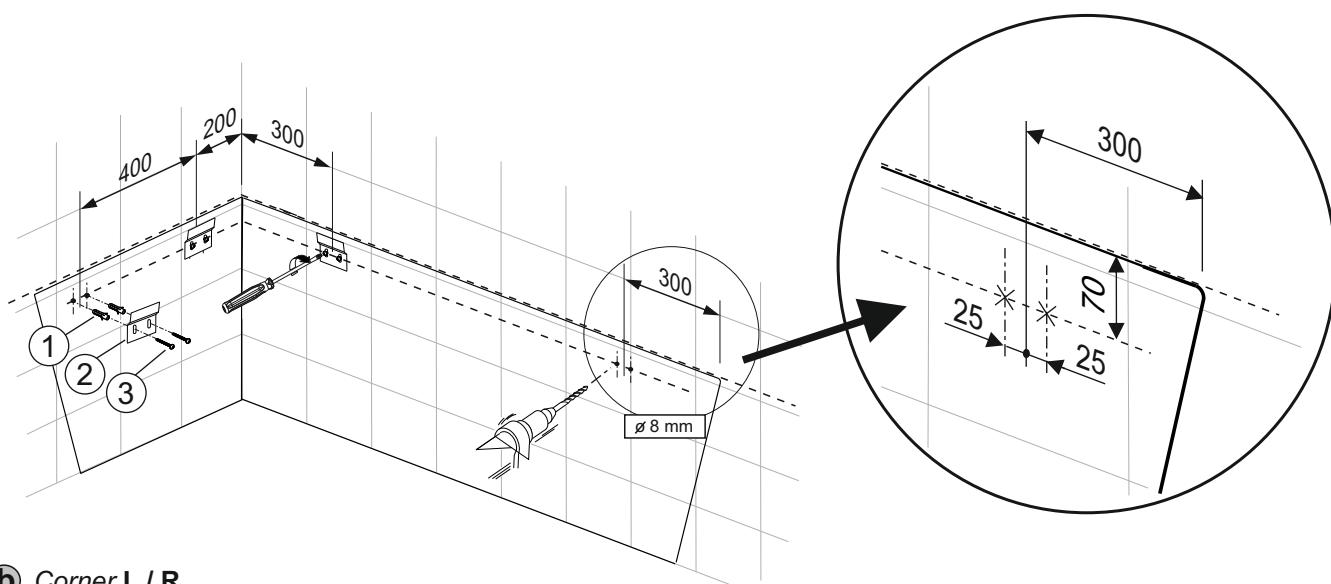

b Corner L / R

Fig. 4

**SOUND PROOF PROFILE
DO NOT REMOVE !**

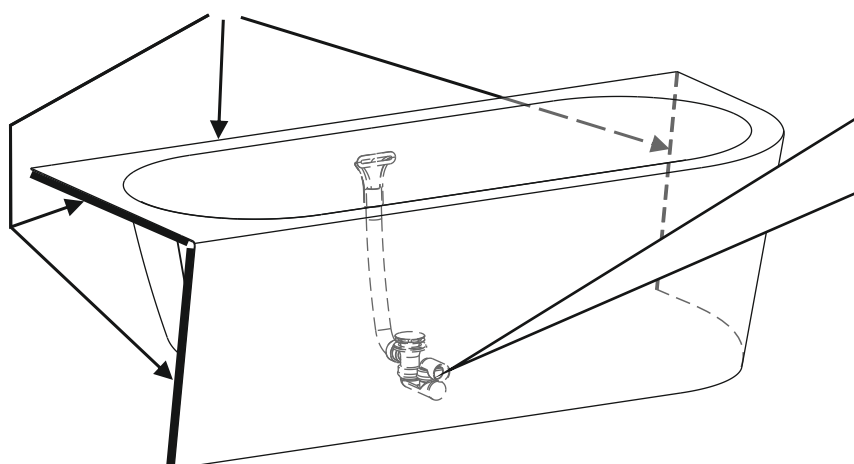

Fig. 5

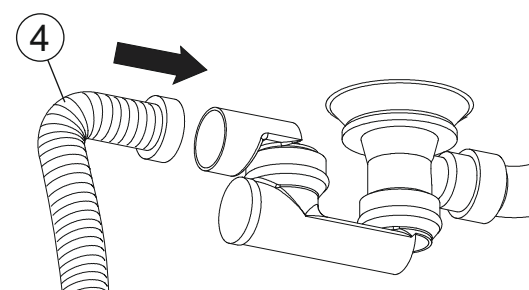

Fig. 6

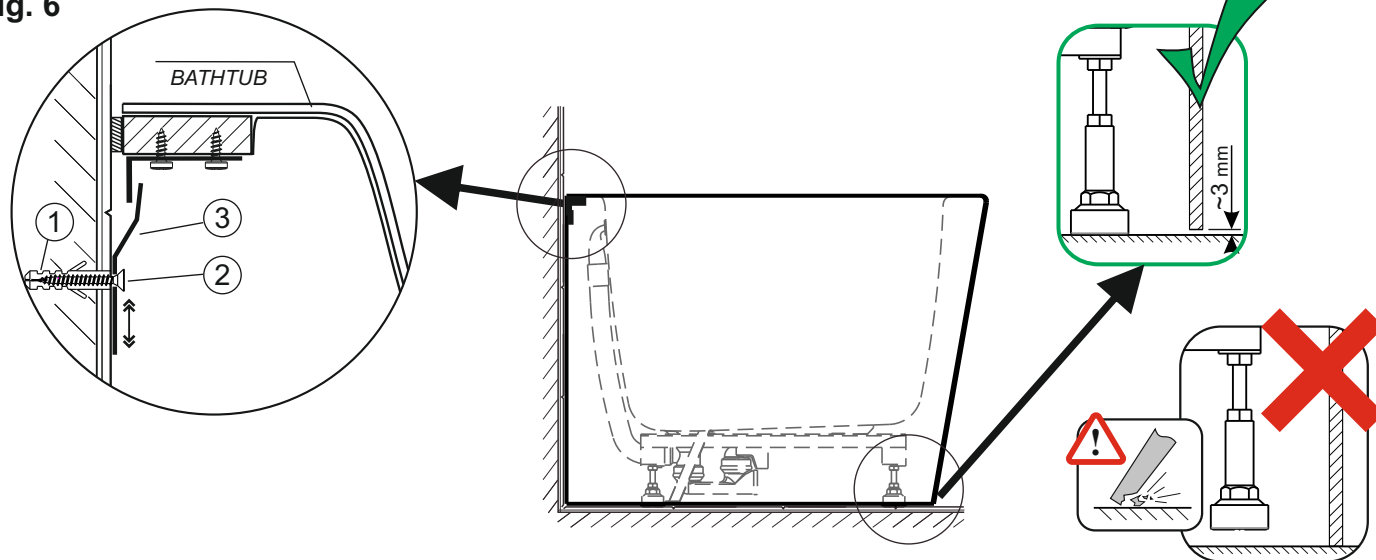

Fig. 7



Please check:

- Correct placement of all seals and accessories!
- Leaking!

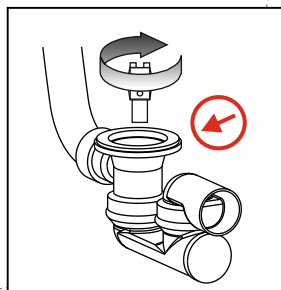
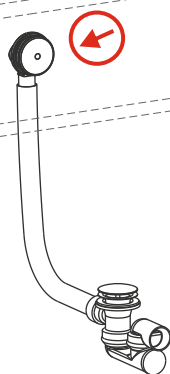

Fig. 8

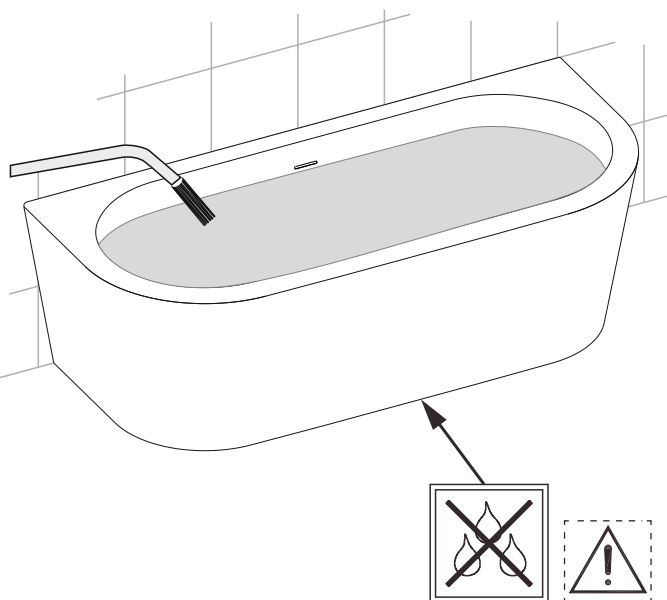
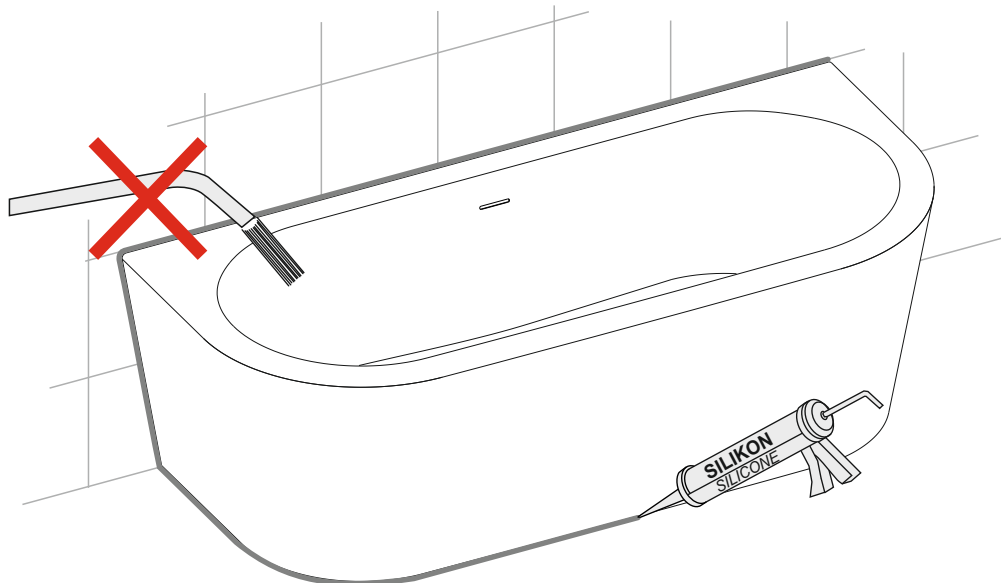
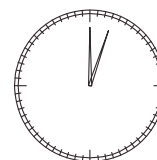

Fig. 9



24 h



OPTIONAL