

# ***Modern Life, Smart Choice***

Shades and dimensions subject to the usual tolerance.

We reserve the right to make technical modifications to the range and alter colors.

# ***Shower toilet user manual***

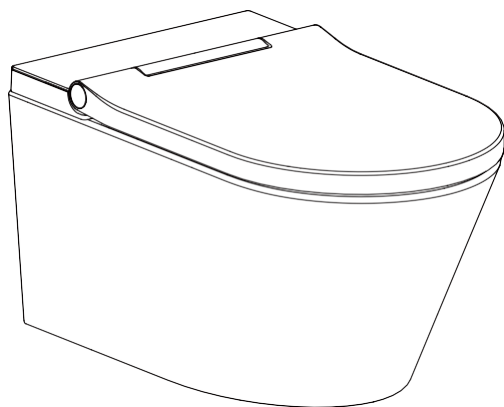



**Table of Contents**

Safety Precautions ..... 2

Description of Parts ..... 6

Operation ..... 8

Trial Operation ..... 10

Maintenance ..... 11

Trouble Shooting ..... 14

Technical Specification ..... 16

Warranty ..... 17

Important User Manual Information ..... 18

## Safety precautions

Read all instructions before use.

Save these instructions for future reference.



### **Warning**

May result in death or serious injury



### **Caution**

- May result in injury or property damage



### **Warning**

1. Do not use a damaged power plug or loose electric outlet.
2. Make sure to use a dedicated electrical outlet. Failing to do so may result in electric shock or fire.
3. Do not move the product by pulling the power plug.
4. Do not handle the power plug with wet hands.
5. Do not forcefully bend the power cord or place heavy objects on it to prevent it from being damaged or deformed.
6. Do not connect and pull out the power plug repeatedly.
7. Unplug the product before cleaning, repairing, inspecting, or replacing parts.
8. Remove any dust or water from the power plug.
9. Do not plug the appliance into an electrical outlet or power strip that is being used by too many appliance. Use an electrical outlet adequate for the wattage of the product.
10. If the power cord is damaged, do not attempt to repair, modify or replace the cord yourself, contact our service center.
11. If the product produces a strange noise, a burnt smell or emits smoke, unplug it immediately from the electrical outlet and then contact us. Failing to do so may result in electric shock or fire.
12. Do not insert a wire or sharp object in any product gaps or the warm air outlet. This may result in electric shock or product damage.
13. Do not place an electric heater near the product or dispose any burning materials such as a lit cigarette in the toilet. This may result in fire or product deformation.
14. Do not place any containers filled with water, medicine, food, any metallic objects, or any flammable material on top of the products. If

## Safety precautions

foreign material enters the product, this may result in electric shock or fire.

15. Do not use the product in locations exposed to excessive moisture and do not splash water onto the product.

16. Do not use the product if it is not working properly. Please unplug the product immediately and call our service center after closing the main water supply valve. Failing to do so may result in electric shock or fire.

17. While taking a shower or cleaning the bath room, pull the power plug out of the electrical outlet and exercise caution that water or detergent does not splash onto the bidet. Failing to do so may result in electric shock or fire.

18. Do not disassemble, repair, or modify the product yourself.

19. Do not use the product while bathing.

20. Do not place or store the product where it can fall or be pulled into a tub or sink.

21. Do not place in or drop the product into water or any other liquid.

22. Do not reach for the product if it has fallen into water. Unplug the product immediately.

23. Do not operate or store the unit in locations where flammable or combustible materials are used.

24. Do not use industrial water or gray water for the supply as this may cause skin damage or disease.

25. Do not block the warm air outlet with your hand.

26. Turn off the main water supply valve when cleaning the filter.

27. The appliance is not to be used by persons (including children) with reduced physical, sensory or mental capabilities, or lack of experience and knowledge, unless they have been given supervision or instruction.

28. Children should not to play with the appliance.

29. Do not press the buttons using excessive force.

30. Do not stand on, or place a heavy object on the seat cover.

31. Use this product for its intended use only, as described in this manual. Do not use attachments that are not recommended by us.

32. Never operate this product if it has a damaged cord or plug, if it is not working properly, if it has been dropped or damaged, or dropped into

## Safety precautions

water. Return the product to our service center for examination and repair.

33. Keep the cord away from heated surface.
34. Never block the air openings of the product or place it on a soft surface such as a bed or couch, where the air openings may be blocked. Keep the air openings free of lint, hair, etc.
35. Never use the product while sleeping or when drowsy.
36. Never drop or insert any object into any opening or hose.
37. Do not use the product outdoors or operate where aerosol (spray) products are being used or where it could be exposed to oxygen.
38. This product should be grounded. In the event of an electrical short circuit, grounding reduces the risk of electric shock by providing an escape route (wire) for the electric current. This product is equipped with a cord consisting of a grounding wire with a grounding plug. The plug must be plugged into an outlet that is properly installed and grounded.
39. Unplug this product before filling. Fill (reservoir) with water only, unless otherwise specified by the manufacturer. Do not over fill (or ignore filling instructions).
40. Cleaning and user maintenance shall not be made by children without supervision.
41. Appliance must be earthed.
42. If the supply cord is damaged, it must be replaced by the manufacturer, its service agent or similarly qualified persons in order to avoid a hazard.
43. The new hose-sets supplied with the appliance are to be used and old hose-sets should not be reused.
44. Please connect the product with hard water hose.
45. Stationary appliances not fitted with means for disconnection from the supply mains having a contact separation in all poles that provide full disconnection under overvoltage category III, the instructions state that means for disconnection must be incorporated in the fixed wiring in accordance with the wiring rules.
46. The product is intended to be permanently connected to the water mains and not connected by a hose-set.

## Safety precautions

### CAUTION

1. Do not connect the main water to the hot water pipe (only connect to cold water supply).
2. After the installation, make sure to check all water supply connections for leaks. Rubber washers should be in place for the water connection hoses and T-valve.
3. Do not open/close the seat cover using excessive force.
4. Exercise caution that urine does not come into contact with the nozzles or warm air dryer outlet. Failure to do so may result in bad odors or malfunction.
5. If the product will not be used for a long period of time, unplug the power cord, close the main water supply valve, and drain any water in the water tank.
6. Do not pull out the bidet hose or connection hose using excessive force.
7. Do not use thinner, benzene, acidic chemicals, chloride, or hydrochloric acid detergent. This may result in corrosion to the metal parts or discoloration or scratches to the bidet body.
8. The appliance is not to be used by persons (including children) with reduced physical, sensory or mental capabilities, or lack of experience and knowledge, unless they have been given supervision or instruction. Children should not play with the appliance.
9. This appliance can be used by children aged 8 years and older and persons with reduced physical, sensory or mental capabilities if they have been given supervision or instructions concerning the use of the appliance in a safe way. They should understand the hazards involved. Cleaning and use maintenance shall not be done by children without supervision.
10. If the supply cord is damaged, it must be replaced by the manufacturer, its service agent or similarly qualified persons in order to avoid a hazard.



11. This marking indicates that this product should not be disposed with other household wastes throughout the EU. To prevent possible harm to the environment or human health from uncontrolled waste disposal, recycle it responsibly to promote the sustainable reuse of material resources.



# Description of parts

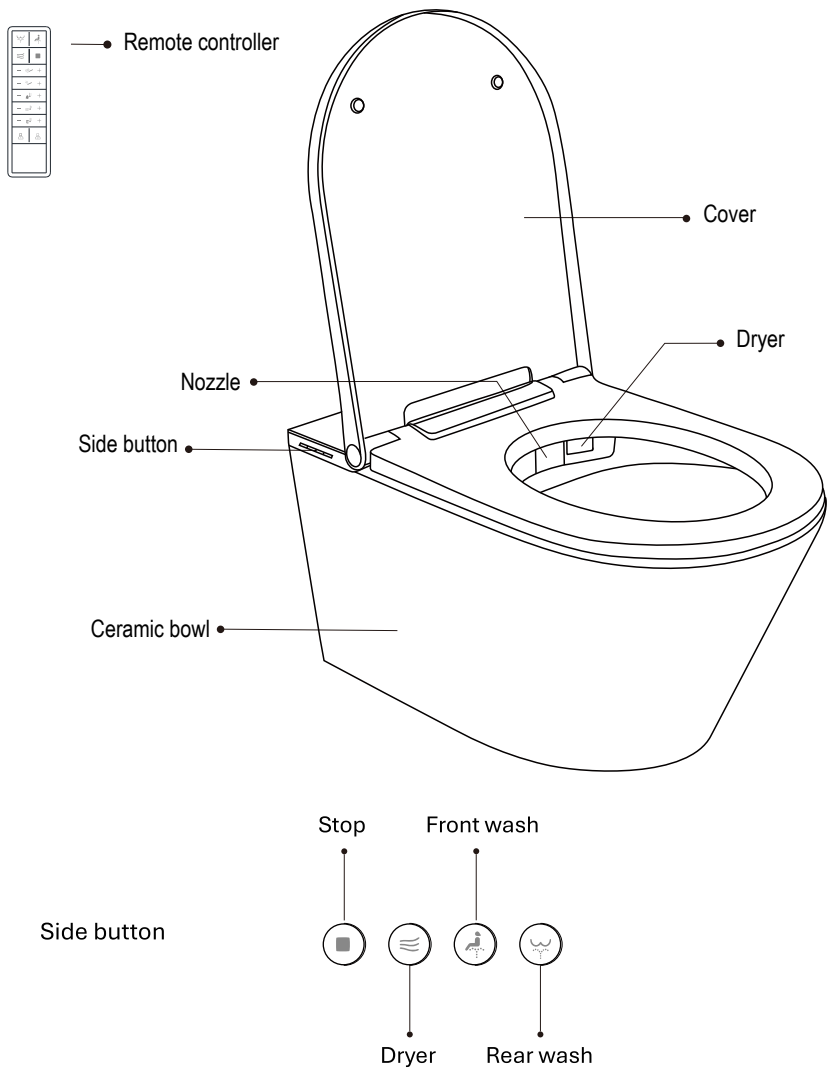

Note:The above drawing is only an example, your version may vary.  
The sensor is activated when users open the cover.

# Description of parts

## Remote control



\*Night mode: deodorizer and pre-wet will not work and active the mute mode for 8 hours

Note:The above drawing is only an example, your version may vary.

# Operation



## **Rear washing/ Oscillating washing**

While sitting, press to activate rear washing for 2 minutes.

While washing is activate, press again to initiate oscillating movement of the nozzle. This moves the nozzle back and forth.



## **Front washing/ Oscillating washing**

While sitting, press to activate front washing for 2 minutes.

While washing is activate, press again to initiate oscillating movement of the nozzle. This moves the nozzle back and forth.



## **Dryer**

While sitting, press to activate dryer to dry wet parts after washing.

Activates for 5 minutes before automatically stopping. If you wish to stop before the time is over, press stop or simply close the cover.



## **Stop**

While sitting, simply press to stop any ongoing function.



## **Nozzle position**

Press to set the nozzle position.

Press "-" and "+" to adjust the nozzle position as preferred.

The nozzle can be moved in 4 different positions.

The previous user's setting apply when no adjustment is made by the current user.

Nozzle position is adjustable anytime while it is active.

Long press "-" for pulsating washing

Long press "+" for warm and cold water washing



## **Wash pressure**

Press to adjust the water pressure as preferred.

There are 3 water pressure levels available.

The previous user's setting apply when no adjustment is made by the current user. Water pressure is adjustable anytime during activation.

Long press "-" to switch flushing mode. (Optional)

Default flush mode is to flush when the cover is closed;

after switch flush mode, when the dryer starts working, the toilet will flush at the same time.

Long press "+" to clean the nozzle manually

# Operation



## Water temperature/Switch mute mode

Press to adjust the water temperature as preferred.

There are 4 water temperature levels available.

The previous user's setting apply when no adjustment is made by the current user.

Water temperature is adjustable anytime during activation.

Long press “-” to restart Bluetooth. (Optional)

When the toilet cannot be found in the app, you can restart Bluetooth this way to reconnect.

Long press “+” to switch to mute mode.

*There will be no sounds of the toilet when “Mute mode” is ON.*



## Dryer temperature

Press to adjust the dryer temperature as preferred.

There are 4 dryer temperature levels available.

The previous user's setting apply when no adjustment is made by the current user.

Dryer temperature is adjustable anytime during activation.

Long press the “-” to activate descaling

Long press the “+” to drain out water in the water tank. (Keep the cover closed)



## Seat temperature

Press to adjust the seat temperature as preferred .

There are 4 seat temperature levels available.

The previous user's setting apply when no adjustment is made by the current user.

Long press “-” to activate night light

Long press “+” to activate night mode

*Night mode means deodorizer and pre-wet will not work and the mute mode is active for 8 hours.*



Long press the “User 1” button after using a function will save the current settings to “User 1”. (This includes: water temperature, water pressure, dryer temperature, seat temperature and the position of the spray nozzle.) Short press “User 1” to switch to the saved settings.



Long press the “User 2” button after using a function will save the current settings to “User 2”. (This includes: water temperature, water pressure, dryer temperature, seat temperature and the position of the spray nozzle.) Short press “User 2” to switch to the saved settings.

# Trial operation

## Function confirmation

1. Please check each function according to the manual.
2. If all works correctly the water will be heated to the set temperature and the warm air will work when you press the dry key, after you switch on the power en open the toilet seat.
3. The remote has been matched with the toilet in the factory. If you change a remote, then you need to match the code again. To do this: Press “dryer + front wash” at the same time for 3 seconds and the toilet will beep, then press the “STOP” button on the remote control and the toilet will beep again. This indicates that the code match is finished.

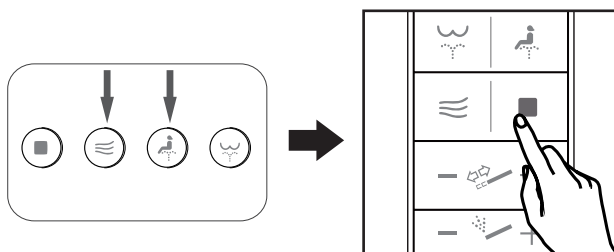

# Maintenance

## Seat cleaning

*Important: Unplug the product from the power source before cleaning or removing the seat.*

Use a soft, damp cloth and mild cleanser to wipe down the seat. DO NOT scrub or use harsh, abrasive products to clean the product. DO NOT use thinner, benzene, acidic chemicals, chloride, or hydrochloric acid detergent. This may result in corrosion to the metal parts or discoloration or scratches to the bidet body.

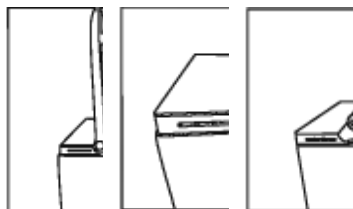

1. Open cover and seat at 90°

2. Press both buttons at same time

3. Lift cover and seat

## Nozzle and sprayer cleaning

1. Please clean the nozzle frequently. Long press water pressure “+”, and the nozzle will come out. Remove the sprayer head and clean it with an old tooth brush or soft cloth. Replace the cleaned sprayer head.
2. Please do not pull at the nozzle. Press the “stop” button after you’re finished cleaning so that the nozzle will go back automatically.

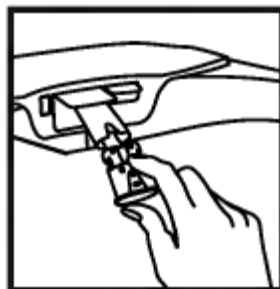

## Normal cleaning

# Maintenance

## Long time non-use

1. Close the angle valve to stop the water supply.

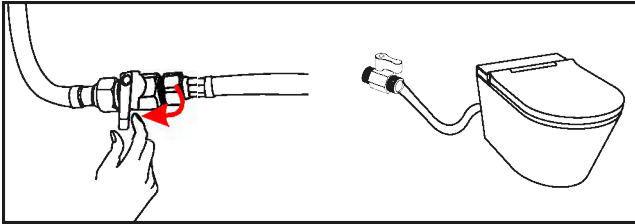

2. Long press the Dryer “+” button to drain out water in the water tank.

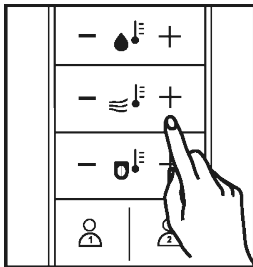

3. Press the power button to stop the power supply.

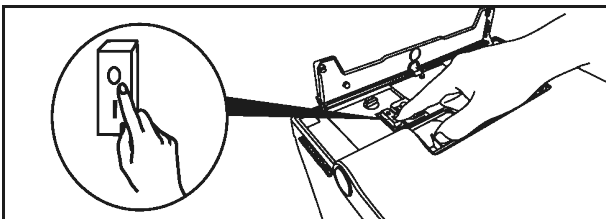

# Maintenance

## Descaling

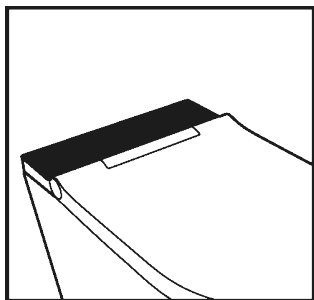

1. Open the glass cover.

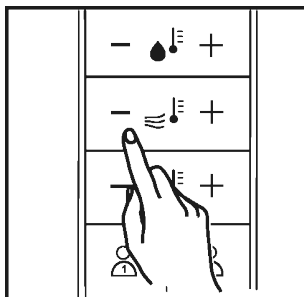

2. Long press the Dryer “-” button to activate the descaling program, the nozzle will self-clean during the drainage process. When all the water has drained out, the toilet will start beeping as a sign to add a descaling agent.

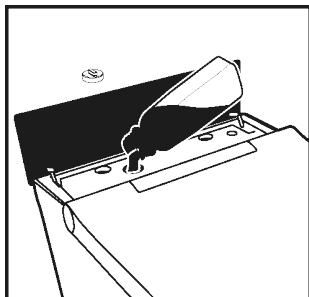

3. Open the rubber cover, pour the descaling agent into the toilet. The toilet will keep beeping while adding the liquid. Stop pouring once you hear a long beep sound.

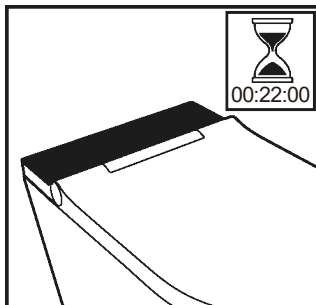

4. Put the rubber cover back on and close the glass cover, the toilet will start the descaling program. The toilet can't be used during this process. If there is no power during the process, the toilet will continue after the reboot. The whole descaling process will last for 22 minutes. There will be a beep sound once the process is done.



## Troubleshooting

***If the bidet isn't working as it should, try these quick checks before contacting our service center – most issues can be solved in a few simple steps. If the problem persists after going through the suggestions below, feel free to reach out. We're happy to help.***

### ***Check the following before continuing:***

- Make sure the bidet is plugged into a working power outlet.
- Check that the remote control has fresh batteries (2x CR 2032) and that they're installed correctly.
- Ensure the main water supply valve is fully open.
- Confirm there are no leaks from hoses or the water supply.
- Make sure the mesh filter is clean and free from buildup or debris.

After checking the items above, refer to the troubleshooting chart below for more solutions.

<b>Problem</b>	<b>Possible causes</b>	<b>Possible solutions</b>
Water flows before or after use	Water coming from nozzles	1. Water that comes out between the nozzles before or after a wash is the self-cleaning process and is normal. 2. Water that drips into the bowl seconds after a wash or self-clean is also normal.
Water leaks from areas other than the nozzles.	1. Water leaking from T-valve 2. Water leaking from the bidet hose connection	1. Make sure that the rubber washer is inserted correctly and that the connector is firmly tightened. 2. Make sure the bidet hose is firmly connected.
App cannot find or connect to the toilet by Bluetooth.	Bluetooth connection is lost.	Long press “-” on the water temperature button to restart Bluetooth.

## Troubleshooting

Problem	Possible causes	Possible solutions
The bidet is not working.	<ol style="list-style-type: none"> <li>1. Bidet is not plugged in.</li> <li>2. The bidet has no power.</li> <li>3. 3. There is power, but nothing reacts.</li> </ol>	<ol style="list-style-type: none"> <li>1. Make sure the bidet is plugged in.</li> <li>2. Check the power button on the control panel to see if it is turned on.</li> <li>3. Check if the batteries of the remote control are working.</li> </ol>
Product shuts off during use.	<ol style="list-style-type: none"> <li>1. Washing time has exceeded the setting time.</li> <li>2. Power failure</li> </ol>	<ol style="list-style-type: none"> <li>1. Press the wash button to extend the time.</li> <li>2. Check the power.</li> </ol>
Lower water flow or spray pressure.	<ol style="list-style-type: none"> <li>1. The filter is clogged</li> <li>2. Water supply valve not opened fully.</li> <li>3. Nozzles are dirty.</li> <li>4. Pressure settings are incorrect.</li> </ol>	<ol style="list-style-type: none"> <li>1. Remove, clean and reinstall the mesh filter.</li> <li>2. Check the water supply valve in your wall.</li> <li>3. Clean the nozzles.</li> <li>4. Adjust the water pressure setting.</li> </ol>
Seat does not heat up.	Seat temperature turned off.	Make sure that the seat temperature setting is on.
Water (wash spray) does not warm up.	Water temperature is turned off.	Make sure that the water temperature setting is on.

## Technical specifications

Power voltage		220-240V~ 50-60Hz 1350W
Water supply	Water input	Connect to the pipe directly
	Water pressure	0.08MPa - 1MPa (0.8kgf/cm <sup>2</sup> -10kgf/cm <sup>2</sup> )
Wash device	Posterior wash water volume	0.4L/min-0.8L/min
	Female wash water volume	0.4L/min-0.8L/min
	Type of water heater	Instantaneous type
	Temperature	Room temp/low 33°C/medium 37°C/high 40°C
	Heating power	Maximum 1600W
	Safety device	Floating switch / Temperature fuse
	Backflow prevention device	Air gap (EN1717/ EN13077/ Type AB)
Seat heating device	Temperature	Room temp/low 30°C/medium 35°C/high 40°C
	Heating power	24W
	Safety device	Temperature fuse
Dryer device	Temperature	Room temp/low 35°C/medium 45°C/high 55°C
	Heating power	220W
	Safety device	Temperature fuse
Power cord length		0.25m
Net weight		32kg

# Warranty

This electronic bidet has been designed and manufactured with great care and attention to detail. We offer a 12-month warranty.

In the following cases, the warranty does not apply:

- a) Damage or loss sustained in fire, earthquake, flood, thunder, or other act of providence, pollution, gas damage, salt damage, and abnormal voltage.
- b) Damage or loss resulting from any installation against the installation manual, any unreasonable use, misuse, abuse, negligence against the cautionary statements of the owner's manual and label on the product, or improper maintenance of the product against the user manual.
- c) Damage or loss resulting from modification, disassembly, or destruction of the product.
- d) Damage or loss resulting from water stain retention, sediments, or foreign matter contained in a water system.
- e) Damage or loss resulting from the quality of water in the region where the product is used.
- f) Damage or loss resulting from relocation after installation, improper installation, or hazardous environment.
- g) Damage or loss resulting from defect other than the product, such as change in the shape of the building frame.
- h) Damage or loss resulting from bites by animals or insects such as mice, or residue of dead animals or insects.
- i) Damage or loss resulting from freezing of the product.
- j) Damage or loss resulting from undesigned power supply (voltage, frequency) and electromagnetic waves generated outside of the product, such as from power lines and peripheral devices.
  - (a) Frequency band(s) in which the radio equipment operates: 2.400 GHz – 2.480 GHz
  - (b) Maximum radio-frequency power transmitted in the frequency band(s) in which the radio equipment operates: -5 dB
- k) Damage or loss resulting from use mounted on moving vehicles such as cars and ships.
- l) Damage or loss resulting from consumption of battery, etc.
- m) Damage or loss resulting from abrasion of daily maintenance points (water drain valve, filter, washer, packing, etc.)

## Important user manual information

If you want to dispose of this product, do not mix it with general household waste. There is a separate collection system for used electronic products in accordance with legislation that requires proper treatment, recovery, and recycling.

Only discard discharged batteries. They should not be disposed of with household waste, but rather at appropriate collection sites.

**Memo**