



Duravit No. 1

Pre-installation Data Sheet

Bathtubs and Whirltubs

Index

Notes.....	2
Pre-installation	3
Maintenance openings	5
Data sheets for bathtubs and whirltubs	9

Notes

NOTESPLANNING

Before starting the installation, plan the layout in detail, taking the site conditions into consideration.

TARGET READERSHIP AND QUALIFICATIONS

All work associated with the installation and water connection may only be undertaken by a plumber and all work associated with the electrical installation may only be undertaken by a licensed electrician.

SAFETY INSTRUCTIONS

Incorrect handling/transport may result in product damage.

The metal frame and whirl system are not resilient.

- > Never hold by the metal frame or whirl system.

Improper transport can cause damage to the product and/or property damage, e.g. leaks.

- > Wear appropriate protective clothing.
- > Avoid knocks.

Risk of product and/or property damage!

The breach of local and country-specific regulations and standards can cause damage to the product and/or property damage.

- > Observe the local installation regulations and any country-specific standards at all times.

Duravit AG assumes no liability for the consequences of improper handling or improper transport.

Pre-installation

Pre-installation

INSTALLATION LOCATION / INSTALLATION ROOM

> Make sure that the installation location fulfils the following criteria

Doors / external access	<ul style="list-style-type: none"> Ensure that doors or other access openings are large enough to accommodate transport dimensions, keeping in mind the weight and need for sufficient manoeuvring room.
Required area	<ul style="list-style-type: none"> Allow for enough space around the tub for the installation.
Floor	<ul style="list-style-type: none"> Completely level. At a right angle to the wall. Note the overall strength of the floor structure including the floor finish. There must not be any underfloor heating under the tub. Install tubs after the tiles. (Top edge of finished floor). Depending on the combination of tub and whirl system it is possible that system components may protrude beyond the edge of the tub. We therefore recommend installation in a support frame. Tolerances for acrylic: As a result of the manufacturing process, deviations from the nominal dimensions may occur within the limits specified in the DIN 198 standard. Please take this into account in your planning.
Wall	<ul style="list-style-type: none"> Tiled. At a right angle to the tub. Completely straight. Note the overall strength of the wall structure including the wall finish.

WATER INSTALLATION

NOTE

Bathtubs without overflow will overflow into the room.

> If a bathtub is installed without an overflow, a floor drain must be installed to protect the building against overflow water in accordance with DIN 1986-100.

NOTE

A pipe interrupter is absolutely essential for tubs with a base inlet (DIN EN 1717).

> Comply with assembly scheme.

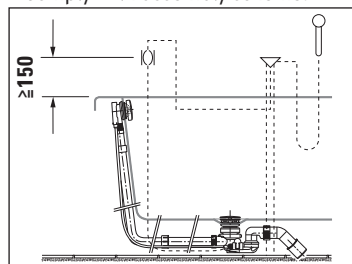

Water connection

- Connections for the water supply and drains must be in compliance with the currently valid standards and public regulations.
- Position the water drain (DN 50) flush to the mounting surface or out of the wall directly above the mounting surface; see drawing for recommended area.

MAINTENANCE OPENINGS AND AIR SUPPLY

NOTE

It is recommended to install the tub with a removable bathtub panel due to the improved maintenance options.

Tiling the tub

The following maintenance openings must be provided:

- Cable-driven waste and overflow 200 x 200 mm
- Units 500 x 500 mm
(Please see the section on "Maintenance openings")
- Provide an opening in the panel for the air supply with an effective area of approx. 15 cm² (e.g. 3 x 5 cm or 2 x 7.5 cm).

Tub with a panel

- The panel must be removed for maintenance, and with a seamless panel, the tub must be removed from the wall. Your plans should therefore include a clearance in front of the tub.
- The air supply for the whirl system (ventilation grille/ventilation slot) must not be covered.

ELECTRICAL INSTALLATION



DANGER

Risk of fatal electric shock

- Disconnect the power supply while working on the electrical components.
- The device must be earthed. Earthed appliances must be permanently connected to fixed wiring.
- Connect the device only to the designated electrical cable.
- NEVER touch the power supply line with wet hands.

Pre-installation

- Lay a permanent power supply line which must be on a separate circuit.
 - The device itself does not have electrical leakage protection function. The device must be supplied through a residual current device (RCD) with a rated residual operating current not exceeding 30 mA.
 - Means for disconnection must be incorporated in the fixed wiring in accordance with the wiring rules and have a contact separation in all poles that provides full disconnection under overvoltage category III conditions outside the prescribed protection zones (0 – 2).
 - Leave 3000 mm of the supply line exposed.
- Lay an equipotential bonding cable:
 - Leave 3000 mm of cable exposed.
- Select a supply line cross-section based on the connected load on the identification plate (2.5 mm – 4 mm).
- Confirm that the grounding wire is 10 mm (3/8") longer than the L and N wire.
- Install a circuit breaker.

PROTECTION ZONES

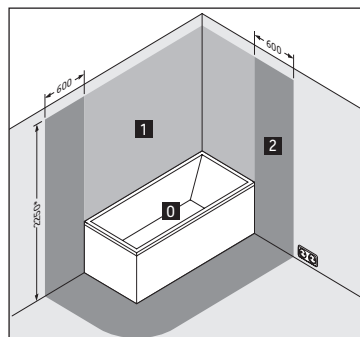

* Or the height of the highest fixed-location shower head/water outlet, whichever is higher.

WHITE LED LIGHT UNDER THE EDGE OF THE TUB FOR BATHTUBS

Electrical data

Power supply

White LED light under the edge of the tub	220 – 240 V AC, 50/60 Hz,
#791847 00 0 00 0000	50 W
#791848 00 0 00 0000	
#791849 00 0 00 0000	

Fuse $I_N = 16 \text{ A}$

RCD $I_{\Delta N} \leq 30 \text{ mA}$

WHIRLTUBS

Electrical data

Whirl system	Rated power with standard equipment	Max. rated power, fully-equipped
Air System (# 760XXX XX X AS 00XX)	0.76 kW	0.85 kW
Air System (DuraSolid) (# 760XXX XX X AS 00XX)	0.58 kW	0.58 kW
Jet Project (# 760XXX XX X JP 10XX)	0.66 kW	0.66 kW
Jet System (# 760XXX XX X JS 10XX)	0.59 kW	0.67 kW
Combi-System P (# 760XXX XX X CP 10XX)	1.89 kW	1.98 kW
Combi-System E (# 760XXX XX X CE 10XX)	1.91 kW	2.96 kW
Combi-System L (# 760XXX XX X CL 10XX)	1.59 kW	2.64 kW
Jet System E (# 760XXX XX X JE 10XX)	1.14 kW	2.20 kW

Maintenance openings

Maintenance

Install the whirltub in such a way that all of the important equipment (pump, blower and control system) remains accessible. It is recommended to install the tub with a removable furniture panel for easy maintenance.

Location of the whirl system components

The illustrations show the standard configuration for the components of the whirl system* with the location of the operating unit. The back massage is located at the head end (depending on the whirl system).

Custom-made designs available on request. In such cases we will require a drawing showing the desired layout. Duravit will confirm whether the desired layout can be implemented.

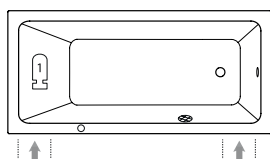

#760487, #760488, #760489,
#760490, #760491,

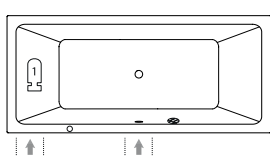

#760492

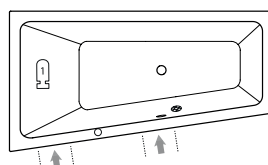

#760504, #760506, #760508

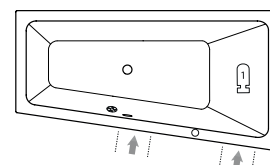

#760505, #760507, #760509

Legend



Unit 1



Unit 2*



Control panel**



Suction screen



Recommended
equipment covers



Recommended
equipment covers***

* Only Combi-Systems / ** The number of operating elements is based on the whirl system and the additional modules selected / *** Only necessary for Combi-System E/L in combination with sound and/or coloured LED light

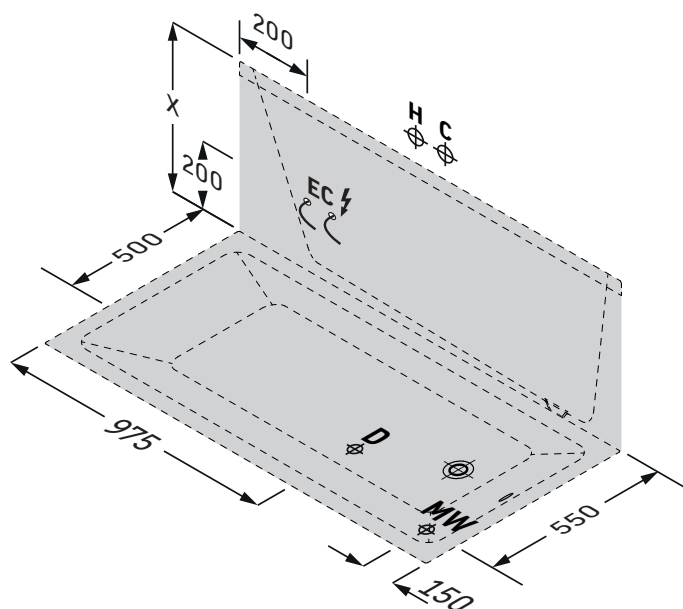

- H: Hot water connection
 C: Cold water connection
 D: Drain connection
 MW: Mixed water connection for water inlet
 EC: Electricity connection

Bathtub

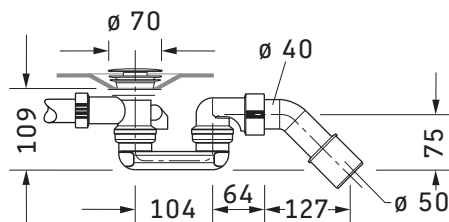

Siphon #790225

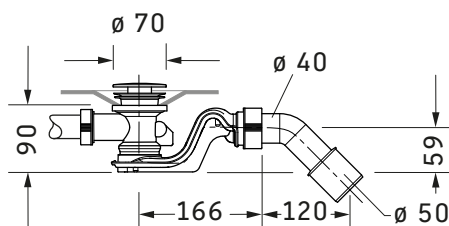

Siphon with water inlet #792201

Whirltub

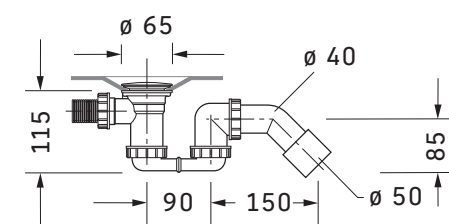

Siphon (inclusive)

		Height [mm]	including feet [mm]	including support [mm]
X	Bathtub	420	535 - 600	545
X	Whirltub	420	545 - 575	

Technical specifications

Net weight [kg]	Floor load [kg/m ²]	Shipping weight [kg]	Shipping dimensions l x w x h [cm]	Drain connection [mm]	Inlet connection (OG) [inch]	Whirlsystem	Model-No.
18,0	165	40,5	110 x 72 x 166	40 / 50	1/2		700487 00 0 00 0000
32,0	176	59,9	187 x 87 x 77	40 / 50	3/4	Jet-Project	760487 00 0 JP 1000

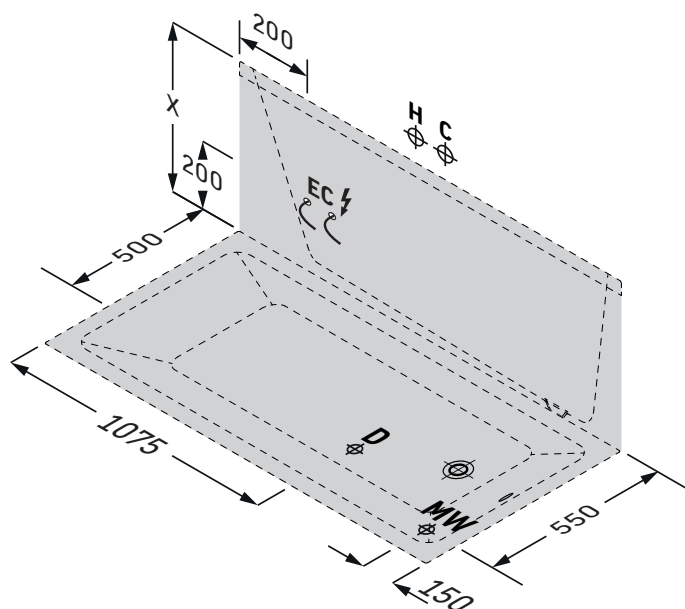

- H: Hot water connection
C: Cold water connection
D: Drain connection
MW: Mixed water connection for water inlet
EC: Electricity connection

Bathtub

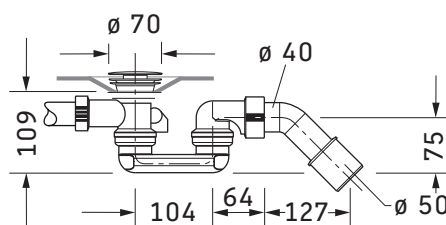

Siphon #790225

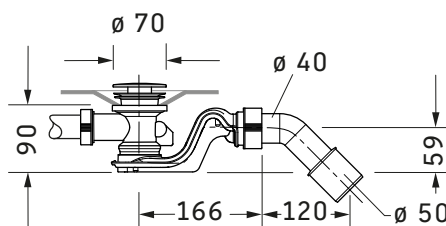

Siphon with water inlet #792201

Whirltub

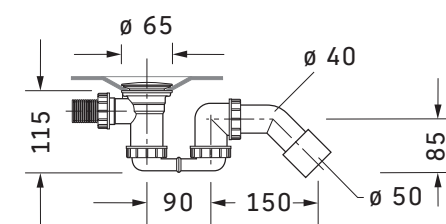

Siphon (inclusive)

		Height [mm]	including feet [mm]	including support [mm]
X	Bathtub	420	535 - 600	545
X	Whirltub	420	545 - 575	

Technical specifications

Net weight [kg]	Floor load [kg/m ²]	Shipping weight [kg]	Shipping dimensions l x w x h [cm]	Drain connection [mm]	Inlet connection (OG) [inch]	Whirlsystem	Model-No.
18,5	168	42,1	110 x 72 x 176	40 / 50	1/2		700488 00 0 00 0000
32,0	180	59,9	187 x 87 x 77	40 / 50	3/4	Jet-Project	760488 00 0 JP 1000

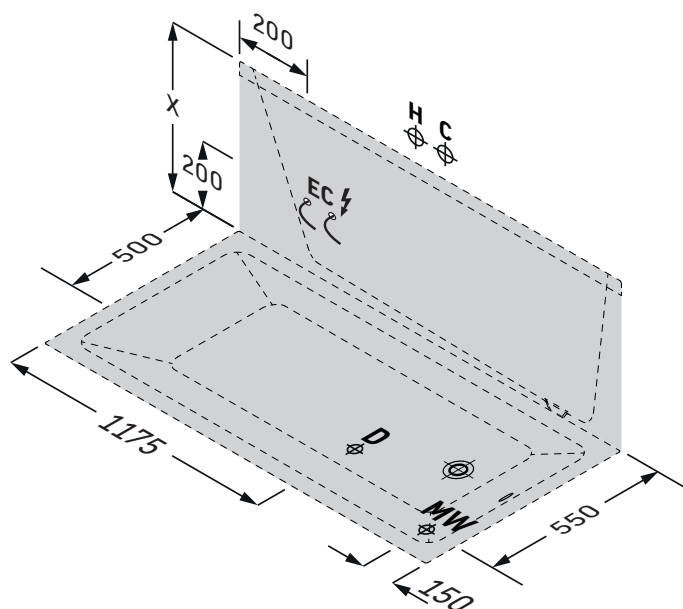

- H: Hot water connection
 C: Cold water connection
 D: Drain connection
 MW: Mixed water connection for water inlet
 EC: Electricity connection

Bathtub

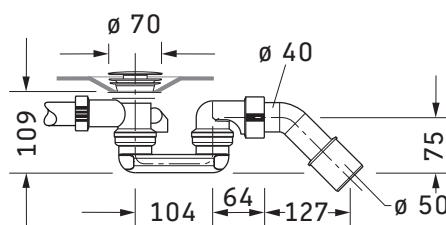

Siphon #790225

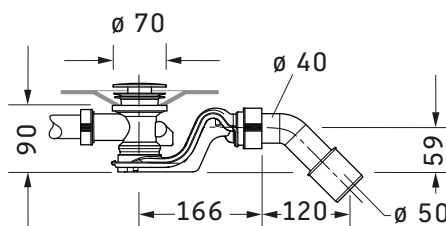

Siphon with water inlet #792201

Whirltub

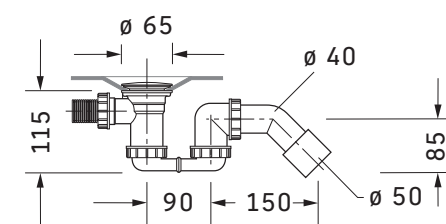

Siphon (inclusive)

		Height [mm]	including feet [mm]	including support [mm]
X	Bathtub	420	535 - 600	545
X	Whirltub	420	545 - 575	

Technical specifications

Net weight [kg]	Floor load [kg/m ²]	Shipping weight [kg]	Shipping dimensions l x w x h [cm]	Drain connection [mm]	Inlet connection (OG) [inch]	Whirlsystem	Model-No.
19,5	172	44,2	110 x 72 x 186	40 / 50	1/2		700489 00 0 00 0000
33,0	183	60,9	187 x 87 x 77	40 / 50	3/4	Jet-Project	760489 00 0 JP 1000

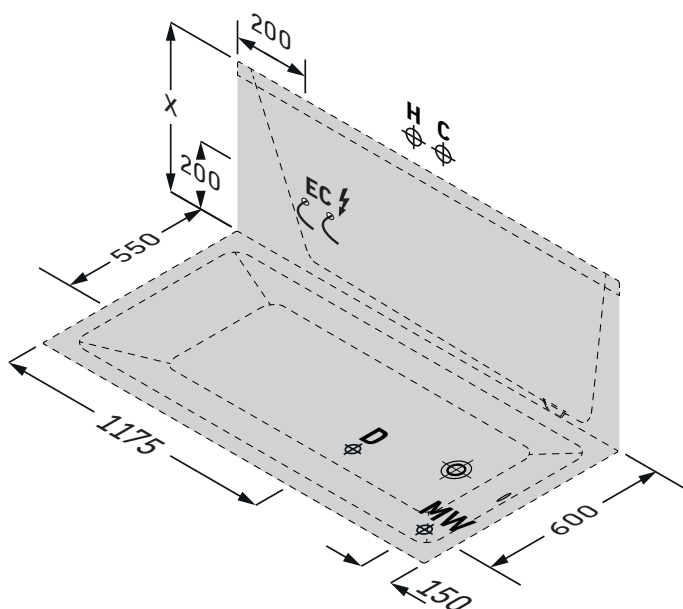

- H: Hot water connection
 C: Cold water connection
 D: Drain connection
 MW: Mixed water connection for water inlet
 EC: Electricity connection

Bathtub

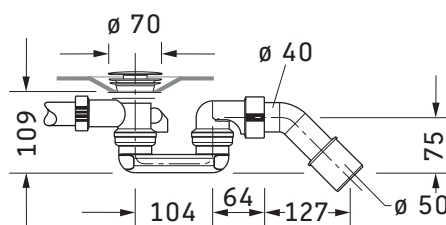

Siphon #790225

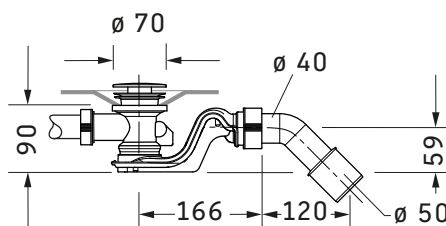

Siphon with water inlet #792201

Whirltub

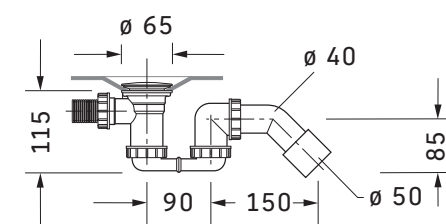

Siphon (inclusive)

		Height [mm]	including feet [mm]	including support [mm]
X	Bathtub	420	535 - 600	545
X	Whirltub	420	545 - 575	

Technical specifications

Net weight [kg]	Floor load [kg/m ²]	Shipping weight [kg]	Shipping dimensions l x w x h [cm]	Drain connection [mm]	Inlet connection (OG) [inch]	Whirlsystem	Model-No.
20,5	177	45,8	110 x 77 x 186	40 / 50	1/2		700490 00 0 00 0000
34,0	187	61,9	187 x 87 x 77	40 / 50	3/4	Jet-Project	760490 00 0 JP 1000

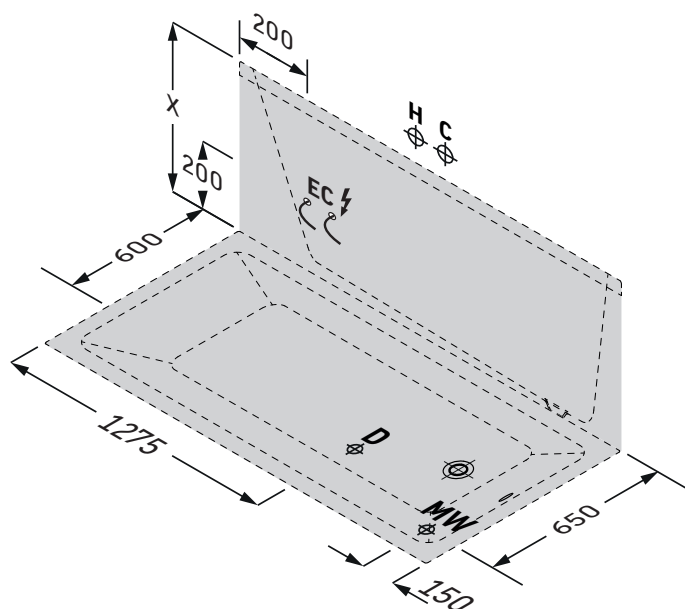

- H: Hot water connection
 C: Cold water connection
 D: Drain connection
 MW: Mixed water connection for water inlet
 EC: Electricity connection

Bathtub

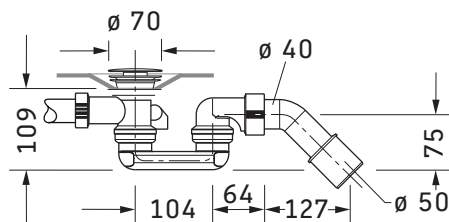

Siphon #790225

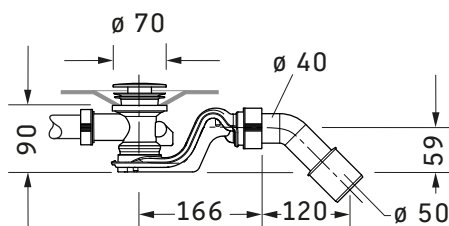

Siphon with water inlet #792201

Whirltub

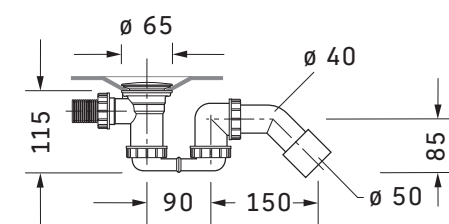

Siphon (inclusive)

		Height [mm]	including feet [mm]	including support [mm]
X	Bathtub	420	535 - 600	545
X	Whirltub	420	545 - 575	

Technical specifications

Net weight [kg]	Floor load [kg/m ²]	Shipping weight [kg]	Shipping dimensions l x w x h [cm]	Drain connection [mm]	Inlet connection (OG) [inch]	Whirlsystem	Model-No.
22,0	182	48,4	110 x 82 x 196	40 / 50	1/2		700491 00 0 00 0000
36,0	192	63,9	187 x 87 x 77	40 / 50	3/4	Jet-Project	760491 00 0 JP 1000

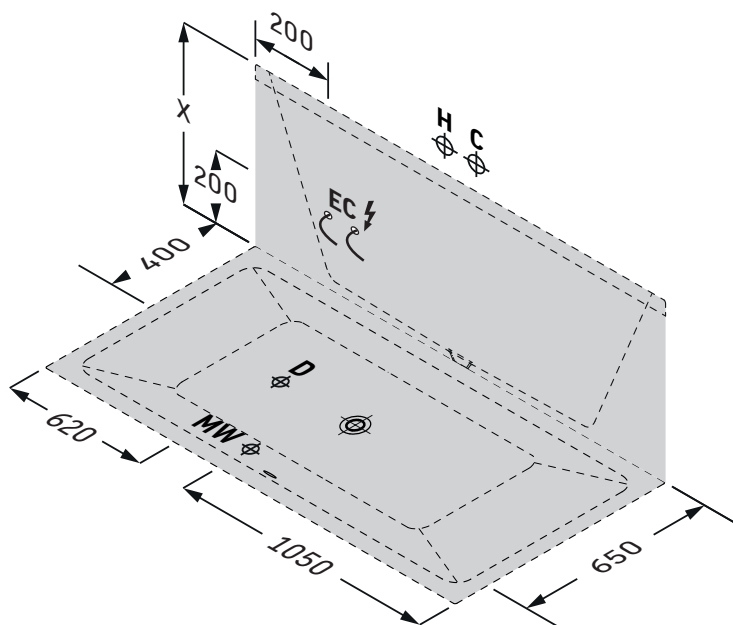

- H: Hot water connection
 C: Cold water connection
 D: Drain connection
 MW: Mixed water connection for water inlet
 EC: Electricity connection

Bathtub

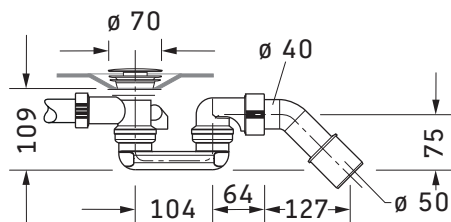

Siphon #790225

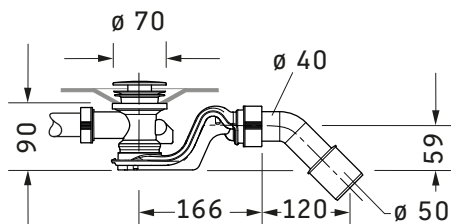

Siphon with water inlet #792201

Whirltub

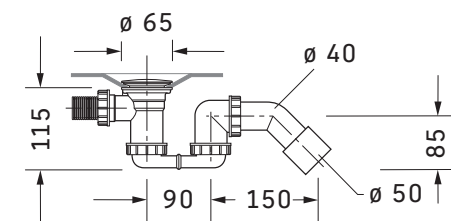

Siphon (inclusive)

		Height [mm]	including feet [mm]	including support [mm]
X	Bathtub	420	535 - 600	545
X	Whirltub	420	545 - 575	

Technical specifications

Net weight [kg]	Floor load [kg/m ²]	Shipping weight [kg]	Shipping dimensions l x w x h [cm]	Drain connection [mm]	Inlet connection (OG) [inch]	Whirlsystem	Model-No.
25,0	170	51,4	110 x 82 x 196	40 / 50	1/2		700492 00 0 00 0000
39,0	180	66,9	187 x 87 x 77	40 / 50	3/4	Jet-Project	760492 00 0 JP 1000

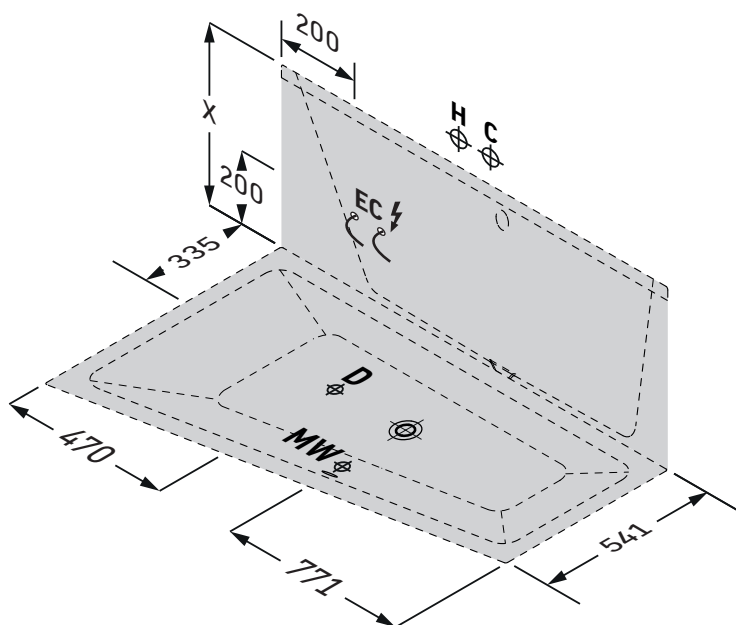

- H: Hot water connection
 C: Cold water connection
 D: Drain connection
 MW: Mixed water connection for water inlet
 EC: Electricity connection

Bathtub

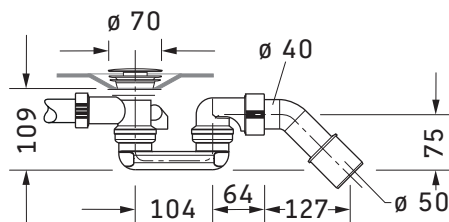

Siphon #790225

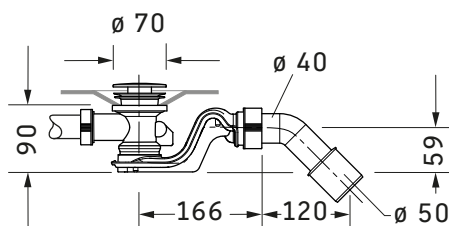

Siphon with water inlet #792201

Whirltub

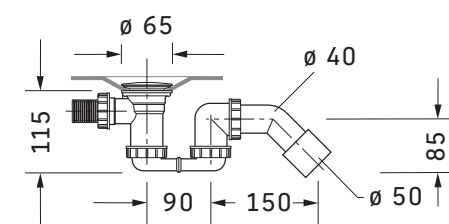

Siphon (inclusive)

		Height [mm]	including feet [mm]	including support [mm]
X	Bathtub	480	595 - 660	610
X	Whirltub	480	605 - 635	

Technical specifications

Net weight [kg]	Floor load [kg/m²]	Shipping weight [kg]	Shipping dimensions l x w x h [cm]	Drain connection [mm]	Inlet connection (OG) [inch]	Whirlsystem	Model-No.
22,5	165	46,7	110 x 82 x 166	40 / 50	1/2		700504 00 0 00 0000
36,0	176	67,0	206 x 108 x 85	40 / 50	3/4	Jet-Project	760504 00 0 JP 1000

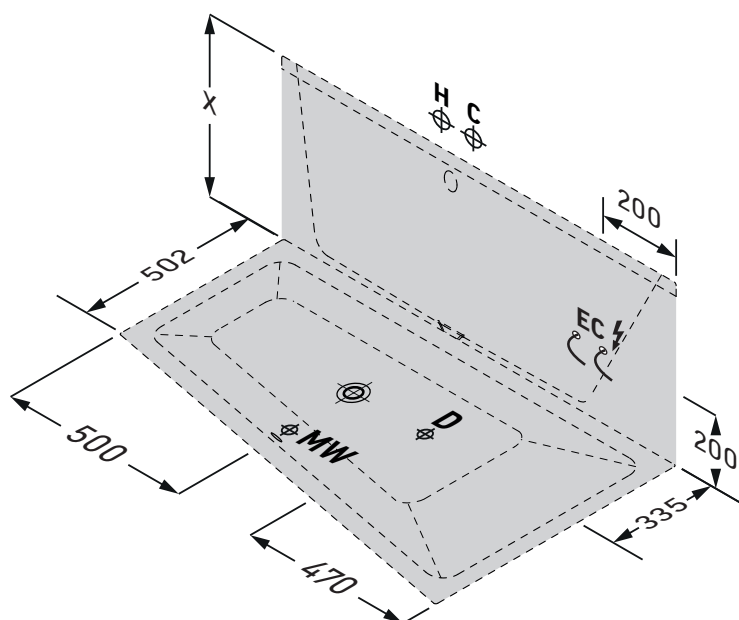

- H: Hot water connection
C: Cold water connection
D: Drain connection
MW: Mixed water connection for water inlet
EC: Electricity connection

Bathtub

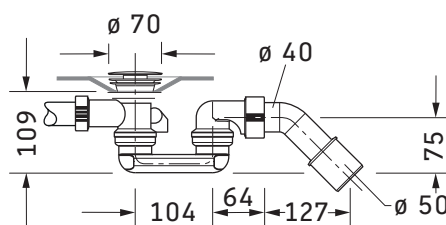

Siphon #790225

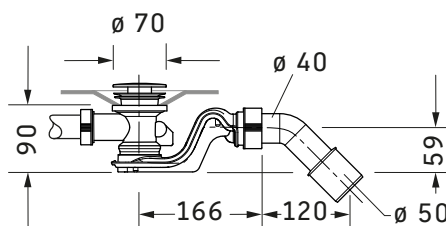

Siphon with water inlet #792201

Whirltub

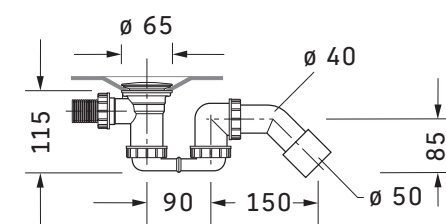

Siphon (inclusive)

		Height [mm]	including feet [mm]	including support [mm]
X	Bathtub	480	595 - 660	610
X	Whirltub	480	605 - 635	

Technical specifications

Net weight [kg]	Floor load [kg/m ²]	Shipping weight [kg]	Shipping dimensions l x w x h [cm]	Drain connection [mm]	Inlet connection (OG) [inch]	Whirlsystem	Model-No.
22,5	165	46,7	110 x 82 x 166	40 / 50	1/2		700505 00 0 00 0000
36,0	176	67,0	206 x 108 x 85	40 / 50	3/4	Jet-Project	760505 00 0 JP 1000

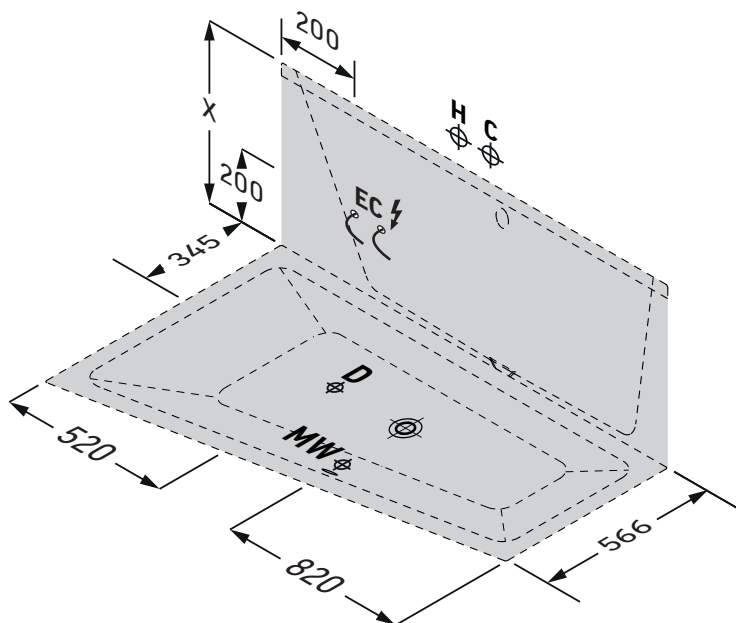

- H: Hot water connection
 C: Cold water connection
 D: Drain connection
 MW: Mixed water connection for water inlet
 EC: Electricity connection

Bathtub

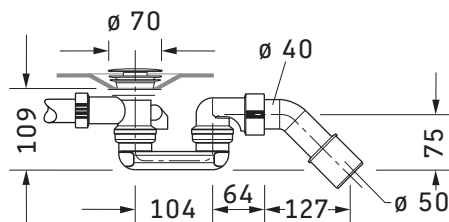

Siphon #790225

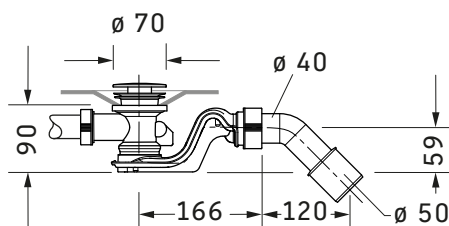

Siphon with water inlet #792201

Whirltub

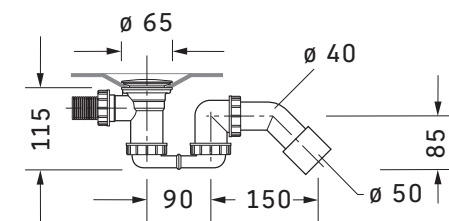

Siphon (inclusive)

		Height [mm]	including feet [mm]	including support [mm]
X	Bathtub	480	595 - 660	610
X	Whirltub	480	605 - 635	

Technical specifications

Net weight [kg]	Floor load [kg/m ²]	Shipping weight [kg]	Shipping dimensions l x w x h [cm]	Drain connection [mm]	Inlet connection (OG) [inch]	Whirlsystem	Model-No.
24,0	165	50,3	110 x 87 x 176	40 / 50	1/2		700506 00 0 00 0000
38,0	175	69,0	206 x 108 x 85	40 / 50	3/4	Jet-Project	760506 00 0 JP 1000

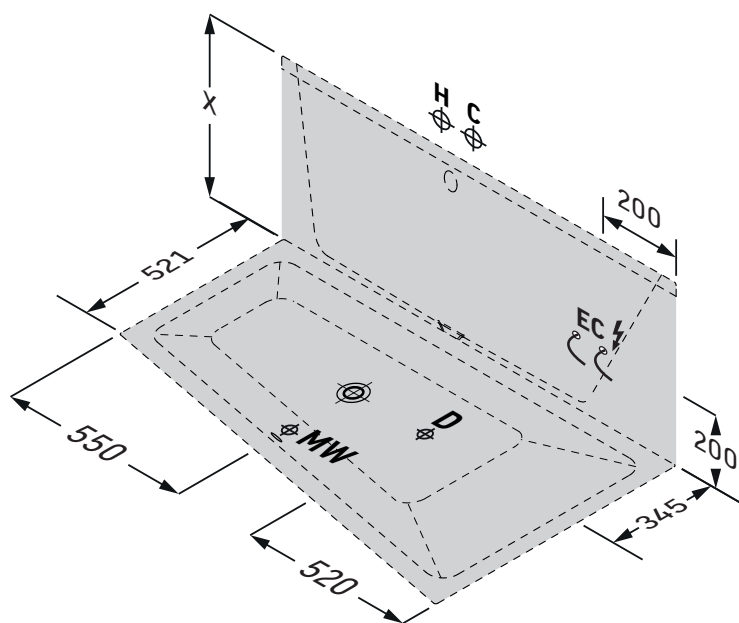

- H: Hot water connection
 C: Cold water connection
 D: Drain connection
 MW: Mixed water connection for water inlet
 EC: Electricity connection

Bathtub

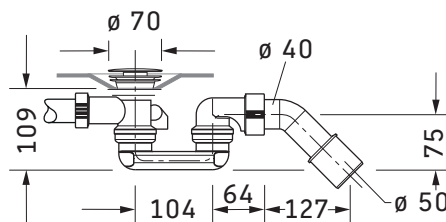

Siphon #790225

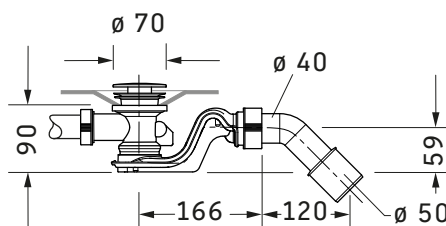

Siphon with water inlet #792201

Whirltub

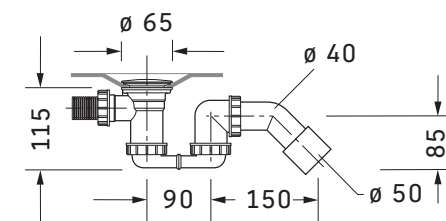

Siphon (inclusive)

		Height [mm]	including feet [mm]	including support [mm]
X	Bathtub	480	595 - 660	610
X	Whirltub	480	605 - 635	

Technical specifications

Net weight [kg]	Floor load [kg/m ²]	Shipping weight [kg]	Shipping dimensions l x w x h [cm]	Drain connection [mm]	Inlet connection (OG) [inch]	Whirlsystem	Model-No.
24,0	165	50,3	110 x 87 x 176	40 / 50	1/2		700507 00 0 00 0000
38,0	175	69,0	206 x 108 x 85	40 / 50	3/4	Jet-Project	760507 00 0 JP 1000

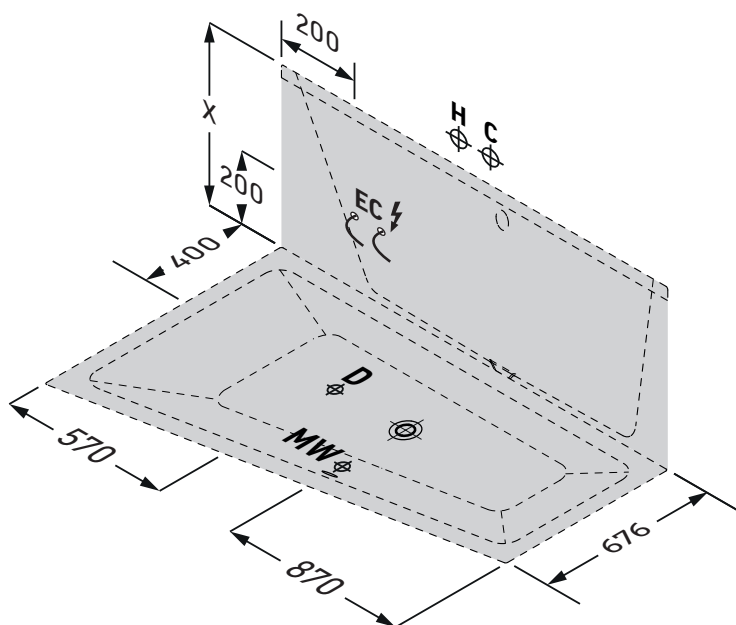

- H: Hot water connection
 C: Cold water connection
 D: Drain connection
 MW: Mixed water connection for water inlet
 EC: Electricity connection

Bathtub

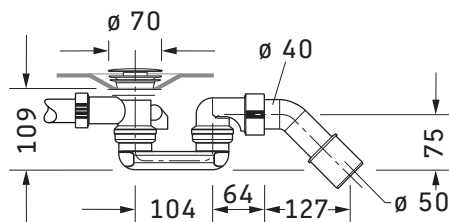

Siphon #790225

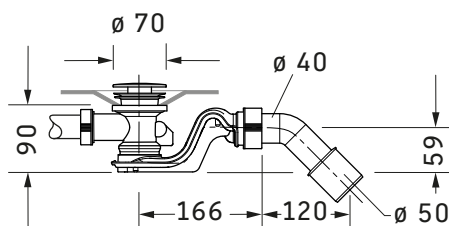

Siphon with water inlet #792201

Whirltub

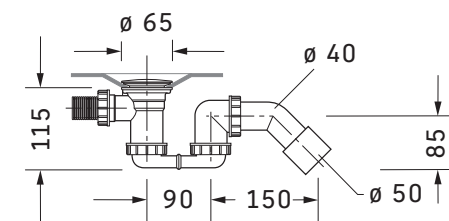

Siphon (inclusive)

		Height [mm]	including feet [mm]	including support [mm]
X	Bathtub	480	595 - 660	610
X	Whirltub	480	605 - 635	

Technical specifications

Net weight [kg]	Floor load [kg/m²]	Shipping weight [kg]	Shipping dimensions l x w x h [cm]	Drain connection [mm]	Inlet connection (OG) [inch]	Whirlsystem	Model-No.
26,5	174	55,3	110 x 102 x 186	40 / 50	1/2		700508 00 0 00 0000
40,0	182	71,0	206 x 108 x 85	40 / 50	3/4	Jet-Project	760508 00 0 JP 1000

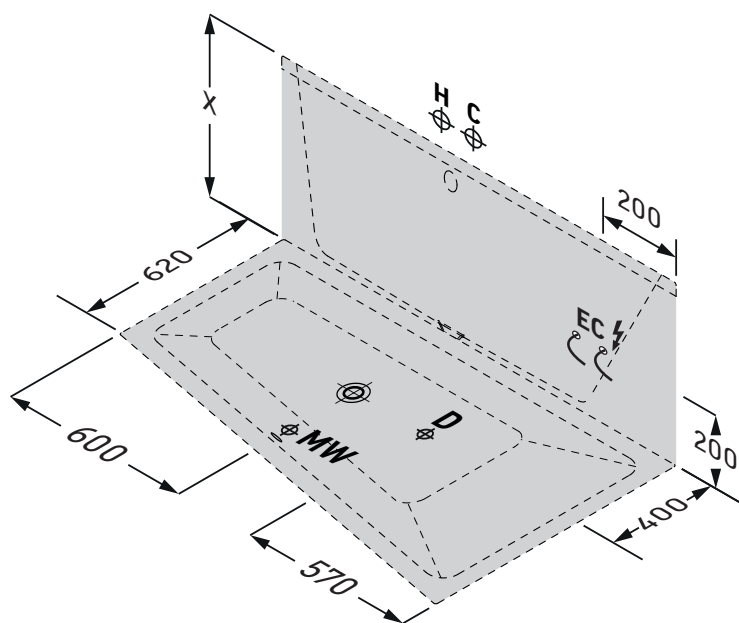

- H: Hot water connection
 C: Cold water connection
 D: Drain connection
 MW: Mixed water connection for water inlet
 EC: Electricity connection

Bathtub

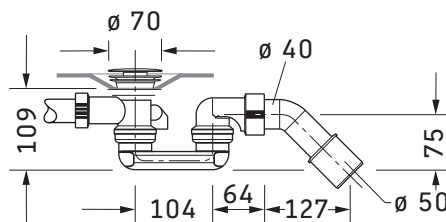

Siphon #790225

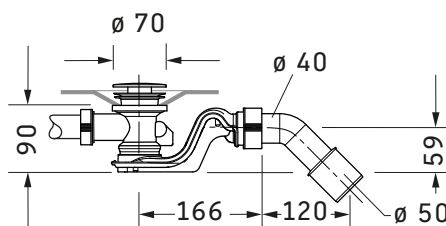

Siphon with water inlet #792201

Whirltub

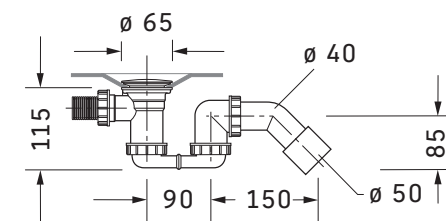

Siphon (inclusive)

		Height [mm]	including feet [mm]	including support [mm]
X	Bathtub	480	595 - 660	610
X	Whirltub	480	605 - 635	

Technical specifications

Net weight [kg]	Floor load [kg/m²]	Shipping weight [kg]	Shipping dimensions l x w x h [cm]	Drain connection [mm]	Inlet connection (OG) [inch]	Whirlsystem	Model-No.
26,5	174	55,3	110 x 102 x 186	40 / 50	1/2		700509 00 0 00 0000
40,0	182	71,0	206 x 108 x 85	40 / 50	3/4	Jet-Project	760509 00 0 JP 1000

DURAVIT AG
P.O. Box 240
Werderstr. 36
78132 Hornberg
Germany
Phone +49 78 33 70 0
Fax +49 78 33 70 289
info@duravit.com
www.duravit.com

