

8.7 Schluter®-KERDI-LINE



Owners Manual

INNOVATIVE SOLUTIONS FOR CERAMIC AND STONE TILE

LINEAR DRAINS FOR BONDED WATERPROOFING ASSEMBLIES

Application and Function

8.7 Schluter®-KERDI-LINE is a low profile linear floor drain specifically designed for bonded waterproofing assemblies. KERDI-LINE can be installed adjacent to walls or at intermediate locations in showers, steam rooms, wet rooms, and other applications that require waterproofing and drainage. The floor can be sloped on a single plane to KERDI-LINE, which enables the use of large-format tiles and creates interesting design opportunities.

Schluter®-KERDI-LINE consists of a formed stainless steel channel body and a grate assembly that can be seamlessly adjusted to the thickness of the ceramic tile or stone covering from 1/8" to 1" (3 mm to 25 mm). The channel body features a standard 2" (50 mm) no-hub outlet and is attached to the pipe using an appropriate mechanical (e.g., flexible or no-hub) coupling. The simple connection to standard drain outlets makes KERDI-LINE suitable for new construction and renovation.

Schluter®-KERDI-LINE includes a corresponding polystyrene foam channel support and can be installed in conjunction with the matching **8.8 Schluter®-KERDI-SHOWER-L/-LS** sloped trays with integrated Schluter®-KERDI waterproofing or a sloped mortar bed covered with the **8.1 Schluter®-KERDI** waterproofing membrane. The trays are available for wall (-LS) or center (-L) drain placement. Surrounding walls are made waterproof using Schluter®-KERDI or Schluter®-KERDI-BOARD.

The perimeter of the channel body consists of a bonding flange laminated with a collar made of Schluter®-KERDI. It ensures a simple and secure connection to the

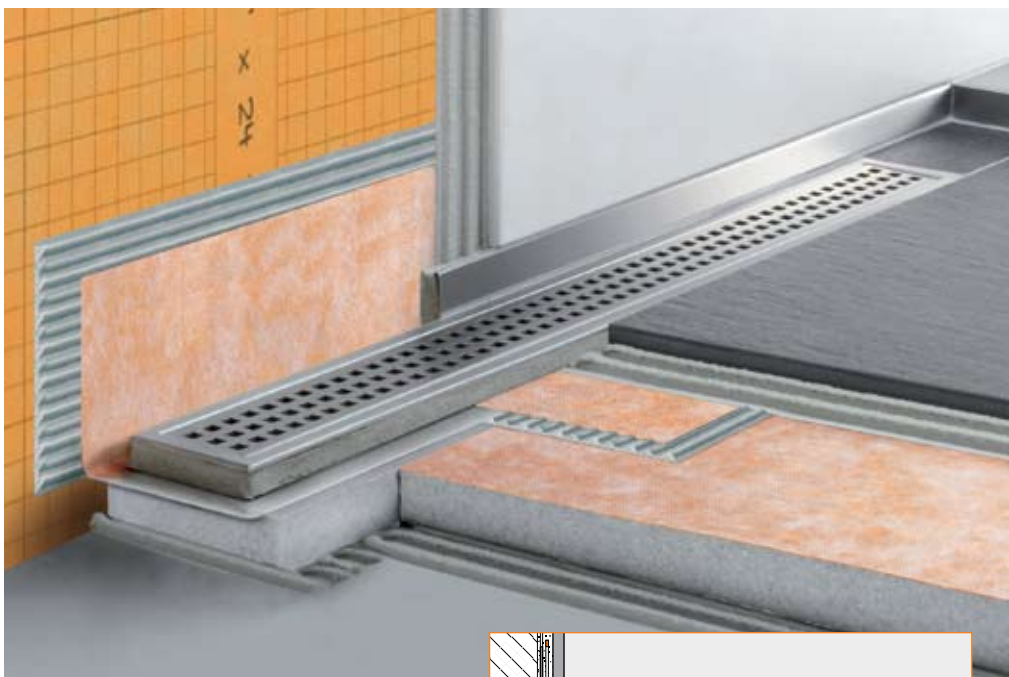

8.7 Schluter®-KERDI-LINE

bonded waterproofing assembly, both in the floor area and on adjacent walls.

The grate assembly consists of a brushed stainless steel frame and three design grate options. Option A is a closed-design, brushed stainless steel grate. Option B is a brushed stainless grate with square perforations. Option C is a stainless steel pan with Schluter®-KERDI laminated on the inside for setting tile inserts up to 3/8" (10 mm) thick.

Schluter®-KERDI-LINE is available in channel lengths from 20" to 48" (50 cm to 120 cm) in 4" (10 cm) increments. Please note that the bonding flange extends approximately 1" (2.5 cm) beyond the channel on all sides. The **14.4 Schluter®-SHOWERPROFILE-S/-R** system profiles represent an elegant solution for finishing the area between

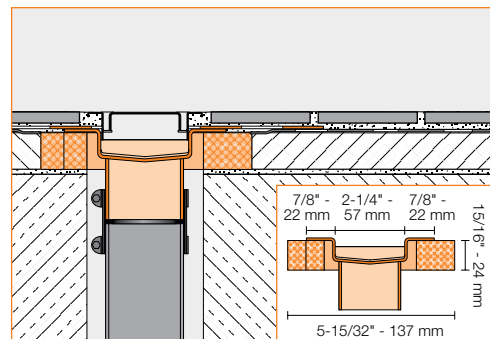
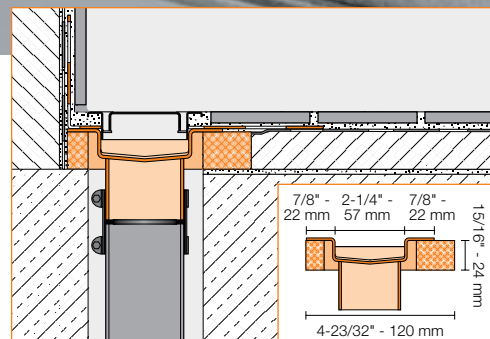



The channel support is made of pressure-resistant, expanded polystyrene (EPS).

Schluter®-KERDI-LINE is suitable for use in residential and commercial applications, including areas subject to foot and wheelchair traffic, such as showers and wet rooms in homes, hotels, schools, healthcare facilities, etc.

The Schluter®-SHOWERPROFILE-S anchoring leg is made of recycled, rigid PVC. The Schluter®-SHOWERPROFILE-S/-R profiles are made of 304 (1.4301 = V2A) stainless steel with Schluter®-KERDI laminated to the backside.

Stainless steel can sustain high mechanical stresses and is particularly suitable for applications requiring resistance against chemicals and acids. However, even stainless steel is not resistant to all chemical stresses, and may be affected by hydrochloric and hydrofluoric acid or certain chloride and brine concentrations, which may be present in detergents or swimming pools. In special cases, the suitability of the selected floor drainage system must be verified based on the anticipated chemical, mechanical, and/or other stresses.

Maintenance

Schluter®-KERDI-LINE requires no special maintenance and is resistant to mold and fungi. The grate may be removed to clean the channel body and the drainpipe. Stainless steel grates exposed to the environment or aggressive substances should be cleaned periodically using a mild household cleaner. Regular cleaning maintains the neat appearance of stainless steel and reduces the risk of corrosion. All cleaning agents must be free of hydrochloric and hydrofluoric acid.

Material Properties and Areas of Application

The Schluter®-KERDI-LINE channel body is formed using 304 (1.4301 = V2A) stainless steel and features a bonding flange with a Schluter®-KERDI collar laminated on the surface. Schluter®-KERDI is a bonded waterproof membrane made of soft polyethylene, which is covered on both sides with a special fleece webbing to anchor the membrane in the thin-set mortar. The frame and grates are made of 304 (1.4301 = V2A) stainless steel.