

## OWNER'S MANUAL

### Swash 1200/1400 Luxury Bidet Toilet Seats

S1200-EW

S1400-EW

S1400-EB

S1200-RW

S1400-RW

S1400-RB



## **Attach Proof of Purchase to This Page**

Joindre une preuve d'achat à cette page

Adjunte prueba de compra a esta página

---

# CONTENTS

---

This manual contains important safety information. Before operating the bidet, please read this manual thoroughly, and retain it for future reference.

## GENERAL INFO

- 02 SAFETY INFORMATION
- 06 PRODUCT INFORMATION
- 06 Product Features
- 08 Product Dimensions
- 09 Product Parts

## PRODUCT INSTALLATION

- 10 PRODUCT INSTALLATION
- 10 Installation Parts
- 11 Before Installation
- 11 Swash Installation
- 14 Remote Control Installation
- 15 External Bidet Filter Installation

## PRODUCT OPERATION

- 16 OPERATING THE SWASH
- 16 S1200 Remote Control Guide
- 18 S1400 Remote Control Guide
- 20 Bidet Seat Controls Guide
- 21 Using the Swash 1200/1400
- 25 Using the Swash 1400's  
Additional Features
- 26 Swash Special Mode Operations

## TECHNICAL INFO

- 28 PRODUCT SPECIFICATIONS
- 29 MAINTENANCE
- 29 Seat Cleaning & Removal
- 29 Nozzle Cleaning
- 30 Replacing the Deodorizer Cartridge
- 30 Cleaning the Mesh Filter
- 31 Product Storage & Use
- 31 TROUBLESHOOTING
- 34 WARRANTY

## TRANSLATIONS

- 36 SPANISH
- 72 FRENCH

# SAFETY INFORMATION (IMPORTANT SAFEGUARDS)

Be careful to keep this safety information. Please read this information to prevent property loss and ensure safety.



## **DANGER:**

If not observed, serious injury or even death may occur as a result.



## **WARNING:**

If not observed, serious physical injury or property damage may occur as a result.



## **CAUTION:**

If not observed, minor physical injury or property damage may occur as a result.

## READ ALL INSTRUCTIONS BEFORE USING



## **DANGER**

Failure to observe the following warnings may result in electric shock, fire, personal injury, property damage or product damage:

- The remote control for this product contains a button style coin battery. If swallowed, it can cause severe injury or death in just 2 hours. Keep the remote away from children and seek medical attention immediately if suspected ingestion of the battery occurs.
- Do not use a damaged power plug or plug into a loose electric outlet.
- Do not move the product by pulling the power cord.
- Do not handle the product or power plug with wet hands.
- Do not forcefully bend the power cord or place heavy objects on it to prevent it from being damaged or deformed.
- Do not connect and pull out the power plug or cord repeatedly.
- Unplug the product before cleaning, repairing, inspecting, or replacing parts.
- Remove any dust or water from the power plug prior to plugging in.
- Do not plug the product into an electrical outlet or power strip that is being used by too many other products. Use an electrical outlet adequate for the wattage of the product rated for a minimum of 15 amps.
- If the power cord is damaged, do not attempt to repair, modify, or replace the cord yourself. Contact the Brondell Service Center toll free at 888-542-3355 or email us through our website.
- If the product produces a strange noise, a burning smell, or emits smoke, unplug it immediately from the electrical outlet and contact Brondell. Failure to do so may result in electric shock or fire.
- Do not insert any wires or sharp objects into any product gaps. This may result in electric shock, fire, or product damage.

## SAVE THESE INSTRUCTIONS

# SAFETY INFORMATION (cont.) (IMPORTANT SAFEGUARDS)

## DANGER

- Do not place an electronic or gas heater near the product or dispose of any burning materials such as a lit cigarette in the toilet. This may result in fire or product deformation. Do not place any containers filled with water or other liquids, food, metallic objects, or any flammable material on top of the product. If foreign material enters the product, this may result in electric shock or fire.
- Do not use the product in locations exposed to excessive moisture and do not splash water onto the product.
- While cleaning the bathroom, pull the power plug out of the electrical outlet and exercise caution to ensure that water or cleaning supplies do not splash onto the bidet. Failure to do so may result in electric shock or fire.
- If foreign material enters the product, pull the power plug out of the electrical outlet, turn off the main water valve, and call the Brondell Service Center.
- Do not disassemble, repair, or modify the product yourself.
- Do not use the product while wet from bathing or showering.
- Do not place or store the product where it can fall or be pulled into a tub or sink.
- Do not place in or drop the product into water or any other liquid.
- Do not reach for the product if it has fallen into water. Unplug the product immediately and call the Brondell Service Center.
- Do not use the product if it is not working properly. Please unplug the product immediately, close the main water supply valve, and call the Brondell Service Center at 888-542-3355. Failure to do so may result in electric shock, fire, or flooding.

## WARNING

Failure to observe the following warnings may result in electric shock, fire, personal injury, property damage or product damage.

- Do not plug in, operate, or store the unit in locations where flammable or combustible materials are used or kept.
- Do not use industrial water, or gray water for the supply, as this may cause skin damage or disease.
- Turn off the main water supply valve when cleaning.
- For children and seniors who may have difficulties with adjusting temperatures or those with sensitive skin or impaired heat sensitivity, set the temperature of the wash spray and seat to “low” or “off” to prevent burning.
- Close supervision is necessary when this product is used by children, seniors, or persons requiring general assistance.
- Do not press the buttons using excessive force.
- Do not stand on top of or place any heavy objects onto the seat cover.
- Use this product for its intended use only, as described in this manual. Do not use any attachments that are not recommended by Brondell.

## SAVE THESE INSTRUCTIONS

# SAFETY INFORMATION (cont.)

## (IMPORTANT SAFEGUARDS)

### WARNING

- Never operate this product if it has a damaged cord or plug, if it is not working properly, if it has been dropped or damaged, or dropped into water. Contact the Brondell Service Center for examination and repair.
- Keep the cord away from heated surfaces and heating vents.
- Never block the air openings of the product or place it on a soft surface, such as a bed or couch, where the air openings may be blocked. Keep the air openings free of lint, hair, etc.
- Never drop or insert any object into any opening or hose.
- Do not use the product outdoors or operate where aerosol (spray) products are being used or a room where it could be exposed to oxygen.
- Connect this product to a properly grounded outlet only. Refer to the Grounding Instructions in the next pages of the manual.

### CAUTION

Failure to observe the following warnings may result in electric shock, fire, personal injury, property damage, or product damage.

- For California Residents: CR2032 batteries contain Perchlorate Material - special handling may apply. Visit <http://www.dtsc.ca.gov/hazardouswaste/perchlorate> for more information.
- Do not connect the main water supply to the hot water pipe or supply (only connect to the cold water supply).
- After the installation, make sure to check all water supply connections for leaks. Rubber washers should be in place for the water connection hoses & T-Valve.
- Do not open/close the seat or seat cover with excessive force.
- Exercise caution that urine does not come into contact with the product - failure to do so may result in bad odors or malfunction.
- If the product will not be used for a long period of time, unplug the power cord, close the main water supply valve, and drain any water in the water tank.
- Do not pull out the bidet hose using excessive force.
- Do not use thinner, benzene, acidic chemicals, chloride, or hydrochloric acid detergent on or near the product. This may result in corrosion to the metal parts or discoloration or scratches to the bidet body.
- This appliance is not intended for use by persons (including children and seniors) with reduced physical, sensory, or mental capabilities, or lack of experience and knowledge, unless they have been given supervision or instruction concerning the use of the appliance by a person responsible for their safety.
- Children should be supervised to ensure that they do not play with the appliance.

## SAVE THESE INSTRUCTIONS

# SAFETY INFORMATION (cont.) (IMPORTANT SAFEGUARDS)

## GROUNDING AND GFI OUTLET INSTRUCTIONS

This product should only be used with a grounded GFCI (Ground Fault Circuit Interrupter) outlet and a grounded three-prong electrical cord as shown to the right. In the event of an electrical short circuit, using a grounded GFCI outlet reduces the risk of electric shock.

This product is equipped with a grounded cord and is for use on a nominal 120V circuit only (minimum 15 amps) and must be plugged into an outlet that is properly grounded with a GFCI breaker as shown. Replace or repair a damaged cord immediately.

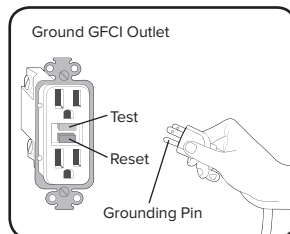

**Improper use of the grounding plug can result in a risk of electric shock.**

- If repair or replacement of the cord or plug is necessary, do not connect the grounding wire to either flat blade terminal. The wire with green insulation (either with or without a yellow stripe) is the grounding wire.
- Check with a qualified electrician if the grounding instructions are not completely understood, or if there is doubt if the product is properly grounded.

### Extension Cord Use

If it is necessary to use an extension cord, only use those rated for a minimum of 15 amps with a three-wire extension cord with a three-blade grounding plug. Only plug into a three-slot grounded GFCI receptacle that will accept the plug of the product. Replace or repair any damaged cords immediately.

# SAVE THESE INSTRUCTIONS

# PRODUCT INFORMATION

---

## S1200/1400 PRODUCT FEATURES

**Dual Stainless Steel Nozzles** – separate stainless steel nozzles resist soiling and bacterial contamination for enhanced hygiene. The dual nozzle configuration ensures accurate coverage for all types of users.

**Aerated Wash Spray** – micro-bubbles introduced into the wash spray create a gentler, softer wash action designed for sensitive skin. In addition, the aerated spray reduces overall water consumption and is more effective in washing the skin.

**Positionable Nozzles** – each nozzle has seven different positions to ensure the most comfortable and complete wash.

**Ergonomic Heated Seat** – with four temperature settings (High/Med/Low/Off).

**Night Light** – an illuminating night light means no more blinding lights during midnight trips to the bathroom.

**Sturdy, “Sittable” Lid** – the strong bidet seat lid will support up to 270 pounds.

**Gentle Closing Seat and Lid** – “slam free” gentle closing seat and lid are user friendly.

**Instant and Endless Warm Water** – the cutting-edge instant ceramic heating system ensures an endless warm water stream for posterior and feminine washes.

**Adjustable Water Temperature and Pressure** – each wash mode (Front and Rear) has four available water temperature settings, and three water pressure settings.

**Wide Spray Option** – three width settings widens the wash spray from a strong concentrated stream to a soft spray for a more personal and thorough wash.

**Wireless Remote Control** – the intuitive remote control comes with a convenient magnetic dock and mounting bracket, and includes its own Eco Mode to conserve battery life.

**Two User Memory Settings** – personalize your settings like water temperature, water pressure, and even the spray width to your own preferences and retain them with two programmable profile settings.

**“Auto” Function** – activates a preset for either a Front or Rear wash cycle. The Dry cycle will then activate with the Swash 1400. See page 22 for more details.

**Automatic Eco Mode** – this function automatically lowers the seat temperature ten minutes after the Swash was last used.

**Quick-Release Seat** – quick-release button for easy removal and cleaning of seat and toilet.



---

## S1400-ONLY PRODUCT FEATURES

**Warm Air Dryer** – includes adjustable temperature with three levels for a hands-free experience and toilet paper reduction – even elimination.

**Nozzle Oscillation** – the move function provides a massaging, oscillating cleanse during the wash cycle ensuring a thorough and comfortable wash.

**Nozzle Sterilization** – utilizing silver as a natural antibacterial agent we are able to create a sterilizing wash for the nozzles that is 100% chemical and maintenance free keeping them clean, hygienic, and corrosion free.

**Deodorizer** – the activated charcoal deodorizing filter eliminates odors at the source. It does not cover or mask odors, but eliminates them by removing air from the toilet bowl, passing it through the replaceable filter and expelling the clean air through the vent in the back of the Swash.

# PRODUCT INFORMATION (cont.)

## PRODUCT DIMENSIONS

### Elongated Top View

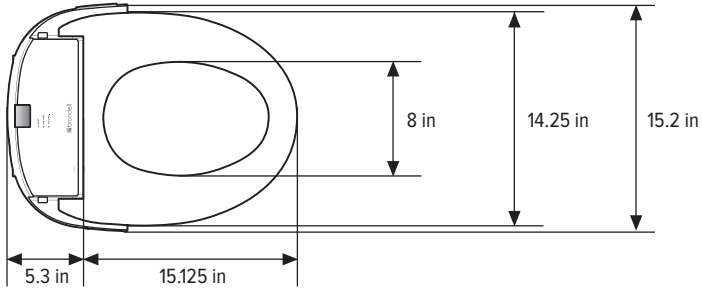

### Round Top View

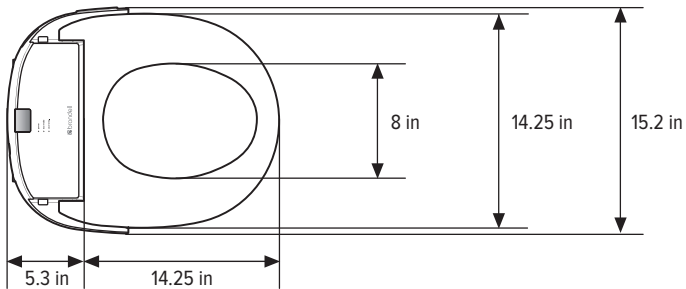

### Bottom View

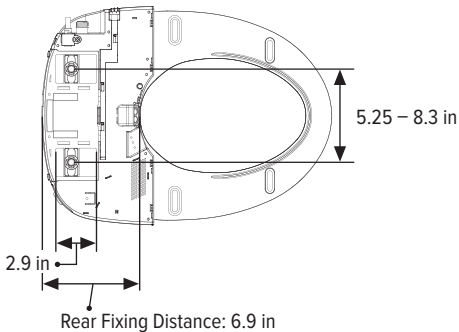

### Distance Between Mounting Holes

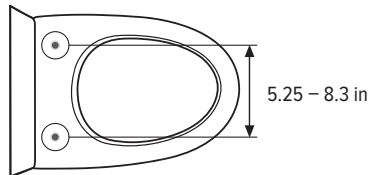

## PRODUCT PARTS

1. Lid
2. IR Sensor
3. Stainless Steel Nozzles
4. Body (seat) Sensor
5. Seat
6. Power Cord
7. Bidet Hose
8. T-Valve
9. Drain Plug
10. Water Inlet
11. Quick Release Button
12. Mounting Plate
13. Deodorizer
14. Night Light
15. Remote Control

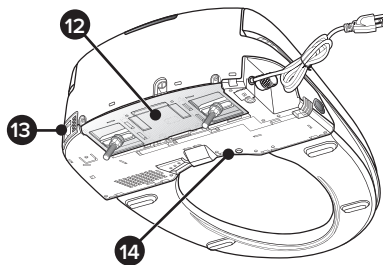
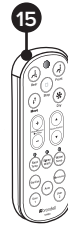
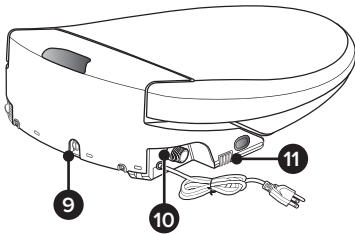
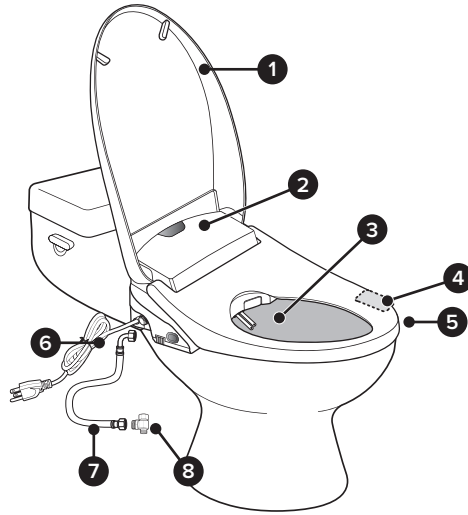

# PRODUCT INSTALLATION

## INSTALLATION PARTS

1. Mounting Bolt (2)
2. Rubber Cone Washer (2)
3. Flat Washer (2)
4. Barrel Nut (2)
5. Mounting Plate
6. Adjustable Bracket (2)
7. T-Valve Connector with Rubber Washer
8. Bidet Hose
9. Cable Clips (2)
10. Remote Control Wall Mount
11. Remote Screw (2)
12. Remote Anchor (2)
13. CR2032 Batteries (4)

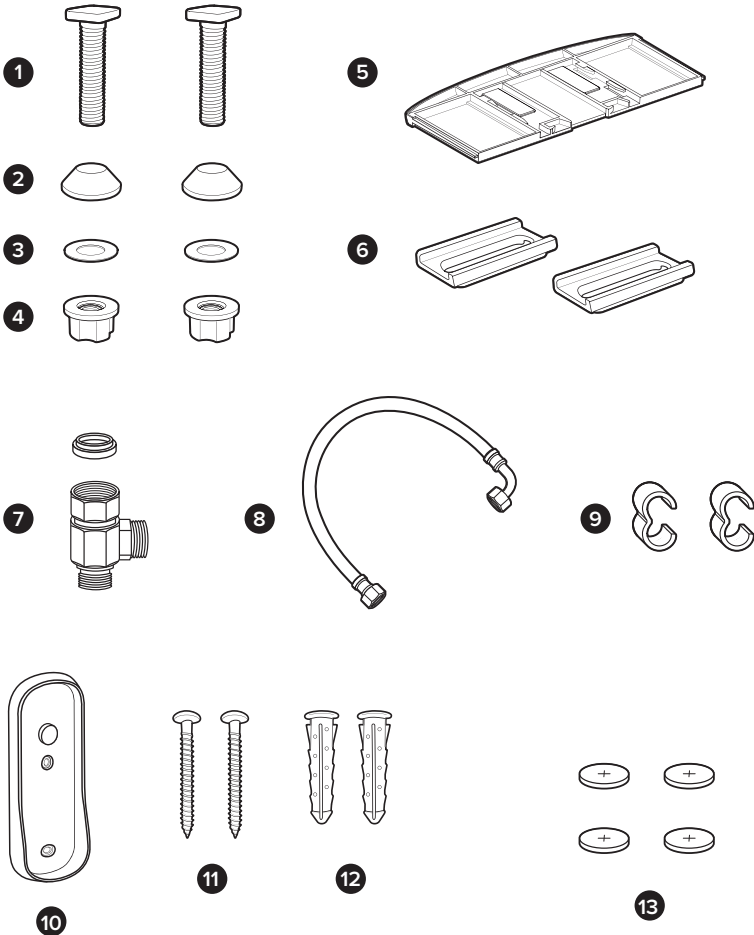

---

## BEFORE INSTALLATION

### WATCH OUR INSTALLATION VIDEO

Installation for all Swash products can be found online at [brondell.com](http://brondell.com)

### CHECK FOR TOP MOUNT INSTALLATION

If your fixture only has top-side access to the mounting bolts that hold the seat to the toilet, you will likely need to purchase the Swash Bidet Seat Top Mount Hardware Kit, found on [brondell.com](http://brondell.com).

### CHECK FOR A CONCEALED TOILET FILL VALVE

Many modern toilets have sleek designs intended to cover and camouflage plumbing connections, which makes a standard Swash installation difficult or impossible. For this, we recommend using our Alternate Swash Bidet Seat T-Valve, found on [brondell.com](http://brondell.com).

### CHECK WATER SUPPLY LINE

Check the line that connects the toilet tank to the water shut off valve. If it is a rigid pipe, you may need to purchase a flexible hose to replace it before installing the Swash. The length of the hose and the size of the connectors will vary.

### RESIDUAL MOISTURE IS NORMAL

Every product is tested with pure water during production to ensure the highest quality and performance. It is normal to find a small amount of residual moisture on the product and in the reservoir and filter.

### TOOLS

A **Phillips head or standard screwdriver** may be needed to remove the existing toilet seat and a **standard wrench** may be needed for tight water supply connections. **Teflon tape** can be helpful in creating a water-tight seat between plumbing connections.

## SWASH INSTALLATION

Please read these instructions carefully before installing the Swash. Failure to do so could result in flooding, leaking or damage to the product.

### 1. Existing Toilet Seat Removal

- a. Lift hinge covers and use a screwdriver to remove the mounting bolts.
- b. Remove the toilet seat.

**NOTE:** Steps may vary by type of seat and toilet

# PRODUCT INSTALLATION (cont.)

## SWASH INSTALLATION (cont.)

2. Turn Off Water Supply Valve and Flush Toilet
  - a. Turn water valve off to stop the flow of water.
  - b. Flush toilet and hold down handle to completely empty tank.
  - c. Disconnect water supply hose from toilet tank. Do not disconnect from the water supply valve.

### NOTES:

- You may wish to place a container under the tank to catch any excess water.
- Do not continue without completing the above steps
- Failure to do so could result in flooding, leaking or damage to the Swash.

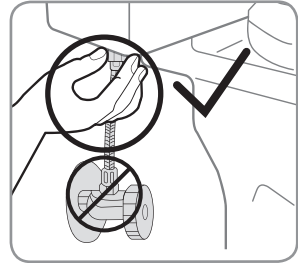

Step 2c

3. Connect T-Valve to the Toilet Tank Fill Valve
  - a. Place the flat edge of the rubber washer into the T-Valve against the metal with the raised lip facing the toilet tank connection.
  - b. Install the T-Valve with the rubber washer to the incoming water connection on the bottom of your toilet tank.

### NOTES:

- The T-Valve connects to the fill valve directly under your toilet tank - it does not connect at the wall.
- Only connect to the cold toilet water supply line.
- If your water supply line is rigid you may need to replace it before continuing.

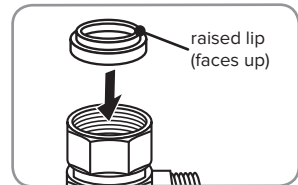

Step 3a

4. Connect the water supply line coming from the wall to the bottom of the T-Valve.

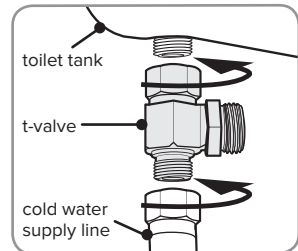

Steps 3-4

5. Install Mounting Plate
  - a. Place adjustable mounting plate over mounting holes on toilet, rubber side faces down, curved edge faces toward the toilet tank.
  - b. Place adjustable brackets flat side down in the center of the square opening in the mounting plate and insert mounting bolts through adjustable brackets and mounting holes. Be sure that the square mounting bolt head is even with sides of adjustable bracket.
  - c. Slide rubber cone washer, flat washer, and then barrel nut onto mounting bolts under the toilet bowl and tighten to keep mounting plate in place.

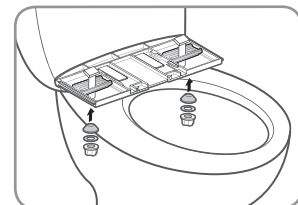

Steps 5b & 5c

## SWASH INSTALLATION (cont.)

6. Connect the Bidet Hose to the Seat
  - a. Connect the bidet hose to the water inlet. Hand-tighten to secure. Take care not to twist the bidet hose, excessively bend it, or strip the plastic screw threads when screwing the hose onto the bidet seat.
7. Attach the Swash to the Mounting Plate
  - a. Set the Swash flat on the toilet bowl in front of the mounting plate, and slide seat onto plate until it is secure and “clicks” into place.
  - b. If the seat appears too short or too long for the toilet, adjust the mounting plate accordingly. To adjust the mounting plate, loosen barrel nuts underneath the toilet and slide seat forward or backwards as needed. Once the seat is lined up properly, tighten barrel nuts to hold in place.
8. Connect the open end of the Bidet Hose to the T-Valve.
9. Turn On Water Supply
  - a. Open the main water supply valve slowly and check for leaks.
  - b. Wait 5 minutes, check again and if there are no leaks continue.
10. Connect Power
  - a. Plug the power cord into the electrical outlet.
  - b. If desired, use the included Cable Clips to connect the power cord and bidet hose side-by-side for a tidier appearance.

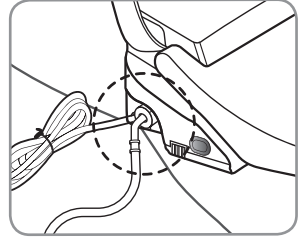

Step 6a

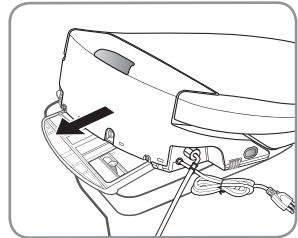

Step 7b

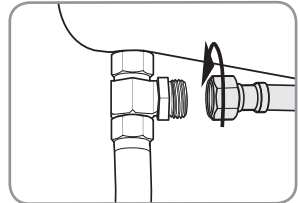

Step 8

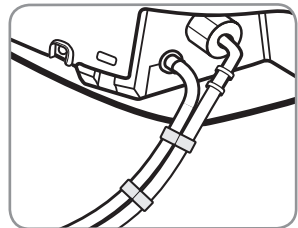

Step 10b

### NOTES:

- Make sure to only use a grounded GFCI (ground fault circuit interrupter) electrical outlet. In the case of a short circuit, a grounded GFCI outlet may help prevent electric shock or injury.
- If it is necessary to use an extension cord, only use those rated for a minimum of 15 amps with a three-wire extension cord with a three-blade grounding plug.

# PRODUCT INSTALLATION (cont.)

## REMOTE CONTROL INSTALLATION

### 1. Battery Installation

- Separate the remote control from the magnetic dock.
- Turn remote over and open the child-proof battery compartment by popping off the battery cover with a flat-head screwdriver or small coin. Insert the four included CR2032 batteries “plus” side up and replace battery cover.
- To confirm the batteries are installed correctly, press the Stop button and you should see the “Wide Spray” LED light turn on for a few seconds (NOTE: the 2 other LED lights may or may not turn on at this time depending on the current settings).

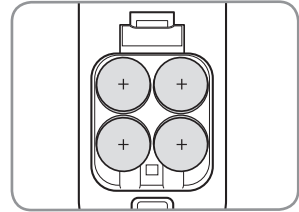

Step 1b

### 2. Mount Remote (optional)

- Identify a location in the bathroom for the remote control that is visible and reachable from the toilet.
- Depending on the wall type, you can install using the supplied screws and anchor mounts or use the provided double stick tape on the back of the remote wall mount.

Make sure the remote mount is fully secure with either method so that it does not fall and damage the remote control.

- Place the remote control into the mount as shown.

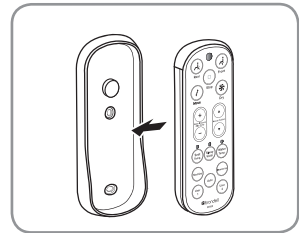

Step 2c



#### **DANGER – Important Battery Information:**

- Remote contains “coin-style” batteries – keep away from children. If swallowed, seek medical attention immediately.
- Ingestion of batteries may cause severe injury or death in just 2 hours.
- Use only CR2032 batteries. Do not mix new and old batteries together.
- Double-check the + and – direction.
- Take care when opening the battery compartment to replace the batteries - the batteries are spring-loaded.
- Dispose of old batteries carefully.



For California Residents: CR2032 batteries contain Perchlorate Material - special handling may apply. Visit <http://www.dtsc.ca.gov/hazardouswaste/perchlorate> for more information.



## EXTERNAL BIDET FILTER INSTALLATION

### NOTE:

- Customers with hard water, well water, and softened water can extend the life of their bidet seat by purchasing and installing an external inline water filter to be used with the Swash. The bidet filter should be changed every six months.

1. Turn Off Water Supply Valve and Flush Toilet.
  - a. Turn water valve off to stop the flow of water.
  - b. Flush toilet and hold down handle to completely empty tank.
2. Disconnect the Bidet Hose from the T-Valve
3. Connect the female end of the Swash Filter to the Open T-Valve Connection.
4. Connect the Bidet Hose to the male end of the Swash Filter.
5. Turn the toilet water supply valve back on.

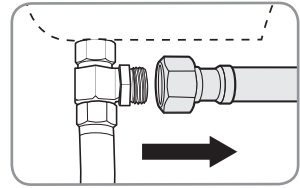

Step 2

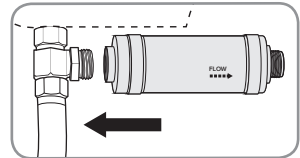

Step 3

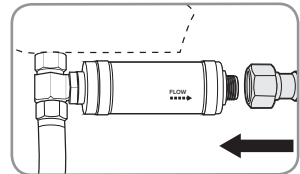

Step 4

# OPERATING THE SWASH

## QUICK REFERENCE GUIDE – S1200 REMOTE CONTROL

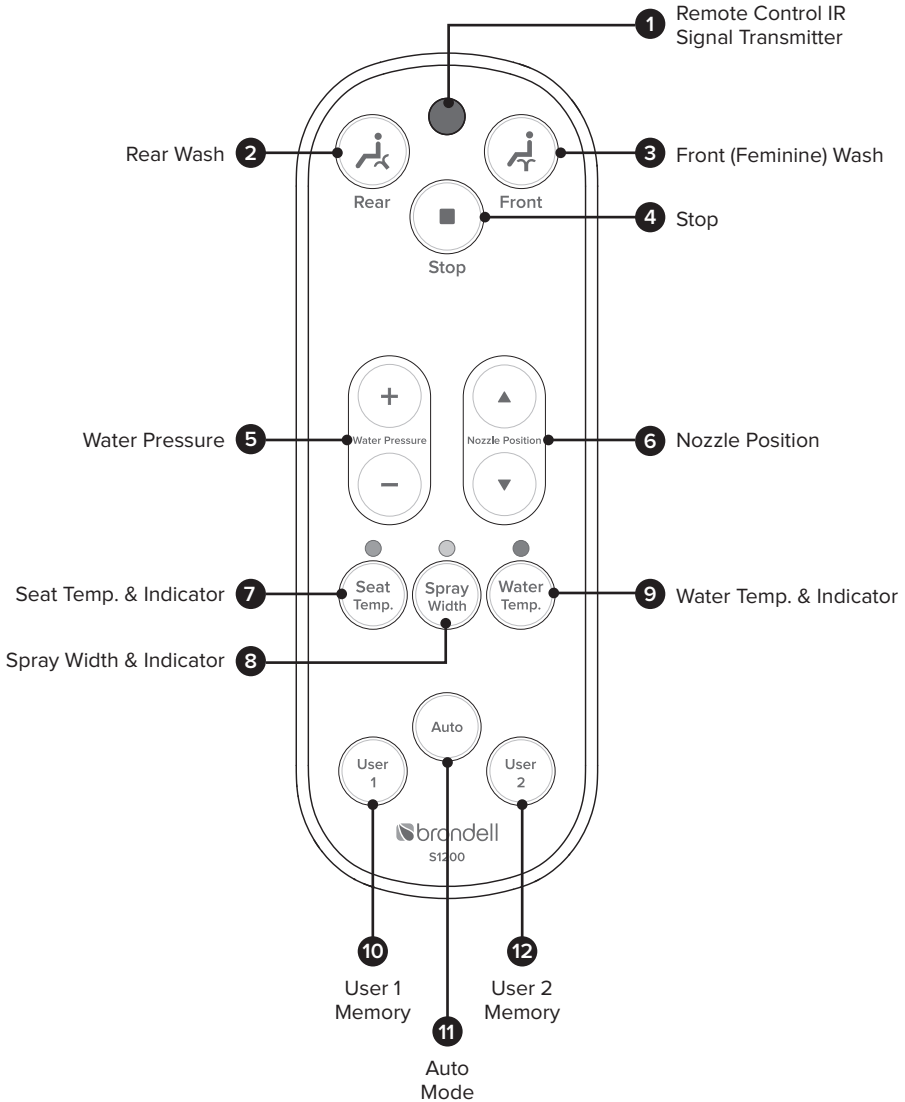

---

## QUICK REFERENCE GUIDE – S1200 REMOTE CONTROL (cont.)

### SEE DIAGRAM ON PAGE 16

#### 1. Remote IR Signal Transmitter

Transmits the signal from remote control to the seat when a button is pressed.

#### 2. Rear Wash Button

This button activates the aerated Rear Wash function.

#### 3. Front (Feminine) Wash Button

This button activates the aerated Front, or “Feminine”, Wash function.

#### 4. Stop Button

Stops all functions currently operating.

#### 5. Water Pressure Buttons

These buttons increase or decrease the water pressure, to one of three settings, during either of the aerated wash cycles.

#### 6. Nozzle Position Buttons

These buttons move the wash nozzle, to one of seven positions, during either of the aerated wash cycles.

#### 7. Seat Temp. & Indicator

Indicates the Seat Temperature setting. Press the button to cycle through each setting.

*Off, Low - 89° F (blue), Medium - 93° F (pink), High - 97° F (red)*

#### 8. Spray Width & Indicator

Indicates the wash Spray Width setting. Press the button to cycle through each setting.

*Concentrated (blue), Medium (pink), and Wide (red)*

#### 9. Water Temp. & Indicator

Indicates the Water Temperature setting. Press the button to cycle through each setting.

*Off - incoming water temp., Low - 90° F (blue), Medium - 95° F (pink), High - 100° F (red)*

#### 10. User Memory 1

This button contains the programming for all of the customizations set in User 1's wash cycles. See page 23 for more details.

#### 11. Auto Mode

This button automatically runs a pre-programmed wash (front or rear) cycle. See page 22 for more details.

#### 12. User Memory 2

This button contains the programming for all of the customizations set in User 2's wash cycles. See page 23 for more details.

# OPERATING THE SWASH (cont.)

## QUICK REFERENCE GUIDE – S1400 REMOTE CONTROL

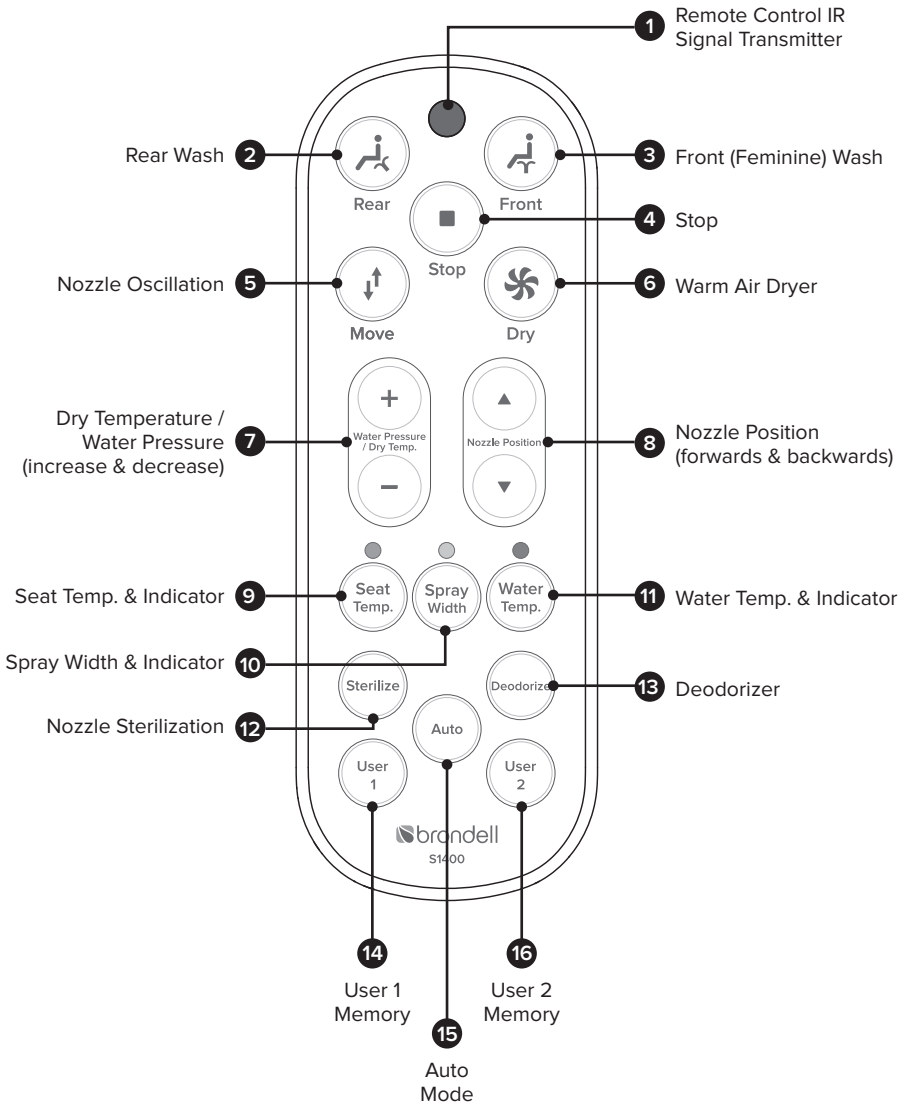

---

## QUICK REFERENCE GUIDE – S1400 REMOTE CONTROL (cont.)

### SEE DIAGRAM ON PAGE 18

#### 1. Remote IR Signal Transmitter

Transmits the signal from remote control to the seat when a button is pressed.

#### 2. Rear Wash Button

This button activates the aerated Rear Wash function.

#### 3. Front (Feminine) Wash Button

This button activates the aerated Front, or “Feminine”, Wash function.

#### 4. Stop Button

Stops all functions currently operating.

#### 5. Nozzle Oscillation (Move) Button

This button activates the Nozzle Oscillation function. When activated, the front or rear nozzle moves back and forth during the wash cycle to clean a wider area. Push the button again to stop the oscillation.

#### 6. Dry Button

Turns on the Warm Air Dryer for a period of two minutes.

#### 7. Water Pressure/Dry Temperature Buttons

These buttons increase or decrease the water pressure, to one of three settings, during either of the aerated wash cycles. During the Dry cycle, these buttons increase or decrease the temperature of the Warm Air Dryer.

#### 8. Nozzle Position Buttons

These buttons move the wash nozzle, to one of seven positions, during either of the wash cycles.

#### 9. Water Temp. & Indicator

Indicates the Water Temperature setting. Press the button to cycle through each setting.

*Off - incoming water temp., Low - 90° F (blue), Medium - 95° F (pink), High - 100° F (red)*

#### 10. Spray Width & Indicator

Indicates the wash Spray Width setting. Press the button to cycle through each setting.

*Concentrated (blue), Medium (pink), and Wide (red)*

#### 11. Seat Temp. & Indicator

Indicates the Seat Temperature setting. Press the button to cycle through each setting.

*Off, Low - 89° F (blue), Medium - 93° F (pink), High - 97° F (red)*

#### 12. Nozzle Sterilizer

Utilizing silver as a natural antibacterial agent, this sterilizing wash is 100% chemical and maintenance-free, keeping the nozzles clean, hygienic, and corrosion-free.

#### 13. Deodorizer

Eliminates odors by removing air from the toilet bowl, passing it through the replaceable active carbon filter, and expelling the clean air through the vent in the back of the Swash.

#### 14. User Memory 1

This button contains the programming for all of the customizations set in User 1's wash and dry cycles. See page 23 for more details.

#### 15. Auto Memory

This button automatically runs a pre-programmed wash (front or rear) and dry cycle. See page 22 for more details.

#### 16. User Memory 2

This button contains the programming for all of the customizations set in User 2's wash and dry cycles. See page 23 for more details.

# OPERATING THE SWASH (cont.)

## BIDET SEAT CONTROLS GUIDE

Basic functions such as Rear Cleansing and Nozzle Cleaning can be used without the remote by utilizing the auxiliary buttons shown below.

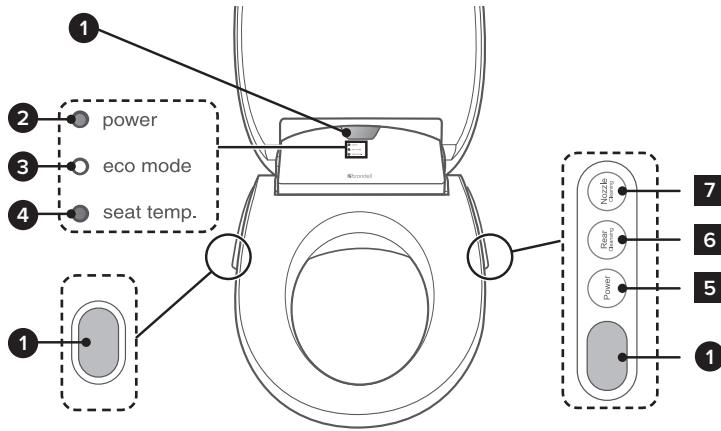

### SEAT DISPLAY

#### 1. Remote IR Receiver (3)

Receives signal from remote control.

#### 2. Power Indicator

This indicator is illuminated when the bidet is powered on.

This indicator is turned off when Eco Mode is activated.

#### 3. Eco Mode Indicator

This indicator is illuminated when Eco Mode is enabled and activated, ten minutes after the Swash was last used or programmed.

#### 4. Seat Temperature Indicator

This indicator is illuminated when the seat temperature is set to Low, Medium, or High.

The indicator is turned off when the seat temperature is off. This indicator is also turned off when Eco Mode is activated.

### AUXILIARY CONTROL PANEL

#### 5. Power Button

Turns the seat On/Off. Press and hold the button for 2 seconds to turn off.

If the Power button is pressed while any wash function is operating, the wash function will stop.

#### 6. Rear Cleansing Button

Initiates the rear wash function utilizing the settings last used.

#### 7. Nozzle Cleaning Button

When pressed, one nozzle will fully extend, allowing for easy cleaning. Press again for the second nozzle to extend and once more to retract both nozzles.

---

## USING THE SWASH 1200/1400

### NOTES:

- The wash functions will not work unless the sensor in the seat detects someone sitting down (skin conductivity sensor). To override the Seat Sensor, please refer to the section on page 27.
- The remote control will not operate the Swash if the batteries are weak, dead, or not installed properly (remote requires 4 x CR2032 batteries to function).

### Warm Water Aerated Wash

1. Sit on the seat to ensure skin-to-seat contact. The seat will give an audible response letting you know the seat sensor has been engaged. At the same time an automatic self-cleaning cycle will occur - a small amount of water will flush over the nozzles and into the toilet bowl.
2. Press the Front or Rear button on the remote to begin water flow. The nozzles will self-clean and purge a small amount of water which will last for several seconds prior to starting the wash function – please note that this may take up to 20 seconds. The front or rear wand will extend and wash for 2 minutes, then turn off automatically.
3. To keep the wash continuing longer than 2 minutes, press the Front or Rear button again during the wash cycle. Each time you press the button during the wash cycle, the 2 minute cycle starts again.
4. If you would like to stop the wash before the 2 minute cycle ends, press the Stop button to discontinue flow.
5. While washing, users can adjust the water temperature, water pressure, spray width, and nozzle position according to their preferences.
5. After the wash cycle, the nozzles will perform a self clean cycle purging water for approximately 5 seconds.

### NOTE:

- You cannot increase the water pressure level to higher than level 2 under the following conditions: Main water supply temperature is under 50° F or if the rated power source is under 110V.

### Nozzle Positioning

While the wash function is operating, use the Nozzle Position up and down arrows on the remote control to move the position of the nozzles and spray. Each nozzle has seven positions.

### Water Pressure Adjustment

While the wash function is operating, press the Water Pressure “+” and “-“ buttons on the remote control to increase or decrease the water pressure of the spray. There are three water pressure levels: Low – Med – High.

# OPERATING THE SWASH (cont.)

## USING THE SWASH 1200/1400 (cont.)

### Wide Spray

To adjust the spray width of the washing stream during a wash cycle, press the Wide Spray button. The Wide Spray button has three levels indicated by the Wide Spray Indicator Light on the remote control:

*Concentrated Stream (blue), Medium Stream (pink), Wide Stream (red)*

Increasing the spray width to the Medium and Wide settings will also decrease the spray pressure.

### Adjusting Water Temperature

Press the Water Temp. button to adjust temperature to desired level. There are four temperature levels indicated by the Seat Temp. Indicator light on the remote:

*Off - incoming water temp., Low - 90° F (blue), Medium - 95° F (pink), High - 100° F (red)*

### Adjusting Seat Temperature

Press the Seat Temp. button to adjust the seat temperature to desired level. There are four temperature levels indicated by the Seat Temp. Indicator light on the remote:

*Off, Low - 89° F (blue), Medium - 93° F (pink), High - 97° F (red)*

### Auto Function

The Auto Function will run a preset wash and dry cycle\* with a simple press or hold of the "Auto" button.

Pressing the Auto button will initiate a rear wash cycle for 90 seconds at the medium (pink) water temperature. The water pressure will be set to high and the spray width will be on the medium (pink) setting. The oscillate function will start as soon as the wash cycle starts. The Swash will automatically start the Air Dryer\* and run a dry cycle\* for 2 minutes immediately after the wash cycle. The Dryer temperature\* will be set to medium.

Press and hold the "Auto" button for 5 seconds to initiate a Front Wash cycle for 90 seconds at the medium (pink) water temperature. The water pressure will be set to high and the spray width will be on the medium (pink) setting. The oscillate function will start as soon as the wash cycle starts. The Swash will automatically start the Air Dryer\* and run a dry cycle\* for 2 minutes immediately after the wash cycle. The Dryer temperature\* will be set to medium.

Press Stop on the remote anytime during the wash or dry cycle\* to stop the Auto Function.

In "Auto" mode, the seat temperature will be unchanged; it will be set to whatever the last seat temperature setting was. The deodorizer will not turn on during the Auto Function.

#### NOTE:

- The Warm Air Dryer is only available on the Swash 1400 model



---

## USING THE SWASH 1200/1400 (cont.)

### User Memory Setting

The Swash User 1 and User 2 memory function allows you to program your preferred wash settings for a Front and Rear wash cycle for two users. These settings include: Water Temperature Level, Spray Width Level, Water Pressure Level, Nozzle Position, and Nozzle Oscillation\*. Follow the steps below to program and use the Memory Function.

\*only available on the Swash 1400 model

#### *Programming User 1 or User 2 Memory Function*

1. Sit on the seat. The seat will give an audible response letting you know that the seat sensor has been engaged (unless "Silent Mode" has been set to On). At the same time, a small amount of water will flush over the nozzle, performing an automatic self-cleaning cycle.
2. To program Front nozzle settings, press and release the Front button. To program Rear nozzle settings, press and release the Rear button. A wash cycle will commence.
  - a. While the wash is operating, set your desired Water Temperature Level, Spray Width Setting, Water Pressure Level, Nozzle Position, and Oscillation option.\*
  - b. Let the wash cycle run the full two minutes or press the Stop button at any time.
3. If desired, initiate another wash cycle using the opposite nozzle.
  - a. While the wash is operating, set your desired Water Temperature Level, Spray Width Setting, Water Pressure Level, Nozzle Position, and Oscillation option.\*
  - b. Let the wash cycle run the full two minutes or press the Stop button at any time.
4. Press and hold the User 1 or User 2 button on the remote for five (5) seconds to save the programming. You should hear an audible beep when the settings are programmed.

**Continued on next page...**

# OPERATING THE SWASH (cont.)

---

## USING THE SWASH 1200/1400 (cont.)

### User Memory Setting (cont.)

#### *Using the User 1 or User 2 Memory Function*

1. Sit on the seat. The seat will give an audible response letting you know that the seat sensor has been engaged (unless "Silent Mode" has been set to On). At the same time, a small amount of water will flush over the nozzle, performing an automatic self-cleaning cycle.
2. Press the User 1 or User 2 button followed by the Front or Rear button, depending on which wash cycle was programmed. You will hear an audible tone if you select a wash cycle that has not been programmed.
3. The nozzles will self-clean and purge a small amount of water which will last for several seconds prior to starting the programmed wash function. The Water Temperature Level, Spray Width Level, Nozzle Position, Water Pressure Level, and Oscillation function will be set to the programmed settings. The wash cycle will run for 2 minutes and shut off automatically.
4. To keep the wash continuing longer than 2 minutes, press the Front or Rear button again during the wash cycle. Each time you press the button during the wash cycle, the 2 minute wash cycle will start over again.
5. If you would like to stop the wash before the 2 minute cycle ends, press the Stop button.

#### **IMPORTANT NOTES REGARDING USER MEMORY SETTINGS:**

- After pushing the User 1 or User 2 button you have 5 minutes before the memory function is cancelled.
- If the seat sensor is de-activated at any time after pushing the User 1 or User 2 button, the memory setting function will be cancelled.
- When you use the User 1 or User 2 memory settings, the LED indicator lights on the remote may not reflect your saved preferences, but your programmed Front and Rear wash settings will be accurate and correct.
- After programing both nozzles for a User, if you decide to change the programing of one nozzle, you must reprogram both nozzles.

### Auxiliary Controls

1. Power button – Turns the product On/Off. Press and hold the button for at least 2 seconds to turn off the Swash.

#### **NOTE:**

- If the Power button is pressed while front or rear wash is operating, the wash function will stop.

2. Rear Cleansing – Selects the rear wash function.
3. Nozzle Cleaning – To better clean the nozzles, press this button, the nozzle will extend fully for easy cleaning. Refer to Maintenance section for additional nozzle cleaning information.

---

## USING THE SWASH 1400's ADDITIONAL FEATURES

### **Nozzle Oscillation (Move) Function**

While the wash function is operating, press the Move button on the remote control to start or stop the nozzle oscillation function (moving back and forth). This provides a wider range of wash spray.

### **Warm Air Dryer Function**

Once the wash cycle is complete, press the Dry button to activate the warm air dryer. The dryer will run for two minutes. To keep the dryer running longer than two minutes, press the DRY button again during the drying cycle to add another two minutes. If you would like to stop the dryer before the two minutes has elapsed, press Stop.

While the air dryer is operating press the Water Pressure / Dry Temp "+" and "-" to adjust the dryer temperature to a comfortable level. There are four settings: Off - Low - Medium - High.

NOTE: the Seat Sensor must be activated in order for this function to work, unless the Seat Sensor has been cancelled (see page 27 for details).

### **Deodorization**

To activate the deodorizer, press the Deodorize button on the remote control. The deodorizer will run for one minute. To stop the deodorizer prior to completion of the cycle, press Stop.

### **Nozzle Sterilization**

To sterilize the stainless steel nozzles, press the Sterilize button on the remote control. A cleansing silver oxide nano-particle water treatment will commence. The cleansing spray will last for 60 seconds while the nozzles extend and retract. To stop the nozzle sterilization prior to completion of the cycle, press Stop.

The Silver oxide nano-particle treatment system has powerful anti-fungal and anti-bacterial properties to keep the nozzles clean and corrosion-free. Use the sterilizing feature as often and frequently as you like. The nano-particles will never lose effectiveness and never require replacing, lasting the life of the bidet.

# OPERATING THE SWASH (cont.)

## SWASH SPECIAL MODE OPERATIONS

### NOTE:

- Special Mode Operations can be changed following the instructions below using the Auxiliary Controls on the side of the bidet (see pages 20 and 24).

### Selecting/Canceling Eco Mode

When the Eco Mode function is selected, the Swash will go into Eco Mode when the Seat Sensor is not activated and no buttons on the Remote have been active for approximately 10 minutes. The seat heater will automatically set itself to the Low temperature setting to reduce power consumption. Once Eco Mode is activated, the Eco Mode light on the seat will turn green and the other lights will turn off.

Eco Mode is cancelled at the factory by default.

1. Press and hold down the Power and Rear Cleansing auxiliary buttons simultaneously for approximately 5 seconds until one or more of the seat display lights start flashing. Release the buttons.  
NOTE: If the nightlight is turned on, it will also flash.
2. Press the Rear Cleansing button to Set or Cancel Eco Mode.
  - a. If the Eco Mode indicator light is flashing, this indicates Eco Mode has been set.
  - b. If the Eco Mode indicator light is not flashing, this indicates Eco Mode has been cancelled.
3. The new setting will automatically be saved within 10 seconds if no other buttons are pressed, or if you press the Stop button on the remote control.

### Selecting/Canceling Silent Mode

By default, the Swash will beep to confirm commands from the remote control. Follow the steps below to deactivate the beeping sounds.

1. Press and hold down the Power and Rear Cleansing auxiliary buttons simultaneously for approximately 5 seconds until one or more of the seat display lights start flashing. Release the buttons.  
NOTE: If the nightlight is turned on, it will also flash.
2. Press the Power button to Set or Cancel silent mode.
  - a. If the Power indicator light is flashing, this indicates Silent Mode has been set. There will not be any beeping sounds when buttons on the Remote Control are pressed.
  - b. If Power indicator light is turned off, this indicates the Silent Mode has been canceled. Beeping sounds when buttons on the Remote Control are pressed will resume.
3. The new setting will automatically be saved within 10 seconds if no other buttons are pressed, or if you press the Stop button on the remote control.

---

## SWASH SPECIAL MODE OPERATIONS (cont.)

### Selecting/Canceling Seat Sensor Lock Mode

This function bypasses the body sensor located in the seat and allows the wash functions and dry functions to operate without the sensor being engaged. Use caution in this mode.

Seat Sensor Lock Mode is selected at the factory by default.

1. Press and hold down the Power and Rear Cleansing auxiliary buttons simultaneously for approximately 5 seconds until one or more of the seat display lights start flashing. Release the buttons.

NOTE: If the nightlight is turned on, it will also flash.

2. Press the Nozzle Cleansing button to Set or Cancel Seat Sensor Lock Mode.
  - a. If the Seat Temperature indicator light is flashing, this indicates that the Seat Sensor Lock Mode has been set. Someone will need to be sitting on the seat for the unit to operate.
  - b. If the Seat Temp indicator light is not flashing, this indicates that the Seat Sensor Lock Mode has been cancelled. Someone does not need to be sitting on the seat for the unit to operate. Use caution.
3. The new setting will automatically be saved within 10 seconds if no other buttons are pressed, or if you press the Stop button on the remote control.

### Illuminating/Exstinguishing the Night Light

By default, the night light on the Swash will be constantly illuminated. Follow the steps below to turn the night light off.

1. Press and hold down the Power and Rear Cleansing auxiliary buttons simultaneously for approximately 5 seconds until all the seat display lights start flashing. If the nightlight is turned on, it will also flash. Release the buttons.
2. Press the Rear Cleansing button and Nozzle Cleansing buttons simultaneously to Set or Cancel the Nightlight.
  - a. If the Nightlight light is flashing, this indicates that the Nightlight has been set.
  - b. If the Nightlight light is not flashing, this indicates that the Nightlight has been cancelled.
3. The new setting will automatically be saved within 10 seconds if no other buttons are pressed, or if you press the Stop button on the remote control.

### ID Settings

The Swash 1200 and 1400 has the ability to pair a remote to a specific Swash seat. This is helpful in cases where there is more than one toilet in the bathroom. For more information on how to pair a remote to a Swash, please contact Brondell customer service.

# PRODUCT SPECIFICATIONS

BRONDELL SWASH ADVANCED BIDET SEAT	
Model	S1200-EW, S1200-RW, S1400-EW, S1400-RW, S1400-EB, S1400-RB
Power Voltage	120 V, 60 Hz
Power Consumption	1200 W
Supply Water Pressure	14.5 psi – 100 psi
Dimensions	Elongated: 15.2 in x 20.43 in x 5.75 in Round: 15.2 in x 19.75 in x 5.75 in
Weight	Elongated: 14.3 lbs / Round: 13.2 lbs
Remote Control Dimensions	2.17 in x 6.1 in x 0.8 in with Holster: 2.58 in x 6.5 in x 0.9 in
Seat / Lid Weight Limit	330 lbs / 270lbs.
Operating Temperature	32° F – 104° F
Mesh Filter	0.74 in x 0.5 in diameter

WARM WATER WASHING DEVICE	
Rear Wash	Maximum 0.13 gal per minute, automatic nozzle self-cleaning
Front Wash	Maximum 0.13 gal per minute, automatic nozzle self-cleaning
Standard Time	Rear Wash: 2 minutes / Front Wash: 2 minutes
Water Pressure Control	3 Levels
Water Temperature Control	4 Levels: Off - incoming water temperature, Low - 90° F, Medium - 95° F, High - 100° F
Heater Power Consumption	1200W
Safety Devices	Bimetal, temperature sensor, temperature fuse (overheating prevention)

HEATED SEAT	
Seat Temperature Control	4 Levels: Off - room temperature Low - 89° F, Medium - 93° F, High - 97° F
Heater Power Consumption	50 W
Safety Devices	Bimetal, temperature sensor

**NOTE:**

The specifications listed above are subject to change without prior notice for reasons of improving the product performance.

# MAINTENANCE

## SEAT CLEANING & REMOVAL



Unplug the Swash from the power source before cleaning or removing the seat.

Use a soft, damp cloth and mild cleanser (such as dish soap, Simple Green or Windex) to wipe down the seat. **DO NOT** scrub or use harsh, abrasive products to clean the Swash. **DO NOT** use thinner, benzene, acidic chemicals, chloride, or hydrochloric acid detergent. This may result in corrosion to the metal parts or discoloration or scratches to the bidet body.

For a more thorough cleaning, you may remove the Swash. To remove the seat, press the Quick Release button (#11 on Page 9) and slide the seat forward off of the mounting plate and toilet.

### NOTE:

- Be cautious of leaving home and beauty products in contact with the bidet seat, the result of which can be irreversible discoloration. Most stains can be removed using a 1:1 mix of rubbing alcohol and water and a soft cloth or towel. However, some permanent stains are the result of substances left on the seat while the seat heater was activated. Be cautious of home and beauty products (including but not limited to various hair and air freshener sprays, lotions, body wash, skin tanners, body butters, and oils) that come in contact with the seat. Wash off any substances that come in contact with the seat as soon as possible. If necessary, replacement seat parts can be purchased through Brondell customer support.

## NOZZLE CLEANING

1. Press the Nozzle Cleaning button on the Auxiliary Control panel on the side of the Swash. The front wash nozzle will fully extend. Gently clean the nozzle with a soft cloth or toothbrush.
2. Press Nozzle Cleaning button again and the front wash nozzle will retract and rear wash nozzle will fully extend. Gently clean the nozzle with a soft cloth or toothbrush.
3. Press Nozzle Cleaning button a third time and the rear nozzle will retract back into the seat. Take care when cleaning the nozzles not to apply too much pressure to avoid damaging the nozzle system.

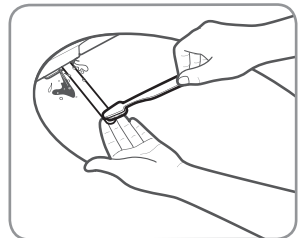

Step 1

# MAINTENANCE (cont.)

## REPLACING THE DEODORIZER CARTRIDGE

Replacement Deodorizer Cartridges are available for purchase at [brondell.com](http://brondell.com).

1. Locate the Deodorizer Compartment at the rear of the Swash. It is on the right-hand side, if you are facing the toilet.
2. Pull the tab that extends from the compartment until the compartment is completely removed from the Swash.
3. Pull the old Deodorizer Cartridge out from the compartment and replace it with the new one.
4. Push the Deodorizer Compartment back into the back of the Swash.

## CLEANING THE MESH FILTER

Cleaning intervals will differ depending on use and water quality. It is recommended to check the filter at least once a year.

1. Turn off the water supply and hold the toilet's flush lever down until all of the water has drained from the tank.
2. Unplug the Swash, remove the seat from the toilet using the Quick Release button on the left side of the unit (see diagram on page 9), and disconnect the bidet hose. You may want to use a bucket to catch any dripping water from the bidet hose.
3. Remove the Mesh Filter from the water inlet with a pair of tweezers or needle-nosed pliers.
3. Clean the filter with a toothbrush while running under tap water to effectively remove any foreign substances or build-up.
4. Replace the Mesh Filter and carefully check that it is installed correctly. If improperly installed, it could result in the product leaking water.
5. Reconnect the bidet hose and place the seat back on the toilet. Plug the cord back in, and turn the water supply back on.

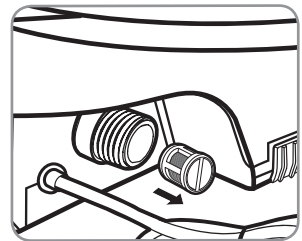

Step 3



---

## PRODUCT STORAGE & USE

### Short Term Non-Use

If the product will not be used for more than a few weeks, you can simply unplug it. You may also consider shutting the water supply off at the wall for extra precaution.

### Long Term Non-Use

If the product will not be used for an extended time (longer than four months), you should unplug the unit, shut the water supply off at the wall, remove the Swash from the toilet, and then drain the Hot Water Heater. To drain the Hot Water Heater, remove the drain plug and the back of the bidet seat by turning it counterclockwise by 90 degrees (Image “1”) and then pulling it forward (Image “2”) so that any residual water drains out.

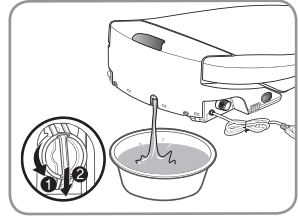

---

## TROUBLESHOOTING

If the bidet appears to be operating abnormally, please review the troubleshooting tips before calling the Brondell Service Center as most issues are easily resolved with a few simple steps. If you are unable to resolve the issue after checking the following items, please call the Service Center at 888-542-3355, Mon–Fri, 9am–5pm PST, or email us at [support@brondell.com](mailto:support@brondell.com).

### Check before continuing:

- Make sure the Swash is connected to power and that the outlet is working properly.
- Make sure you check & test the reset button on the GFCI outlet (Standard 120V GFCI outlet).
- Make sure the Remote Control has fresh batteries and they are installed correctly
- Make sure main water supply valve is open.
- Make sure the seat is not in Eco Mode.
- Confirm there are no leaks from hoses or water supply.
- Make sure Mesh Filter is clean and free of build up or debris (see maintenance section).

After checking items above, refer to the following troubleshooting chart for additional solutions

# TROUBLESHOOTING (cont.)

Problem	Possible Cause(s)	Solution(s)
The bidet seat is not working	<ol style="list-style-type: none"> <li>1. Bidet not plugged in</li> <li>2. No power to Swash</li> <li>3. There is power, but nothing happens when trying to use the Swash</li> <li>4. The incoming water is too hot</li> <li>5. Not activating Seat Sensor</li> </ol>	<ol style="list-style-type: none"> <li>1. Make sure the bidet is plugged in.</li> <li>2. Check and reset GFCI outlet.</li> <li>3. The Remote Control batteries may be dead. Replace them if necessary.</li> <li>4. Ensure that the bidet seat is connected to the cold water supply.</li> <li>5. Adjust sitting position to fully cover the Seat Sensor. Override the Seat Sensor (refer to special mode operation section to unlock Seat Sensor).</li> </ol>
Product shuts off during use	<ol style="list-style-type: none"> <li>1. Washing time exceeded the cycle time</li> <li>2. Power failure</li> <li>3. Water supply too hot</li> </ol>	<ol style="list-style-type: none"> <li>1. Press the wash button during cycle to extend the time (see operation section for more information about wash functions).</li> <li>2. Check and reset GFCI outlet.</li> <li>3. Ensure that the Swash is connected to the cold water supply only.</li> </ol>
Low water flow or spray pressure	<ol style="list-style-type: none"> <li>1. Clogged filter</li> <li>2. Water supply valve not opened fully</li> <li>3. Nozzles dirty</li> <li>4. External bidet filter</li> <li>5. Pressure &amp; wide spray settings</li> </ol>	<ol style="list-style-type: none"> <li>1. Remove, clean, and reinstall mesh filter (see maintenance section).</li> <li>2. Check that the water supply valve at wall is fully open.</li> <li>3. Clean nozzles (see maintenance section).</li> <li>4. If you have an external bidet filter, check and replace if necessary.</li> <li>5. Adjust the water pressure settings on the remote to increase and adjust the wide spray settings on the remote.</li> </ol>
Nozzles do not function properly	<ol style="list-style-type: none"> <li>1. Nozzles are dirty</li> <li>2. Clogged filter</li> <li>3. Water pressure is too low</li> <li>4. External bidet filter</li> </ol>	<ol style="list-style-type: none"> <li>1. Clean nozzles (see maintenance section).</li> <li>2. Remove, clean, and reinstall mesh filter (see maintenance section).</li> <li>3. Check water supply valve at wall to fully open.</li> <li>4. If you have an external bidet filter, check and replace if necessary.</li> </ol>

Problem	Possible Cause(s)	Solution(s)
Seat is not heated	1. Seat temperature set to off	1. Make sure that the Seat temperature setting is on (Low- Blue light, Med- Pink light, High- Red light, Off- No light).
Bidet wash feature does not work or fails to spray	1. Body sensor does not detect that you are sitting on the Swash	1a. Adjust sitting position to fully cover the Body Sensor (see page 9).  1b. Override the body sensor – refer to Special Mode Operation section on page 27 to unlock the body Seat Sensor.
Water (wash spray) not heated	1. Water temperature set to off  2. Resettable fuse blown	1. Make sure that the Water temperature setting is on (Low- Blue light, Med- Pink light, High- Red light, Off- No light).  2. The bimetal resettable fuse may blow if the temperature exceeds over the normal level. The bidet will not work and show an error message until the bidet cools down. The fuse will automatically reset.
Water flows before or after use	1. Water coming from nozzles	1a. The water that comes out between the nozzles before or after a wash cycle is the self-clean cycle and is not a malfunction.  1b. Residual water may drip into the bowl for several seconds after a wash cycle, self-clean cycle, or nozzle sterilization cycle and is not a malfunction.
Water leaks from areas other than the nozzles	1. Water leaking from the T-valve  2. Water leaking from the bidet hose connection  3. Water leaking from under the seat  4. Water leaking from behind the seat	1. Make sure that the rubber gasket is inserted correctly into the T-valve (flat side down with lip pointing up towards the toilet tank connection) and firmly tighten the connector.  2. Make sure that the bidet hose is correctly connected and tight. Check any rubber washers and do not over tighten.  3. Check if there is anything between the mesh filter and bidet. Remove, clean, and reinstall mesh filter. Check if the filter is damaged (see maintenance section).  4. Check the water tank plug in the back of the seat (see maintenance section under product storage and use).

# WARRANTY

Brondell products are backed by some of the most comprehensive warranties in the industry. Brondell warrants that all products (excluding consumable items) shall be free from defects in material and workmanship under normal use and service.

## **S1200 Residential One-Year Limited Warranty**

- 100% Coverage of all parts and labor for the entire product (excluding consumable filters) for the first year from original date of purchase

## **S1400 Residential Three-Year Limited Warranty**

- 100% Coverage of all parts and labor for the entire product (excluding consumable filters) for the first year from original date of purchase
- 75% Coverage of all parts and labor for the entire product (excluding consumable filters) for the second year from original date of purchase
- 50% Coverage of all parts and labor for the entire product (excluding consumable filters) for the third year from original date of purchase

## **S1200/1400 Commercial Warranty**

Warranty period one year from original purchase date for all Brondell products. Warranties may not apply to products that are used for heavy commercial, hospital, or other high use non-residential applications.

### **Exclusions and Limitations**

1. BRONDELL warrants its products to be free from manufacturing defects under normal use and service. This warranty is extended only to the ORIGINAL PURCHASER.
2. BRONDELL's obligations under this warranty are limited to repairs or replacement, at BRONDELL's option, of products or parts found to be defective, provided that such products were properly installed and used in accordance with instructions. BRONDELL reserves the right to make such inspections as may be necessary in order to determine the cause of the defect. BRONDELL will not charge for labor or parts in connection with warranty repairs for the first three years from date of purchase on all products except those that may be subject to commercial use limitations.
3. BRONDELL is not responsible for the cost of removal, return (shipping) and/or re-installation of products.

This warranty does NOT apply to:

- Damage or loss which occurs during shipment.
  - Damage or loss sustained through any natural or man-made causes beyond the control of BRONDELL, including but not limited to fire, earthquake, floods, etc.
  - Damage or loss resulting from sediments or foreign matter contained in a water system.
  - Damage or loss resulting from negligent or improper installation including installation of a unit in a harsh or hazardous environment.
  - Damage or loss resulting from removal, improper repair, modification of the product, or improper maintenance including damage caused by chlorine or chlorine related products
  - Damage or loss resulting from electrical surges, electrical outages, lightning strikes, or other acts which are not the fault of Brondell or which the Product is not specified to tolerate.
4. This warranty gives you specific legal rights. You may have other rights which vary from state to state.

THIS WRITTEN WARRANTY IS THE ONLY WARRANTY MADE BY BRONDELL. REPAIR OR REPLACEMENT AS PROVIDED UNDER THIS WARRANTY SHALL BE THE EXCLUSIVE REMEDY AVAILABLE TO THE PURCHASER. BRONDELL SHALL NOT BE RESPONSIBLE FOR LOSS OF USE OF THE PRODUCT OR FOR OTHER INCIDENTAL, SPECIAL, FOR CONSEQUENTIAL DAMAGES OR EXPENSES INCURRED BY THE PURCHASER OR FOR LABOR OR OTHER COSTS DUE TO INSTALLATION OR REMOVAL OR COSTS OF REPAIRS BY OTHERS, OR FOR ANY OTHER EXPENSE NOT SPECIFICALLY STATED ABOVE. EXCEPT TO THE EXTENT PROHIBITED BY APPLICABLE LAW, ANY IMPLIED WARRANTIES, INCLUDING THAT OF MERCHANTABILITY, ARE EXPRESSLY LIMITED TO THE DURATION OF THIS WARRANTY. SOME STATES DO NOT ALLOW LIMITATIONS, SO THE ABOVE LIMITATION AND EXCLUSION MAY NOT APPLY TO YOU.

### **How to Obtain Service**

To obtain repair service under this warranty, you must contact an authorized BRONDELL Service Center to obtain an RMA (Return Merchandise Authorization) number. Proof of purchase in the form of a copy of the original receipt must accompany the returned unit for the warranty to be valid. Take or ship the unit pre-paid to the closest Brondell authorized service center along with the RMA number and proof of purchase.

To obtain the RMA number and locate the BRONDELL Service Center location nearest you, please call 1-888-542-3355, Mon–Fri, 9am–5pm PST.



a healthy home experience

**CONTACT:**

Brondell, Inc.

PO Box 470085

San Francisco, CA 94147-0085

Phone: 1-888-542-3355

Email: [support@brondell.com](mailto:support@brondell.com)

Web: [www.brondell.com](http://www.brondell.com)

For questions, contact Brondell Customer Service:

1-888-542-3355, Monday – Friday, 9am – 5pm PST

**MANUFACTURED BY:**

Brondell, Inc.

PO Box 470085

San Francisco, CA 94147-0085

**Made in Korea**

**Please retain receipt records for any warranty claims.**