

CSP12X + CSP01X

Instruction Manual

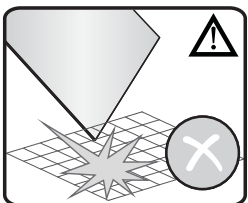
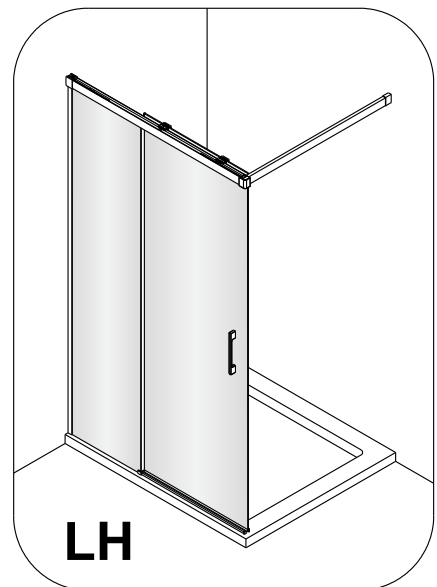
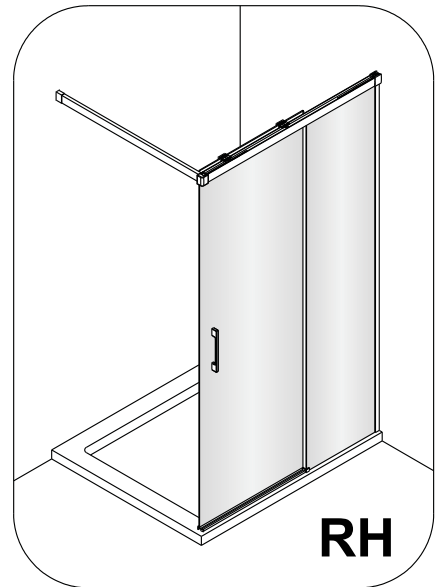
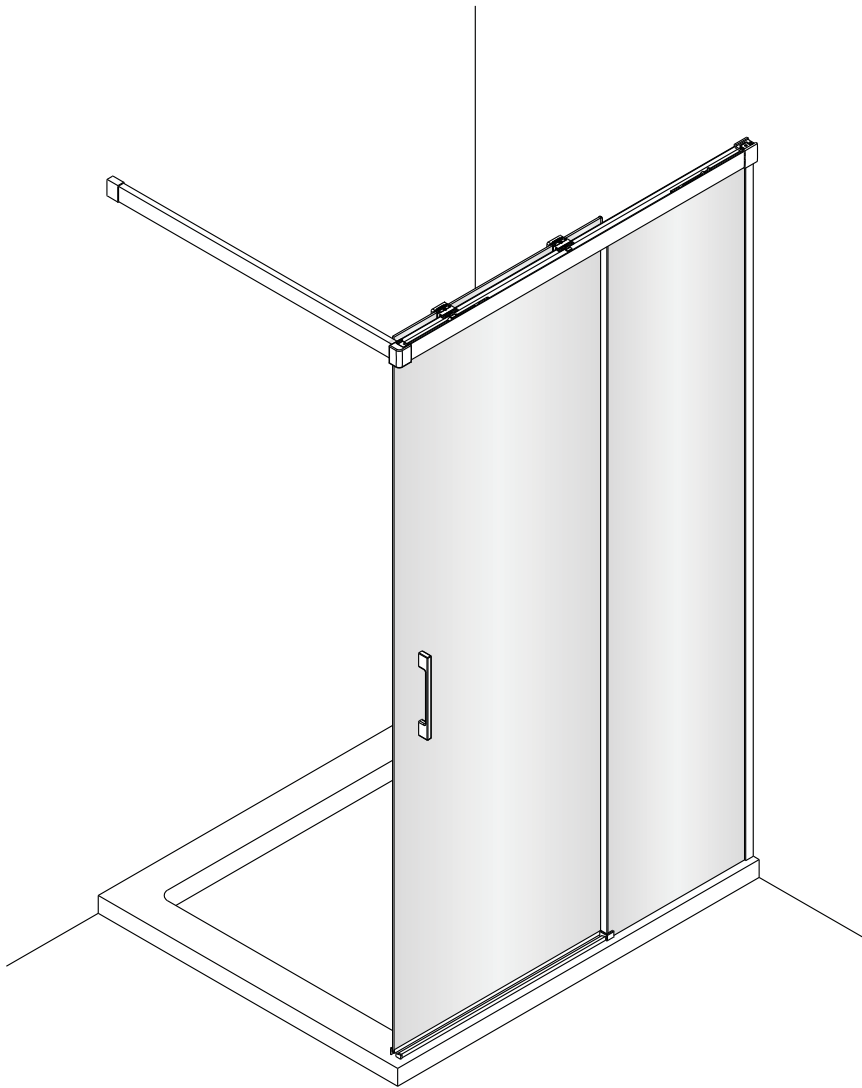

CAUTION! Tempered glass, handle with care!

No collision to the four corners in case of crazing.

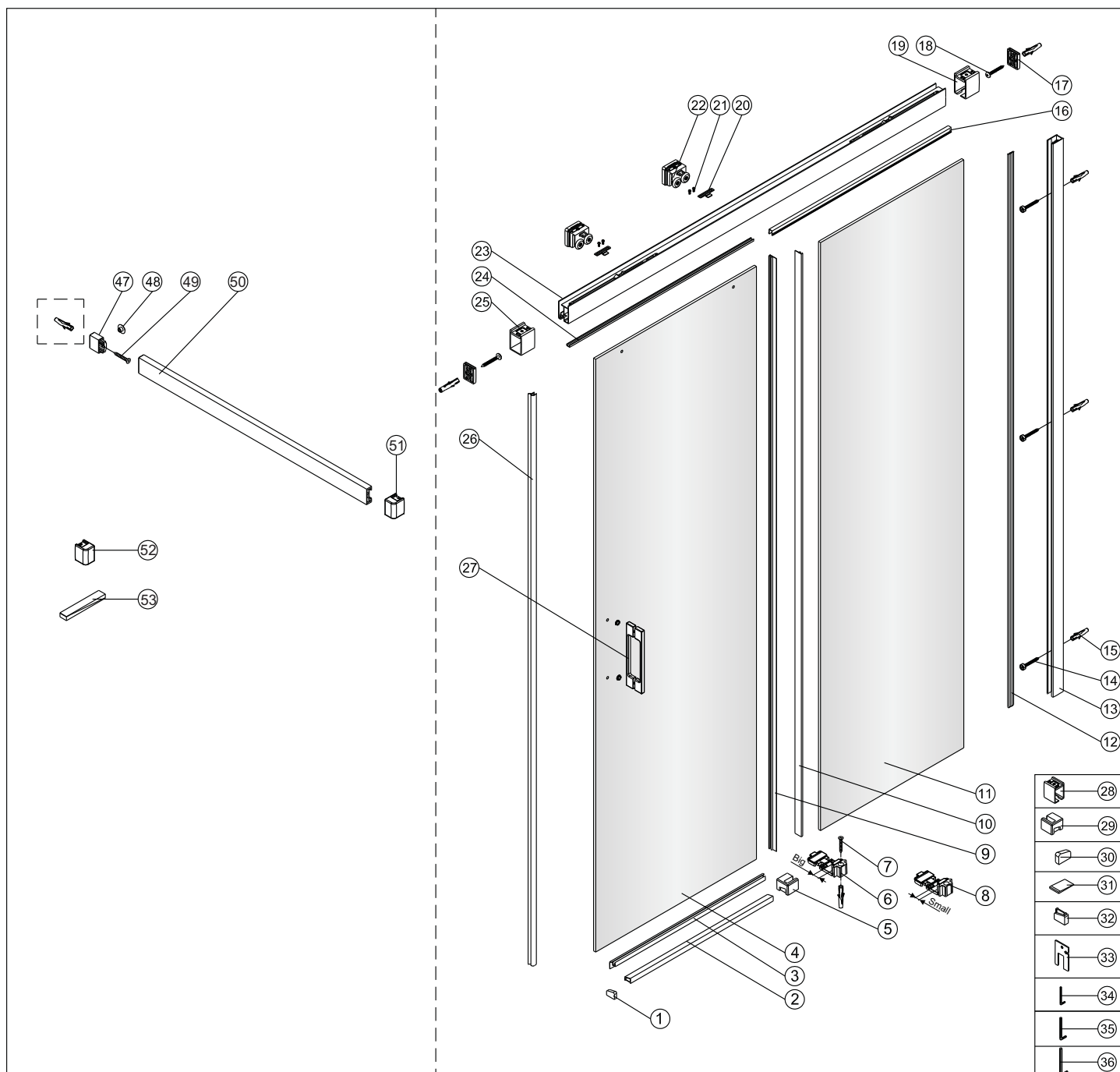

47 x1	48 x1	49 x1 ST4x40	50 x1	51 x1	52 x1	53 x1
--------------	--------------	---------------------	--------------	--------------	--------------	--------------

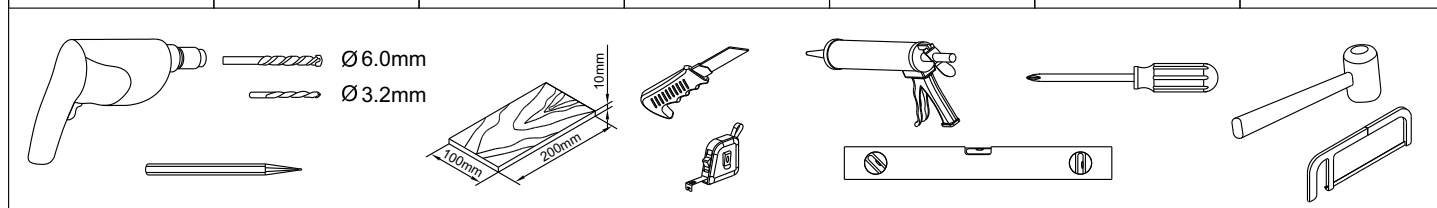

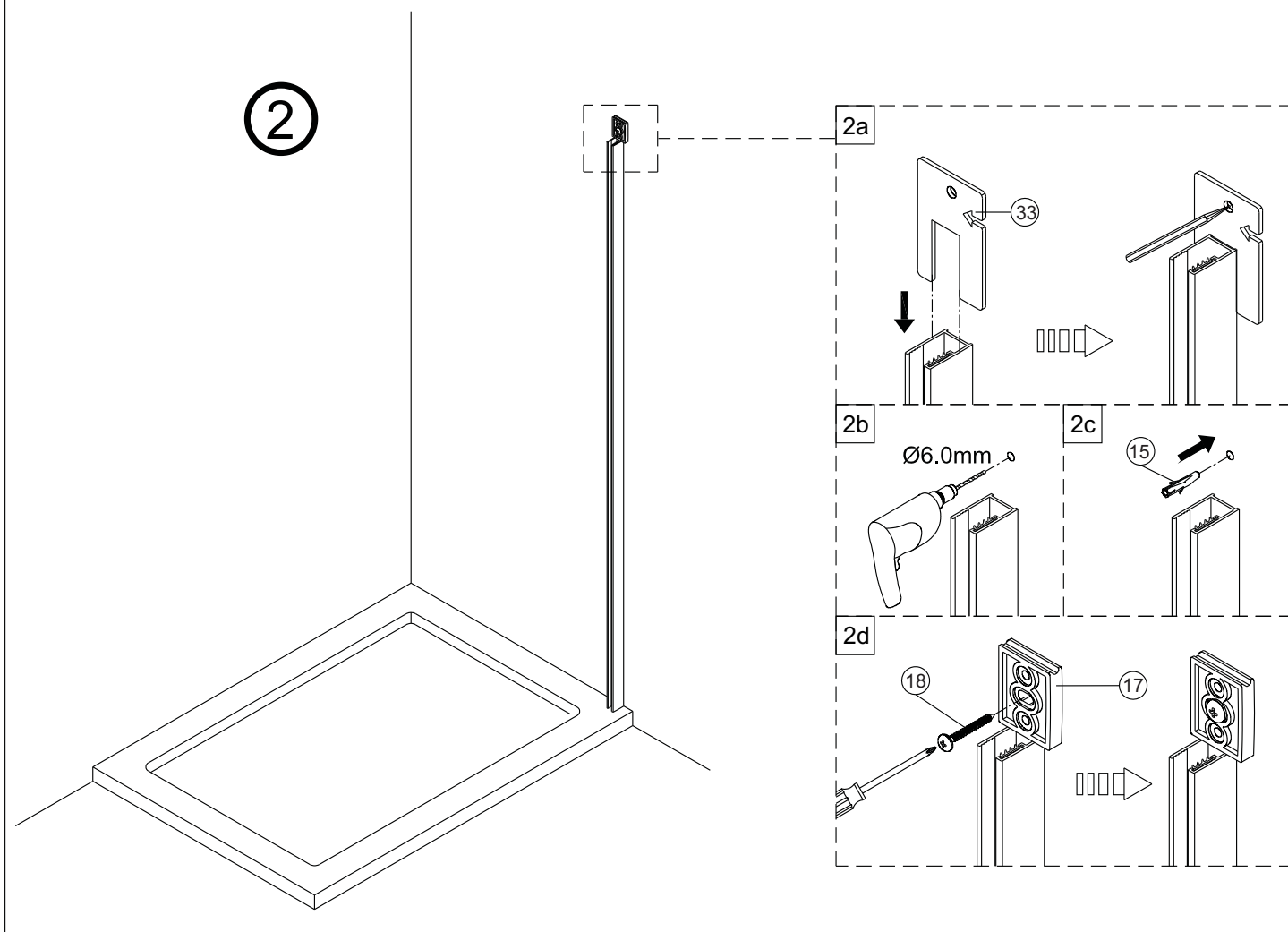
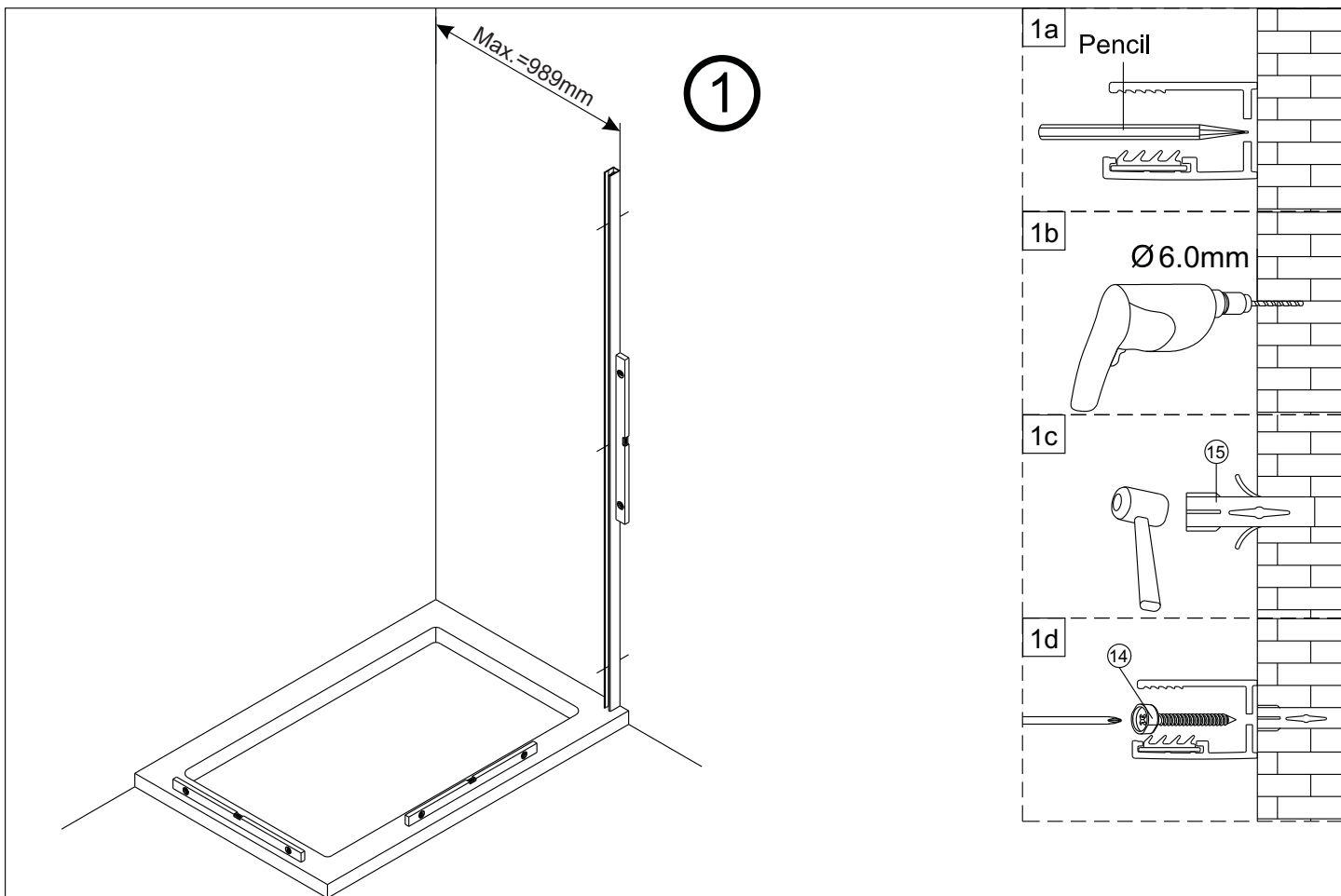



This side with easy clean treatment, please put this side to inside of shower enclosure.

③

The setting wedge(No.31)
will be needed if the door
is not level in 2-7mm.

Put silicone on the two
wedges and place them
under the door to level
the door.

Cut the redundant part
along the rim of glass.

3a

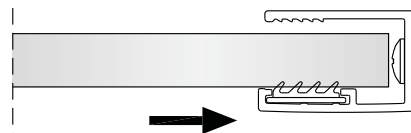

3b

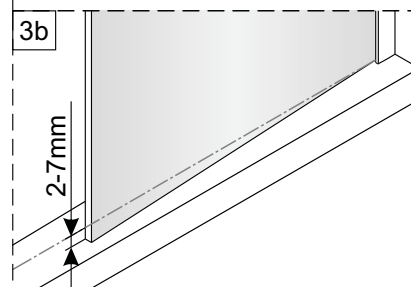

3c

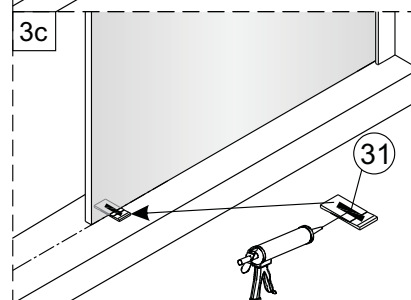

3d

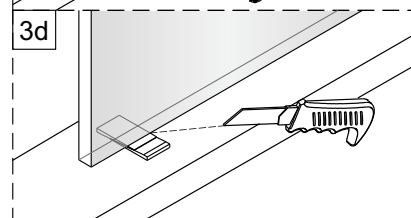

④

4a

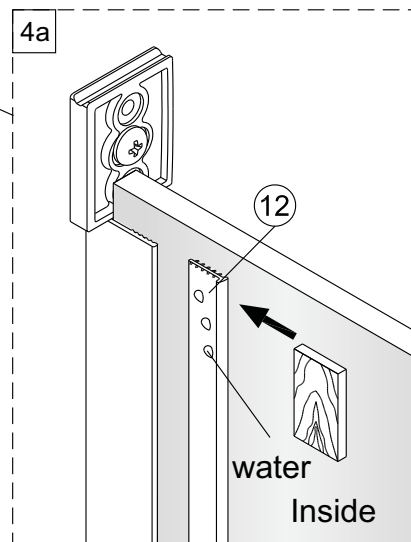

4b

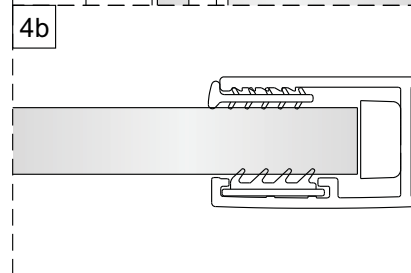

5

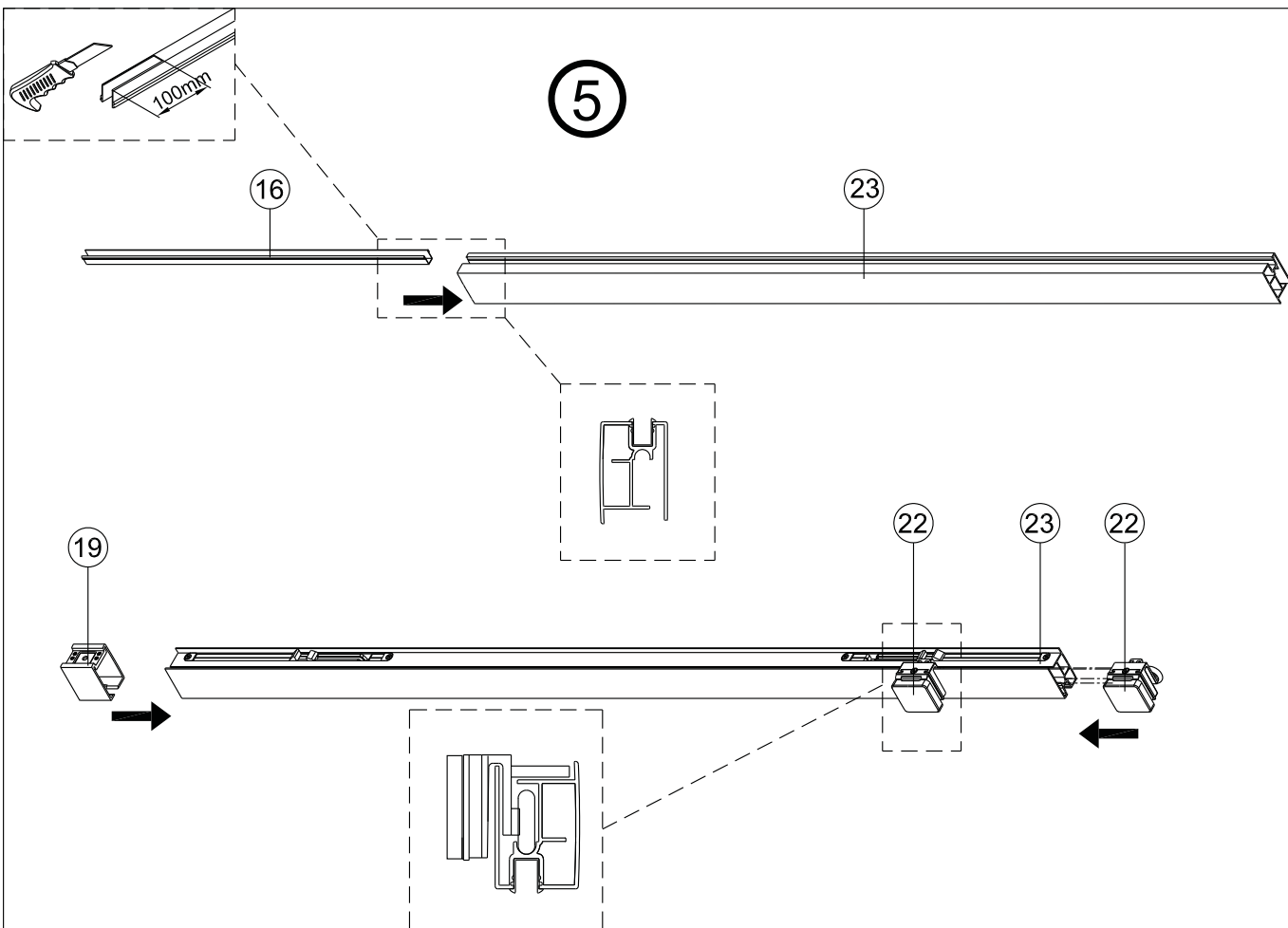

6

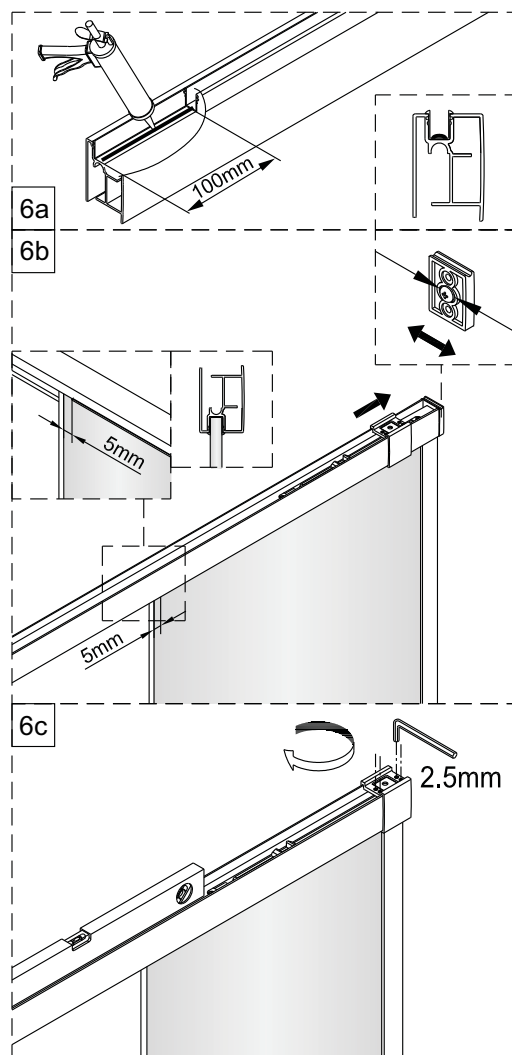
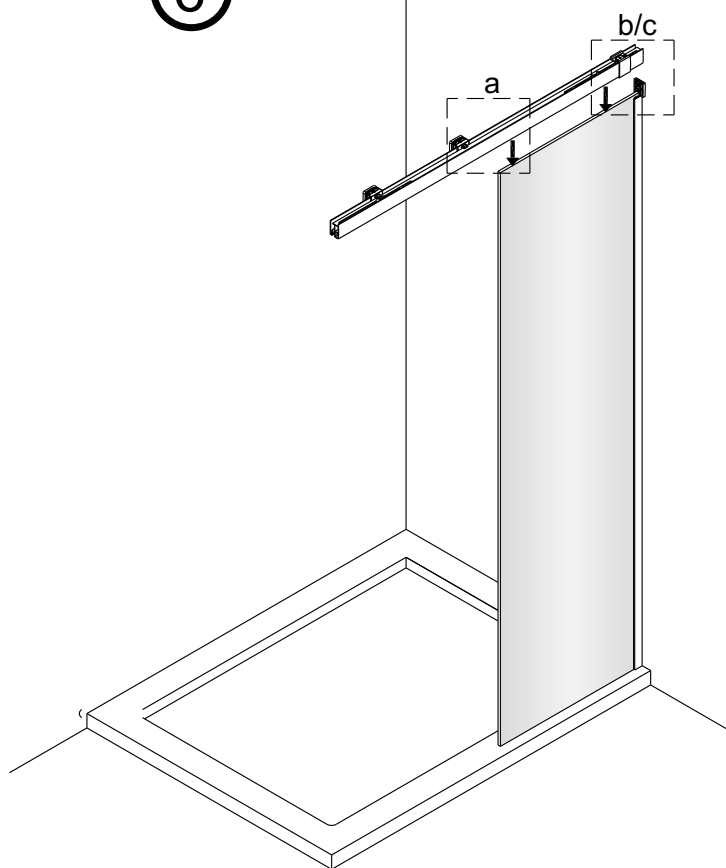

7

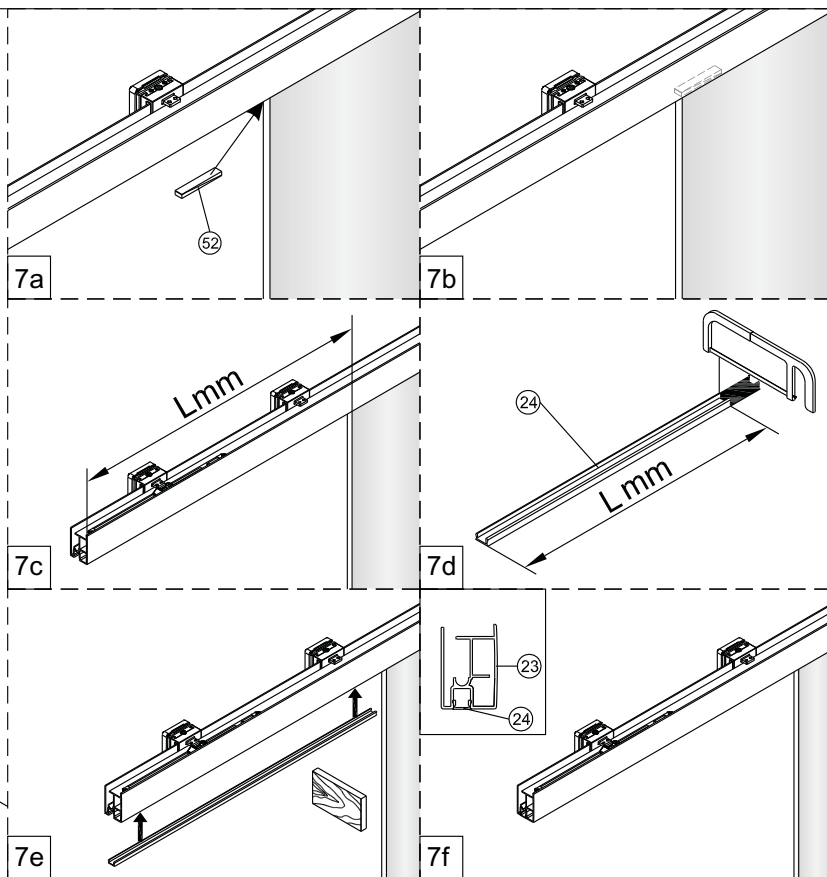
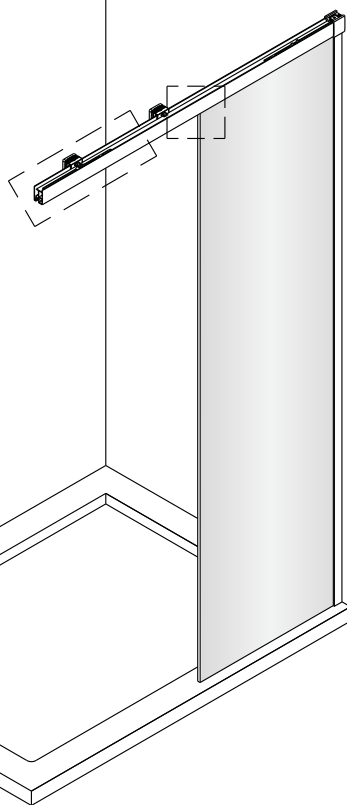

8

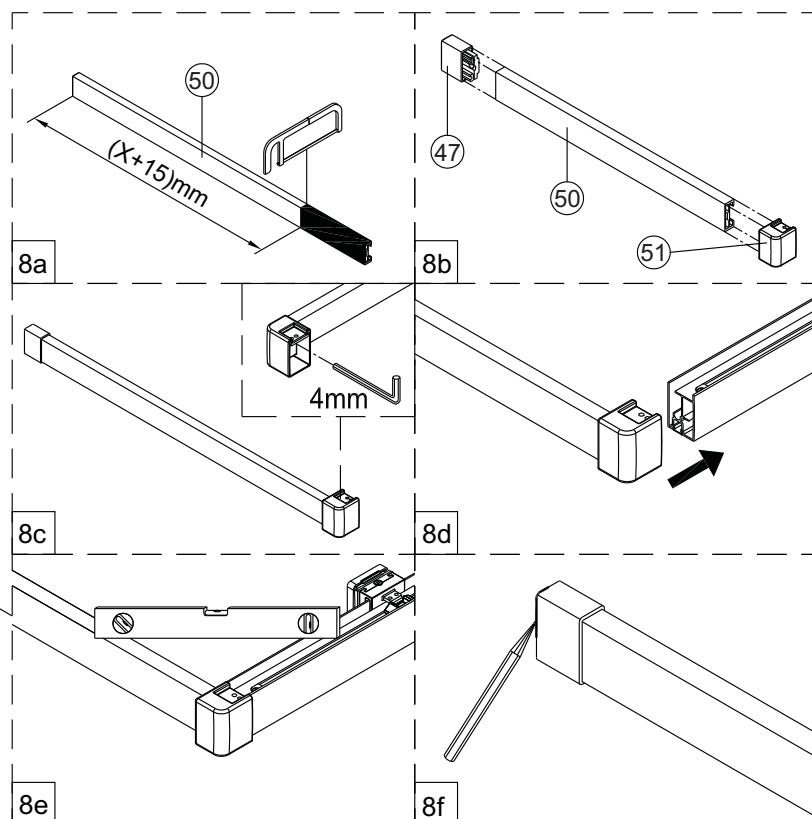
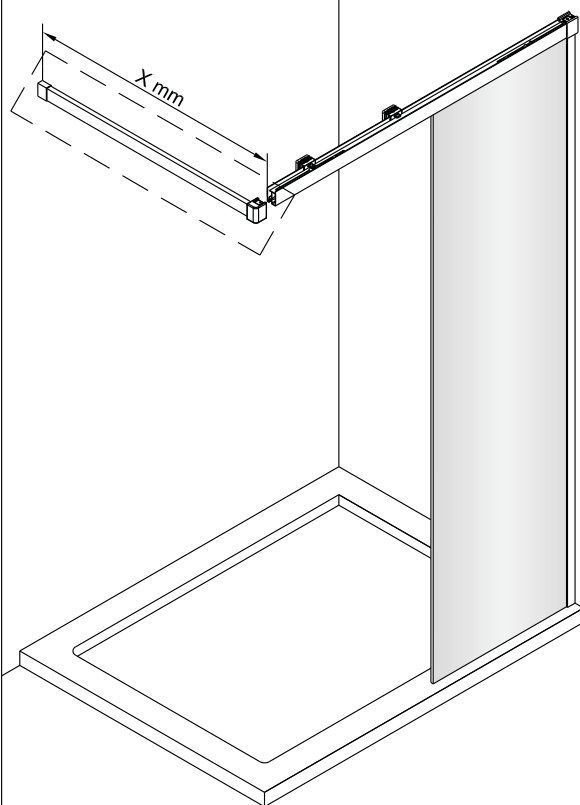

9

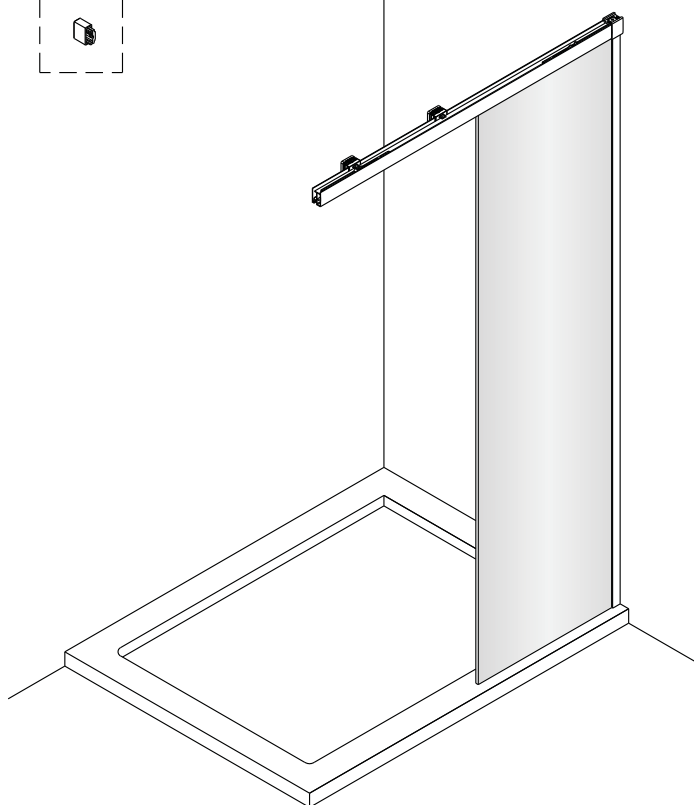

Pencil

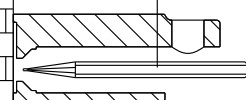

9a

Ø6 mm

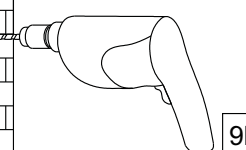

9b

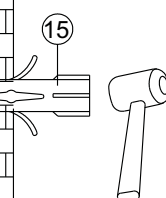

9c

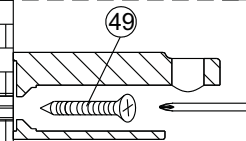

9d

10

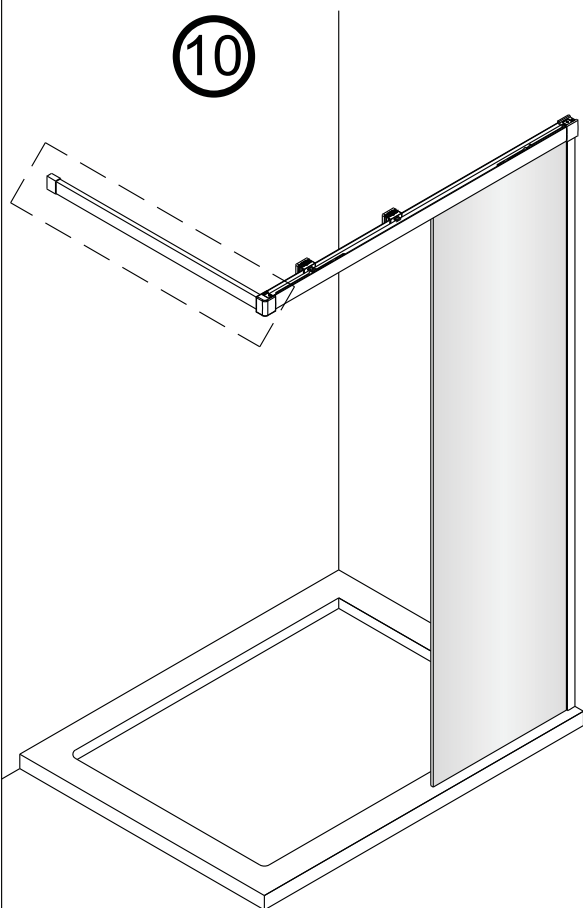

10a

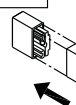

10b

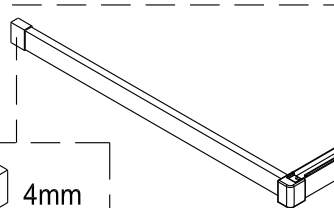

10c

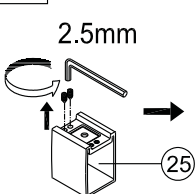

10d

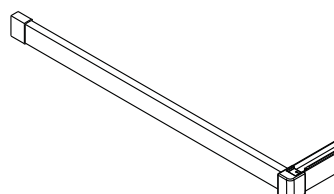

4mm

48

2.5mm

25

11

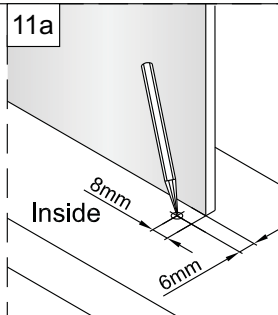

11b

Choice 1:
on the tray

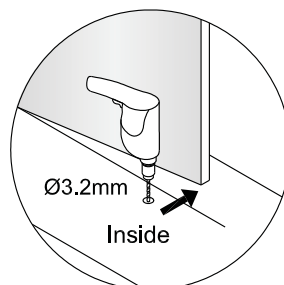

11b

Choice 2:
on the floor

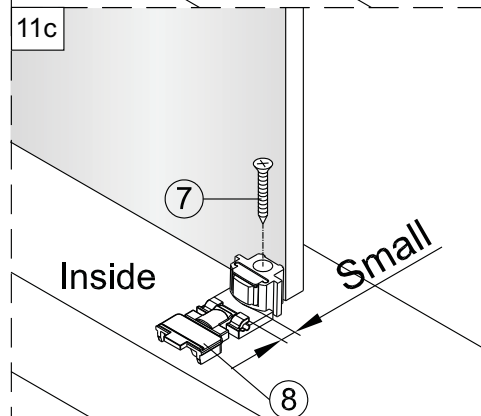
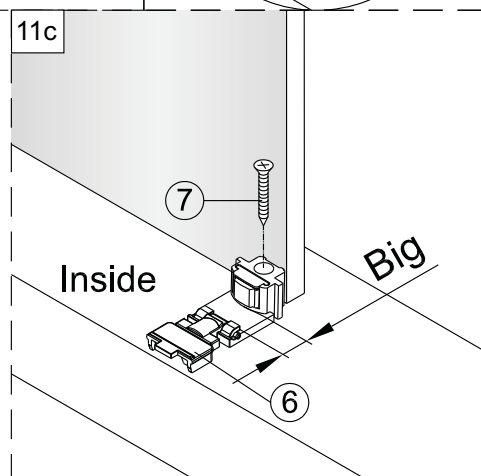
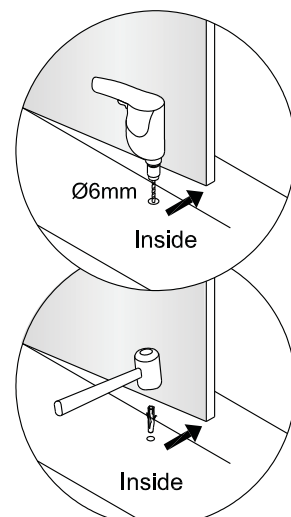

Step a: Insert the
"Big" protector
into the door guide
when the moving
glass use bottom
waterproof strip.

Step b: Insert the
"Small" protector
into the door guide
when the moving
glass does not
use any bottom
waterproof strip.

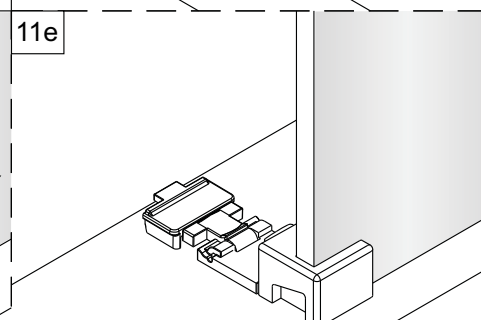
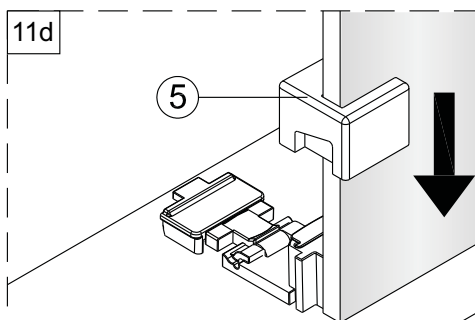

12

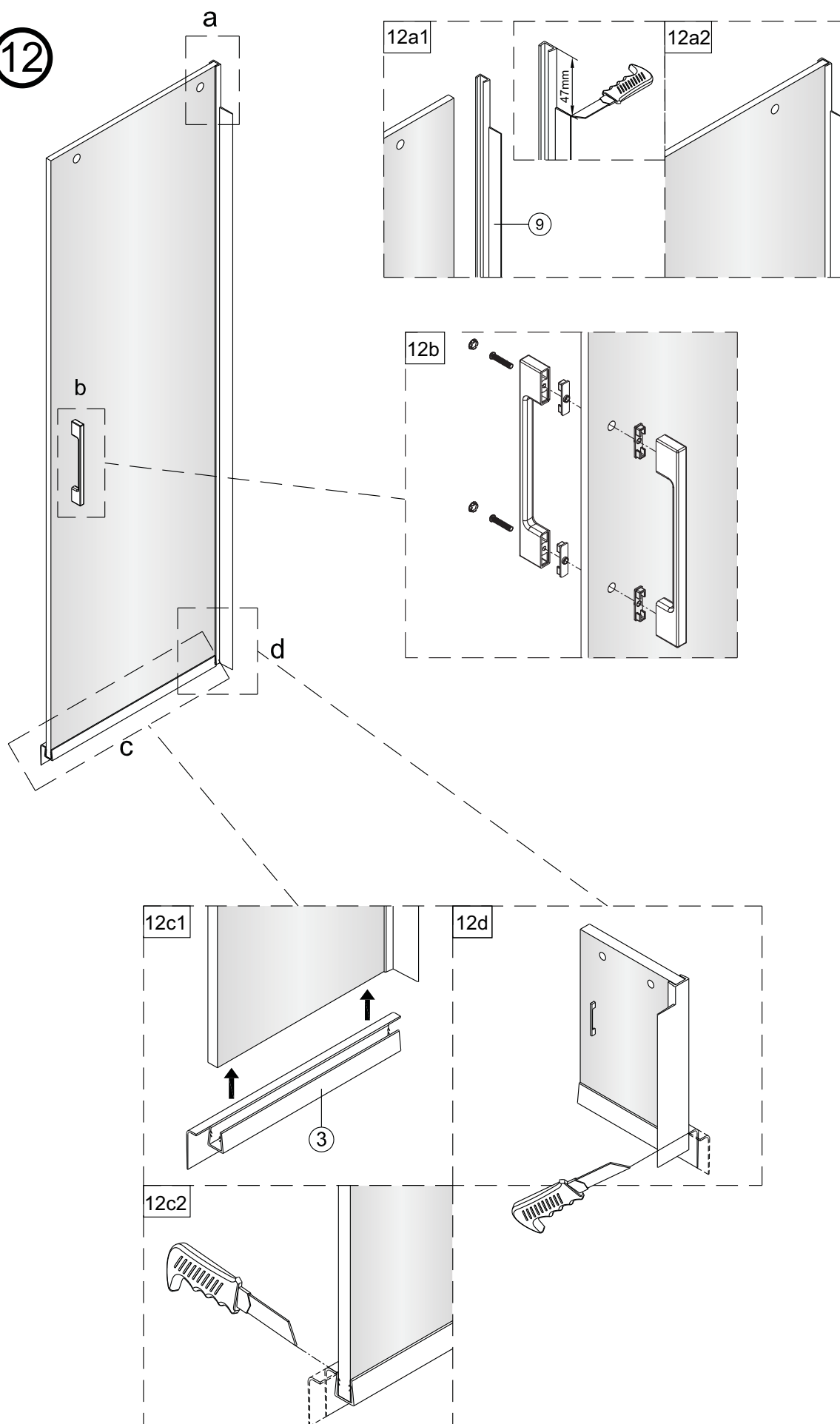

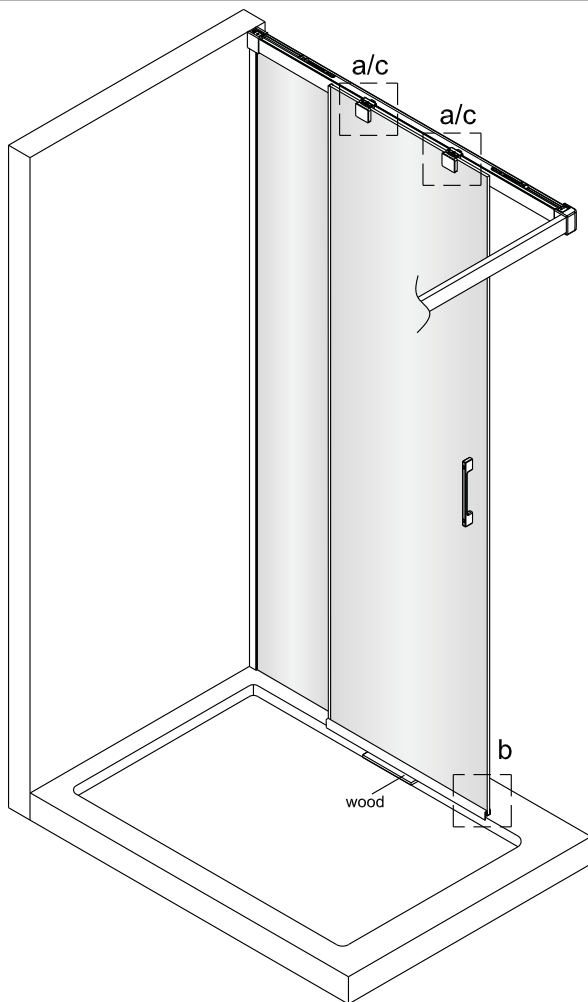

13

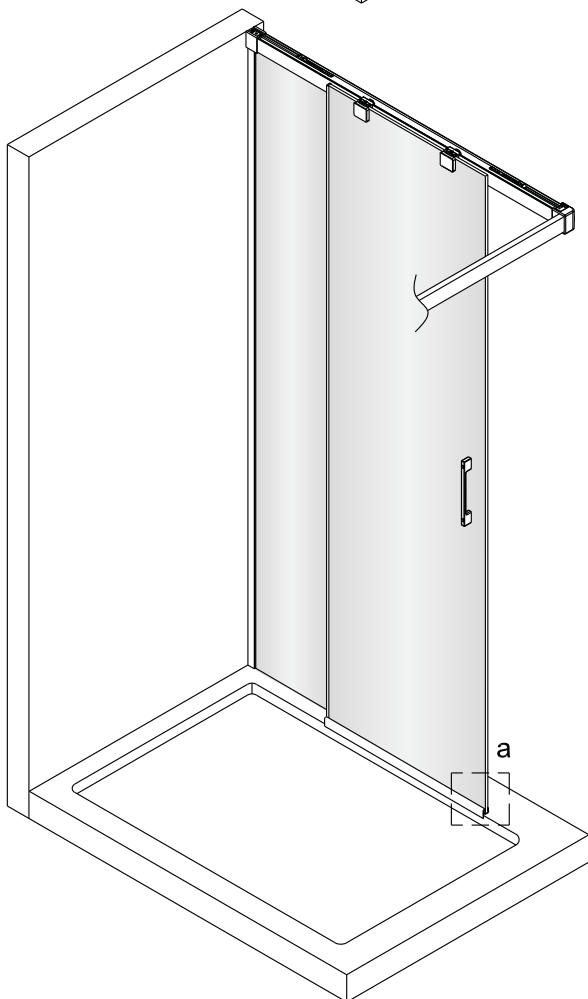
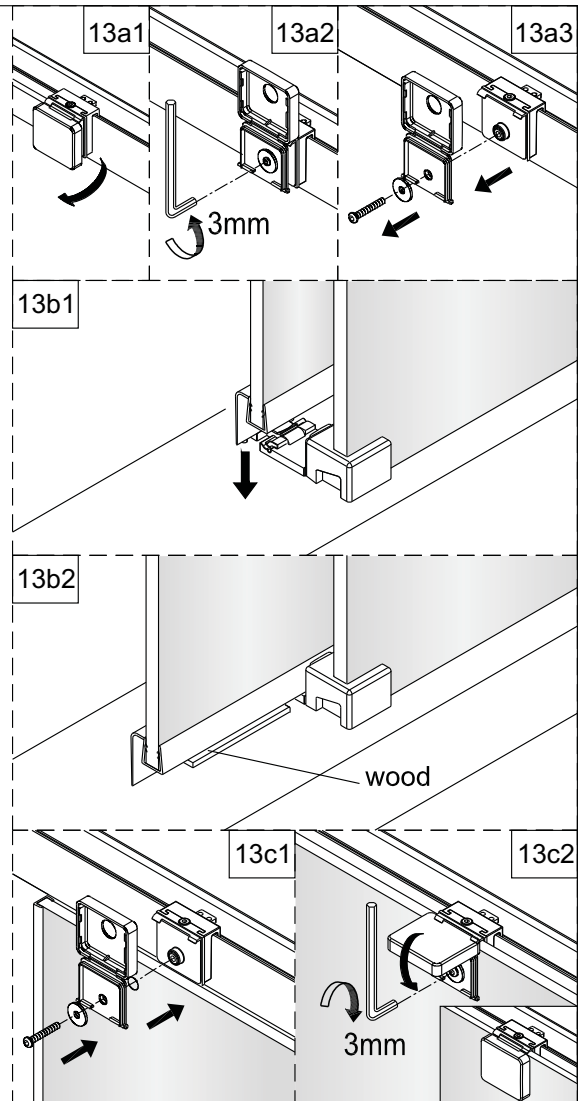

14

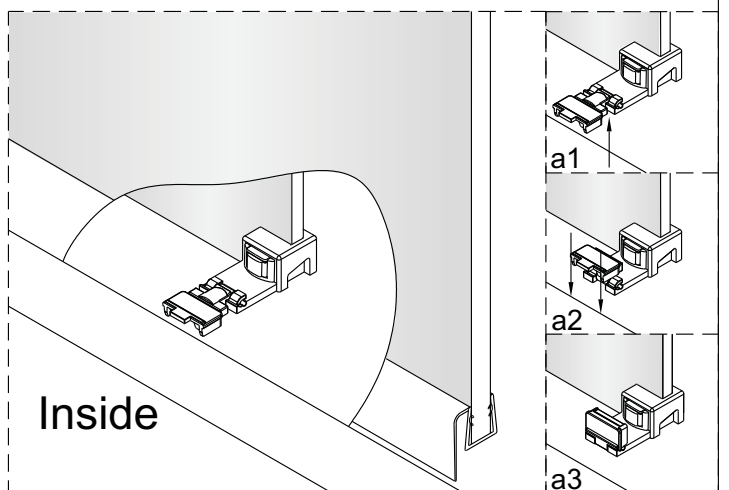

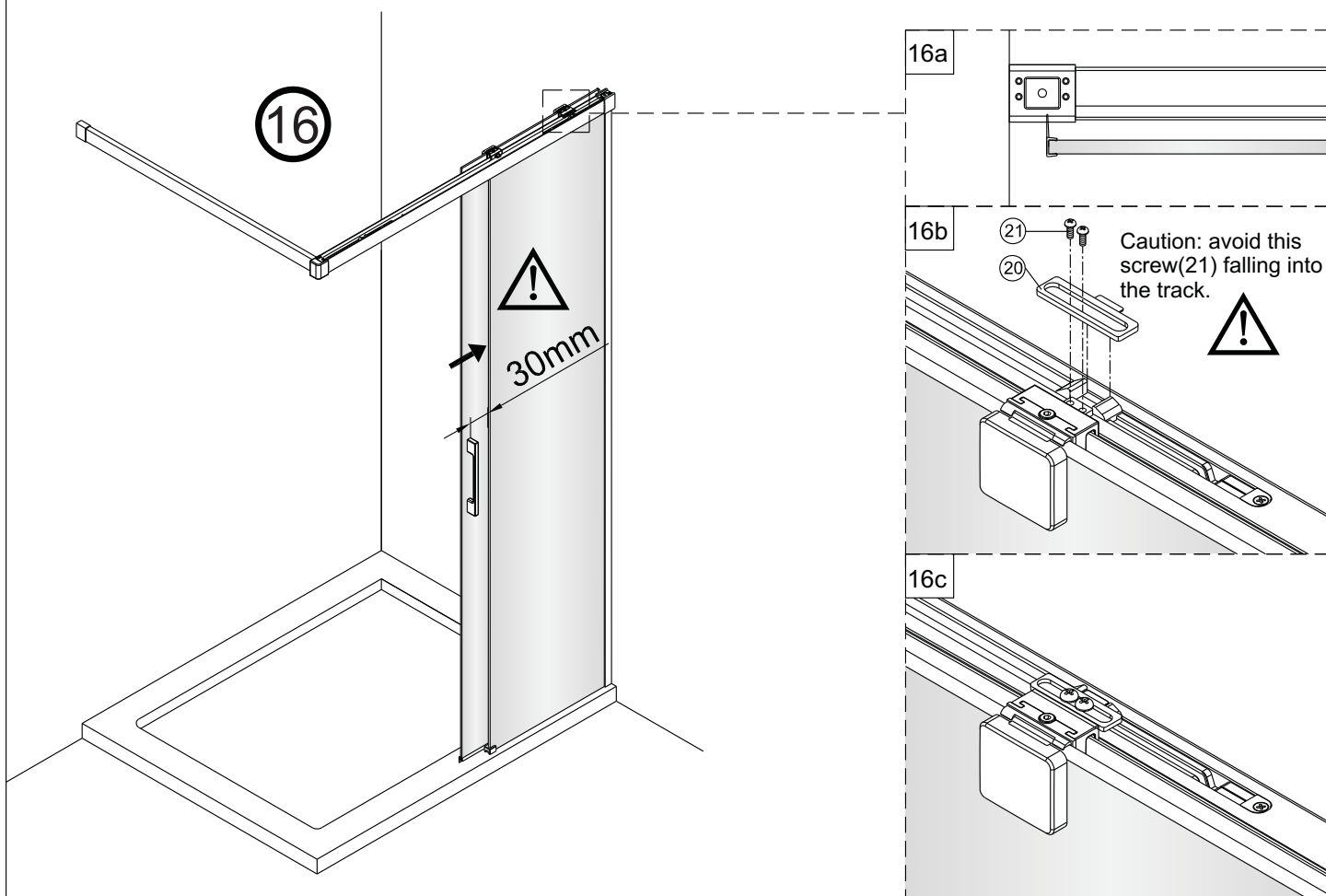
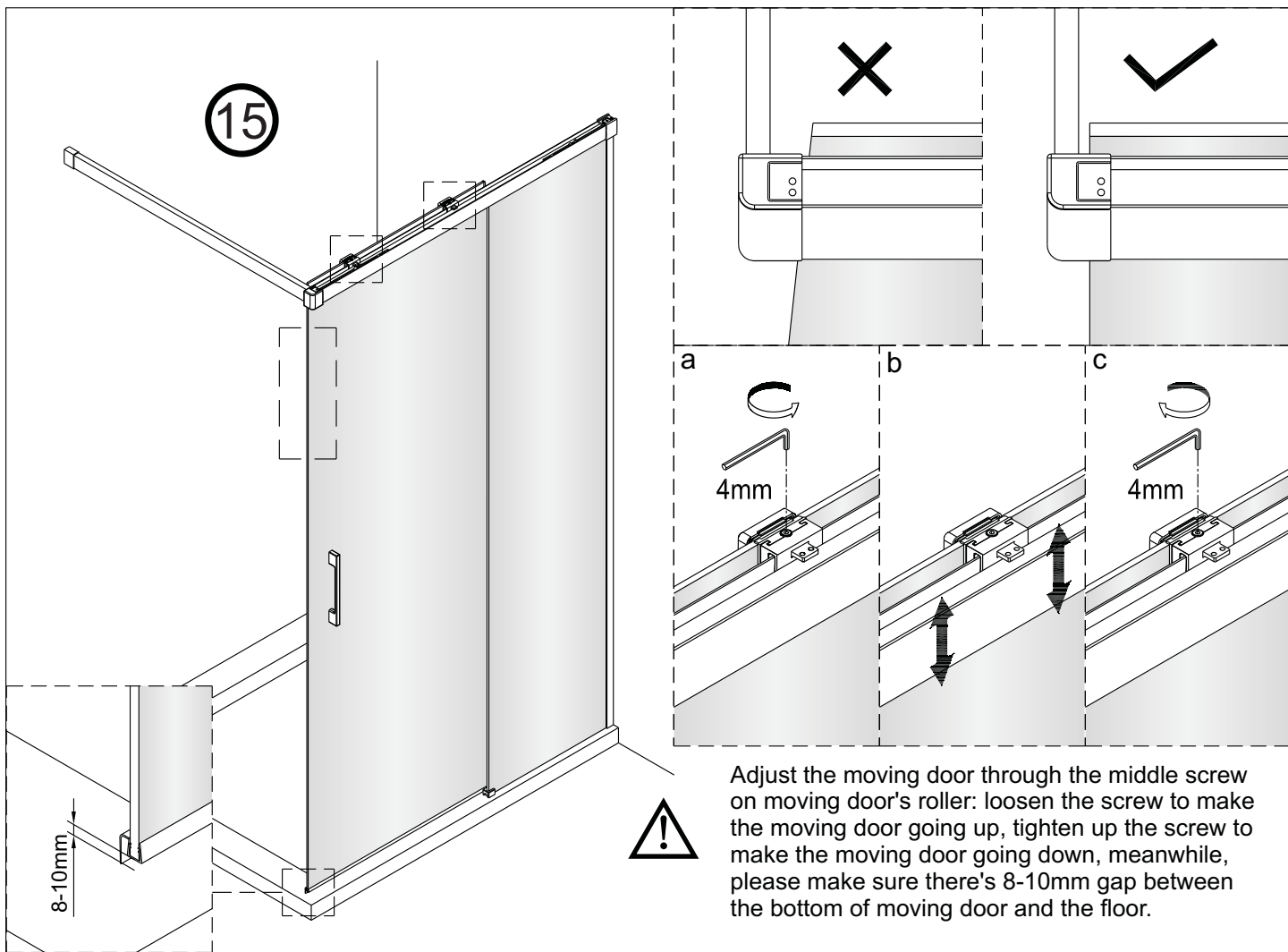

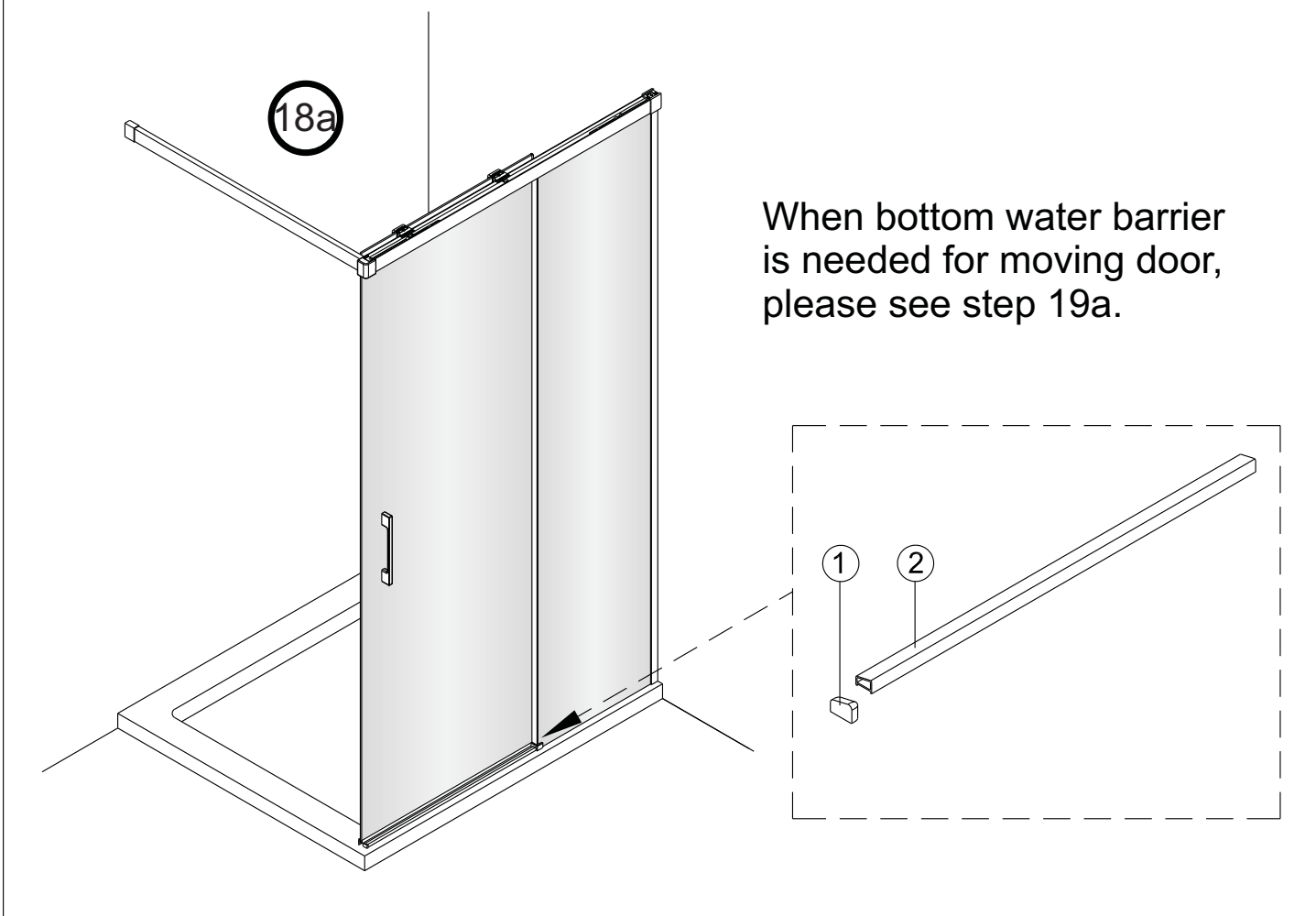
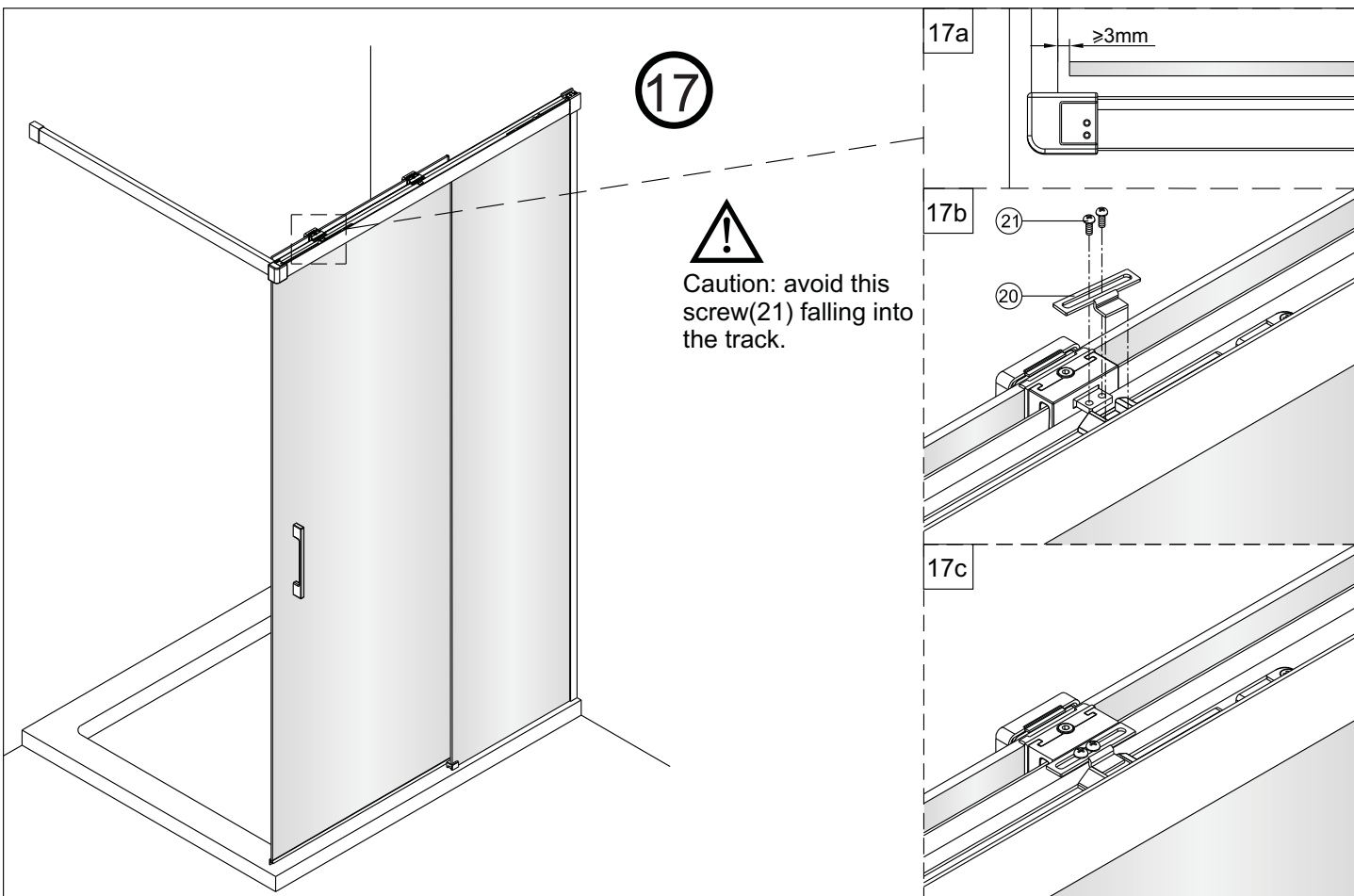

18b

When bottom water barrier is not needed for moving door, please see step 19b.

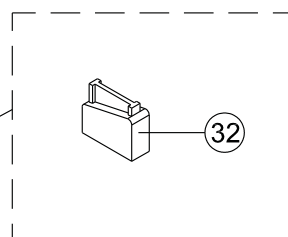

19a

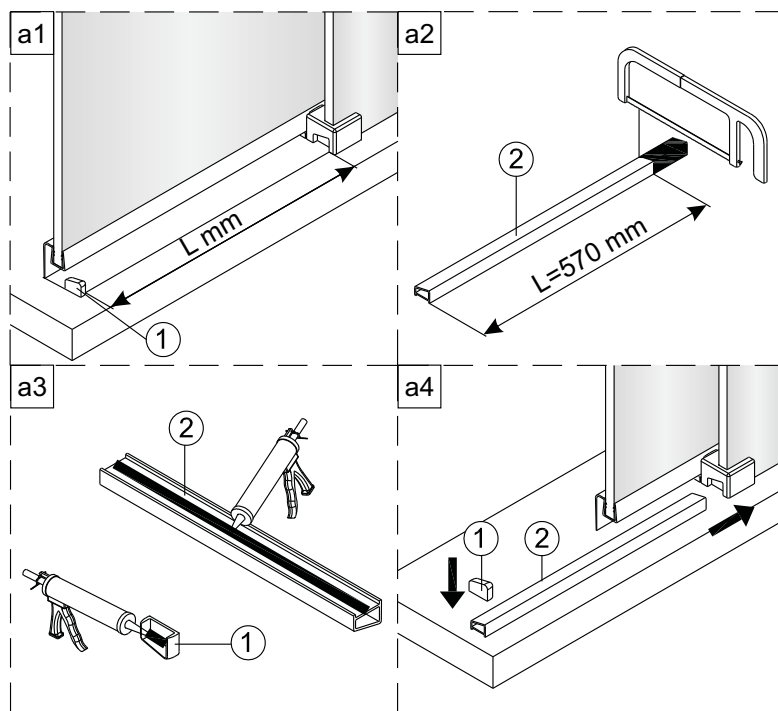

Note: the bottom waterproof strip here must parallel to the rim of shower tray.

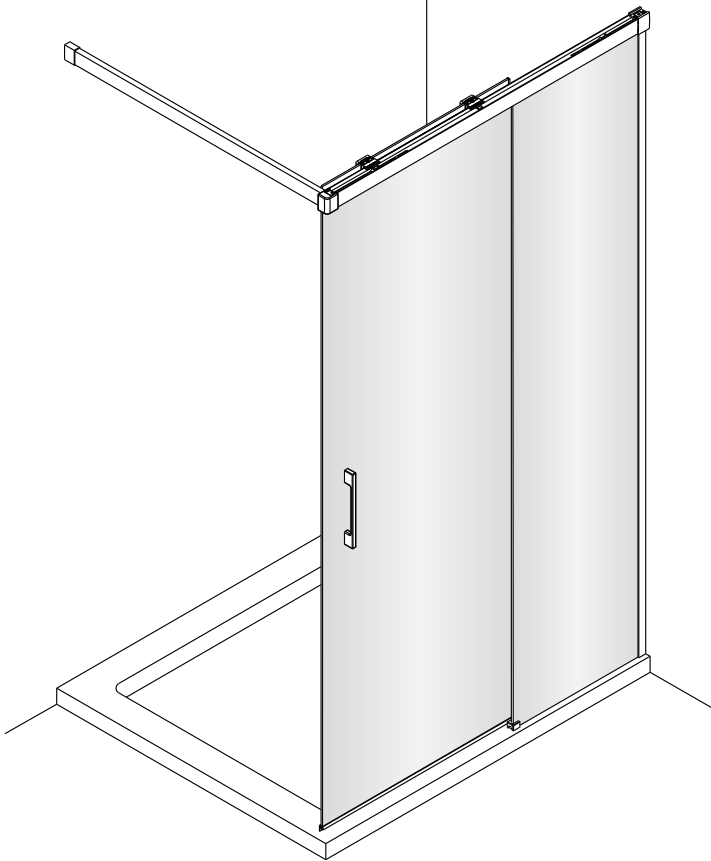

19b

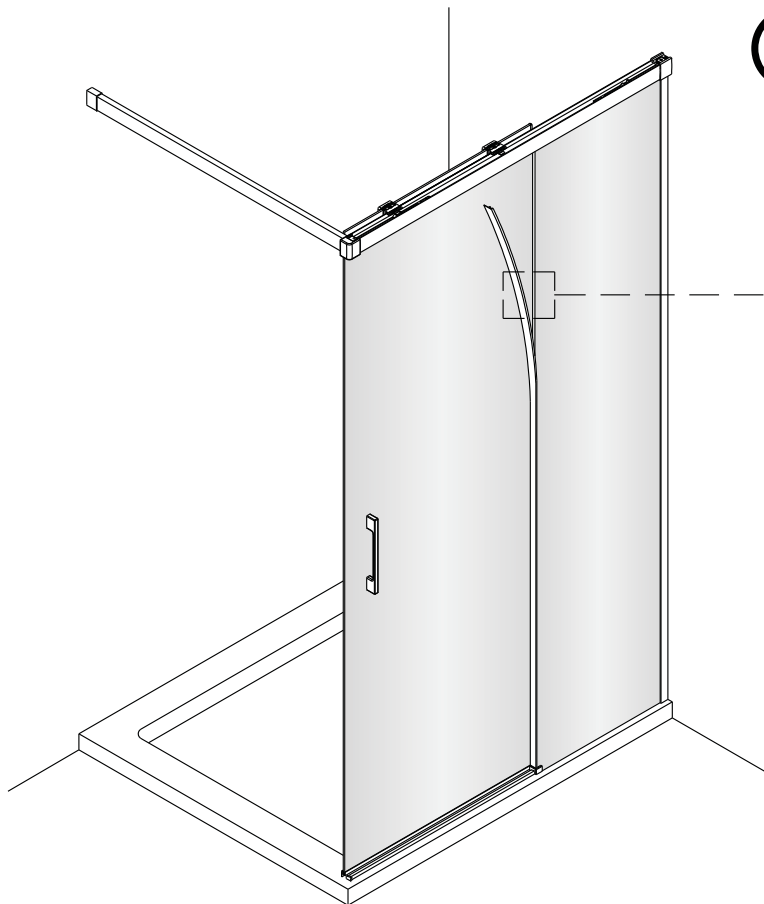
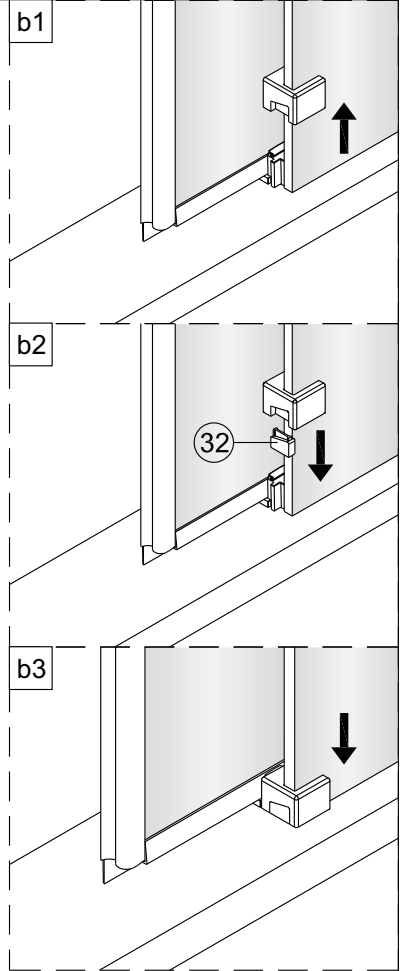

20

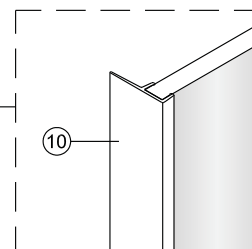

21

